

| F.A.P. RTE. | SECTION | COUNTY | TOTAL SHEETS | SHEET NO. |
|-----------------------|-----------------|---------------|------------------|-----------|
| 305 | (1616&1719)RS-2 | COOK | 27 | 10 |
| STA. _____ | | TO STA. _____ | | |
| FED. ROAD DIST. NO. 1 | | ILLINOIS | FED. AID PROJECT | |

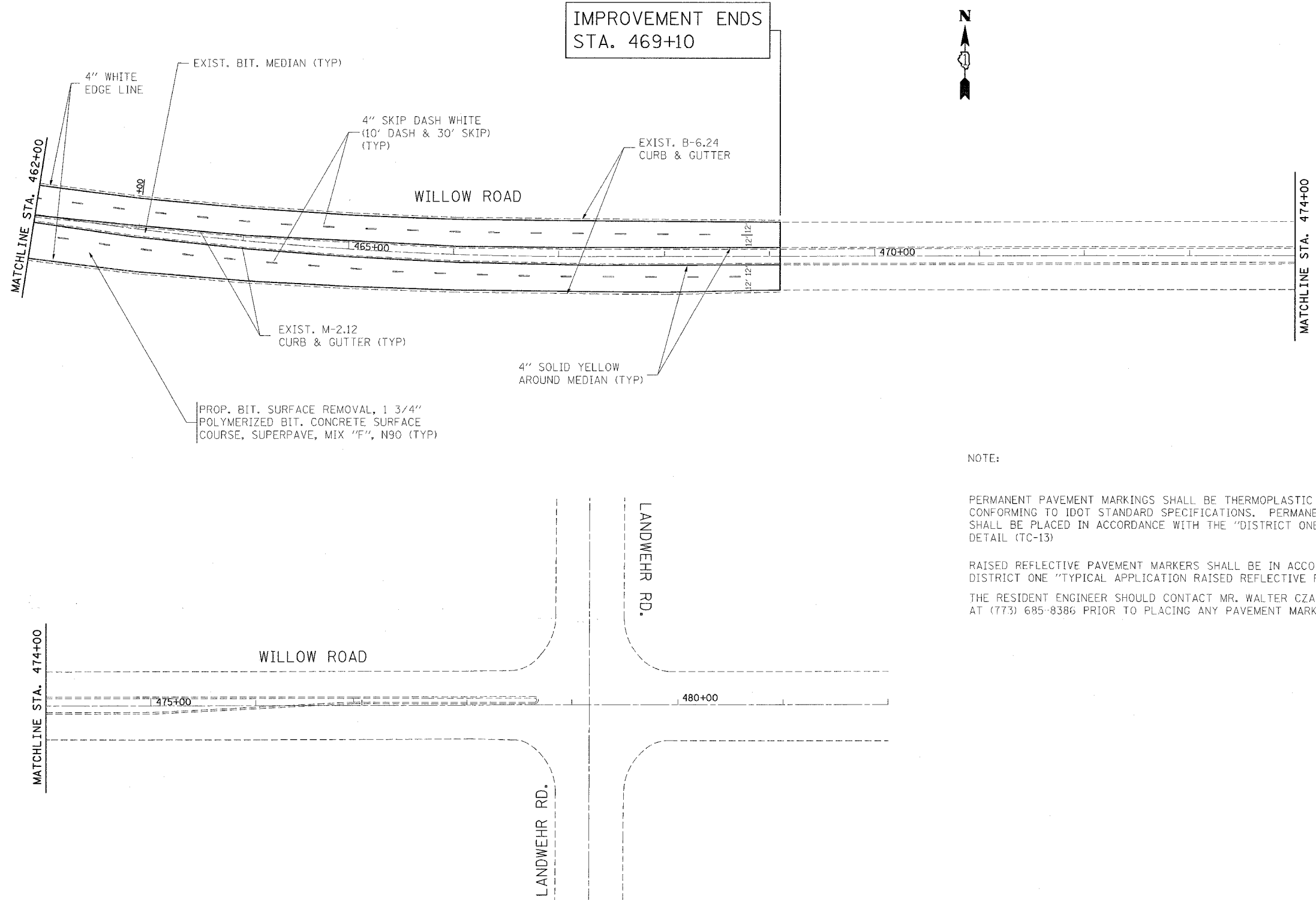

IMPROVEMENT ENDS
STA. 469+10



NOTE:

PERMANENT PAVEMENT MARKINGS SHALL BE THERMOPLASTIC (OF THE EXTRUDED TYPE) CONFORMING TO IDOT STANDARD SPECIFICATIONS. PERMANENT PAVEMENT MARKINGS SHALL BE PLACED IN ACCORDANCE WITH THE "DISTRICT ONE TYPICAL PAVEMENT MARKINGS" DETAIL (TC-13)

RAISED REFLECTIVE PAVEMENT MARKERS SHALL BE IN ACCORDANCE WITH THE DISTRICT ONE "TYPICAL APPLICATION RAISED REFLECTIVE PAVEMENT MARKERS DETAIL" THE RESIDENT ENGINEER SHOULD CONTACT MR. WALTER CZARNY, AREA TRAFFIC ENGINEER AT (773) 685-8386 PRIOR TO PLACING ANY PAVEMENT MARKINGS.

| REVISIONS | |
|-----------|------|
| NAME | DATE |
| | |
| | |
| | |
| | |
| | |
| | |
| | |
| | |
| | |
| | |

ILLINOIS DEPARTMENT OF TRANSPORTATION

ROADWAY AND PAVEMENT MARKING PLANS

SCALE: VERT. 1"=50'
HORIZ. DATE

DRAWN BY
CHECKED BY