

F.A. RTE.	SECTION	COUNTY	TOTAL SHEETS	SHEET NO.
39	(50-4)I	LASALLE	33	12
STA.		TO STA.		
FED. ROAD DIST. NO.		ILLINOIS FED. AID PROJECT		

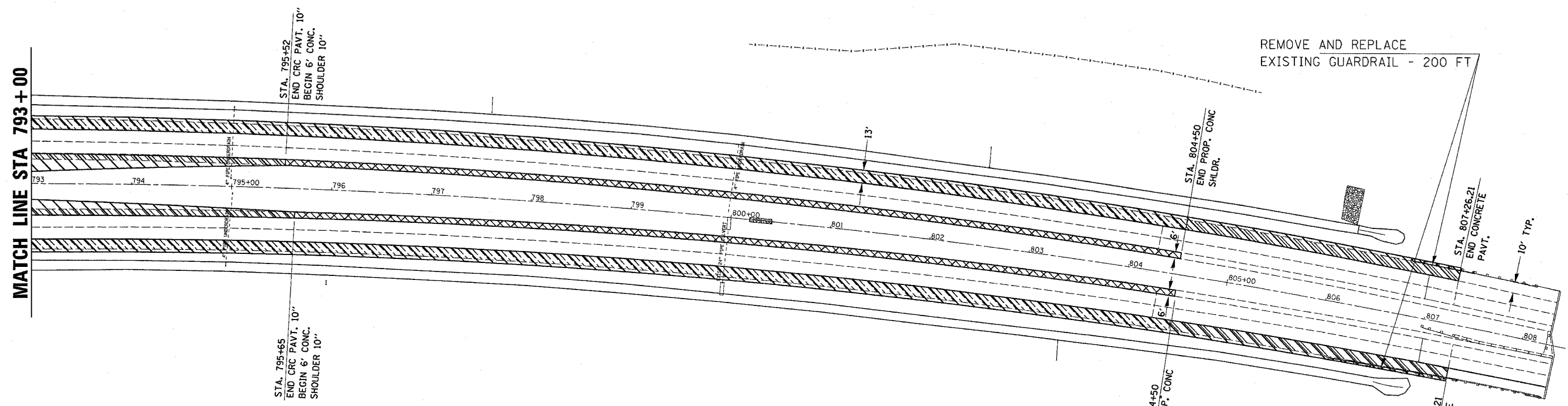

MATCH LINE STA 793 + 00



REMOVE AND REPLACE EXISTING GUARDRAIL - 200 FT

- PCC SHOULDER REMOVAL
- BITUMINOUS SHOULDER REMOVAL
- PROPOSED 10" CONCRETE SHOULDER
- CONTINUOUSLY REINFORCED PCC PVMT 10" PCC PVMT 10" (JOINTED)

EXIST. CURVE 39CLS-1  
 PI STA. = 806+74.99  
 $\Delta = 21^\circ 02' 26''$  (RT)  
 $D = 0^\circ 44' 58''$   
 $R = 7,644.15'$   
 $T = 1,419.56'$   
 $L = 2,807.14'$   
 $E = 130.69'$   
 $e =$   
 $T.R. =$   
 $S.E. RUN =$   
 $P.C. STA. = 792+55.43$   
 $P.T. STA. = 820+62.57$

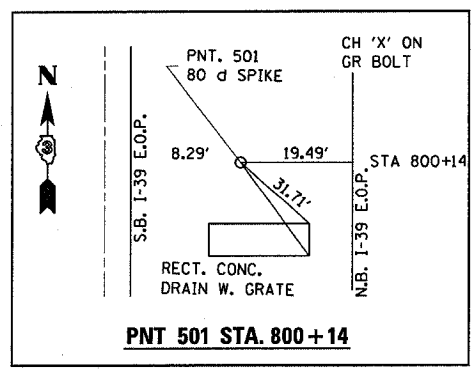

PNT 501 STA. 800+14

PLOT DATE : 4/22/2005  
 FILE NAME : #FILEL#  
 PLOT SCALE : #SCALE#  
 REFERENCE : #REF#

**REVISED**  
7-27-2005

REVISIONS	
NAME	DATE

ILLINOIS DEPARTMENT OF TRANSPORTATION

## CROSSOVER PLAN SOUTH

SCALE: VERT. \_\_\_\_\_  
 HORIZ. \_\_\_\_\_  
 DATE \_\_\_\_\_

DRAWN BY \_\_\_\_\_  
 CHECKED BY \_\_\_\_\_