

F.A. RTE.	SECTION	COUNTY	TOTAL SHEETS	SHEET NO.
39	(50-4)	LASALLE	33	11
STA.		TO STA.		
FED. ROAD DIST. NO.		ILLINOIS	FED. AID PROJECT	

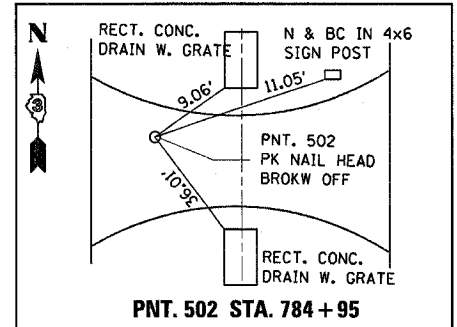
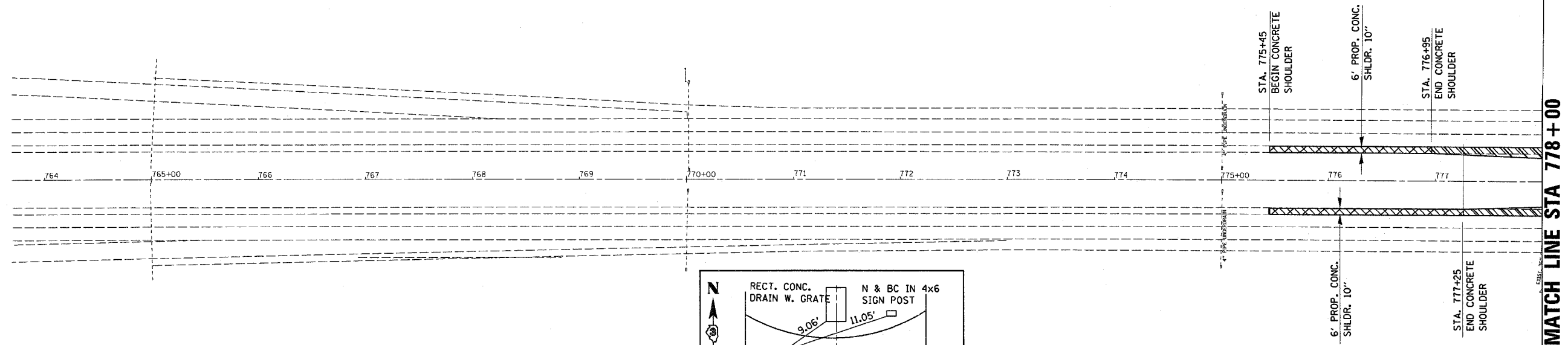

PCC SHOULDER REMOVAL
~~CONTINUOUSLY REINFORCED PCC PVMT 10"~~
 PCC PVMT 10" (JOINTED)
 PCC SHOULDERS 10"

MATCH LINE STA 778+00

REMOVE AND REINSTALL CONCRETE HEADWALL FOR PIPE UNDERDRAINS 2 EACH

STA 782+00 PIPE CULVERT CL A, TY 1 18" - 800 FT 18" PRC FL. END SECT. - 1 EACH

STA. 783+96 BEGIN FULL WIDTH CONCRETE PVMT.

PAVEMENT REMOVAL 230 50 YDS

STA. 790+00 REMOVE PIPE CULVERT - 18 FT PROP. PIPE CULVERT CL A, TY 1 24" - 33 FT PROP. INLET TY. B W' TY 1 F&G O.L.

STA. 792+12.5 END TEMPORARY CONCRETE BARRIER.

STA. 792+65 BEGIN 13' CONCRETE PVMT JOINTED

MATCH LINE STA 778+00

MATCH LINE STA 793+00

PCC SHOULDER REMOVAL
 BITUMINOUS SHOULDER REMOVAL
 PROPOSED 10" CONCRETE SHOULDER
~~CONTINUOUSLY REINFORCED PCC PVMT 10"~~
 PCC PVMT 10" (JOINTED)

IMPACT ATTENUATOR (NON-REDIRECTIVE) TEST LEVEL 3 - 1 EACH

STA 788+00 PROP. DRAINAGE STRUCTURE TY. 1, WITH (2) TY. 20 F & G

IMPACT ATTENUATOR REMOVAL - 1 EACH

STA 792+77 PIPE CULVERT CL A, TY 1 18" - 277 FT 18" PRC FL. END SECT. - 1 EACH

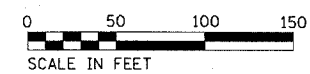

REVISIONS	
NAME	DATE

ILLINOIS DEPARTMENT OF TRANSPORTATION

CROSSOVER PLAN SOUTH

SCALE: VERT. DATE
HORIZ.

DRAWN BY
CHECKED BY

REVISED
7-27-2005

PLOT DATE = 4/22/2005
FILE NAME = #FILEL#
PLOT SCALE = #SCALE#
REFERENCE = #REF#

F.A. RTE.	SECTION	COUNTY	TOTAL SHEETS	SHEET NO.
39	(50-4)I	LASALLE	33	12
STA.	TO STA.			
FED. ROAD DIST. NO.	ILLINOIS	FED. AID PROJECT		



MATCH LINE STA 793 + 00

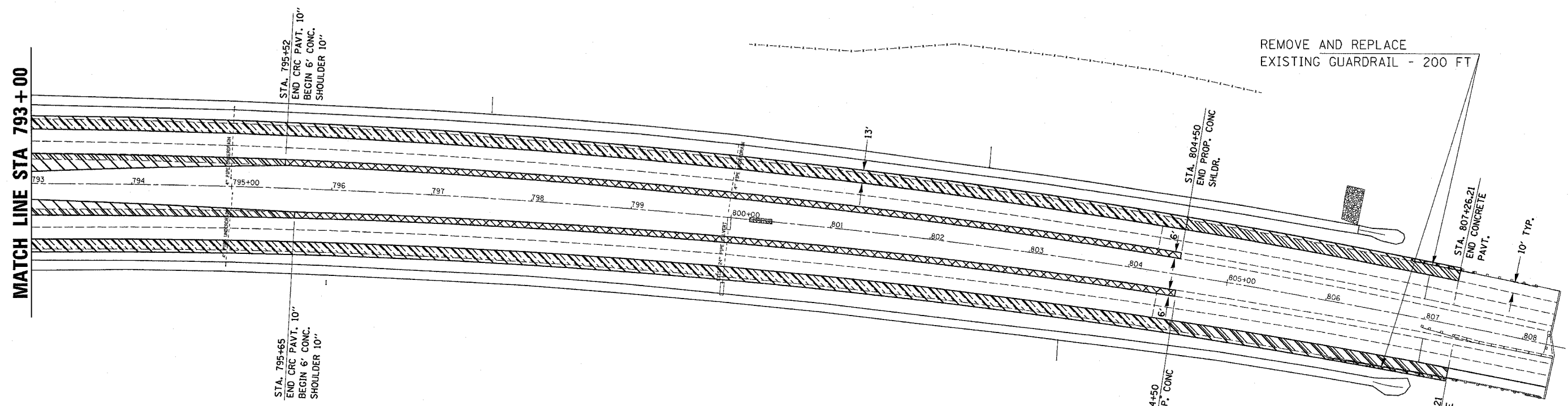

REMOVE AND REPLACE EXISTING GUARDRAIL - 200 FT

- PCC SHOULDER REMOVAL
- BITUMINOUS SHOULDER REMOVAL
- PROPOSED 10" CONCRETE SHOULDER
- CONTINUOUSLY REINFORCED PCC PVMT 10" PCC PVMT 10" (JOINTED)

EXIST. CURVE 39CLS-1
 PI STA. = 806+74.99
 $\Delta = 21^\circ 02' 26''$ (RT)
 $D = 0^\circ 44' 58''$
 $R = 7,644.15'$
 $T = 1,419.56'$
 $L = 2,807.14'$
 $E = 130.69'$
 $e = \dots$
 $T.R. = \dots$
 $S.E. RUN = \dots$
 $P.C. STA. = 792+55.43$
 $P.T. STA. = 820+62.57$

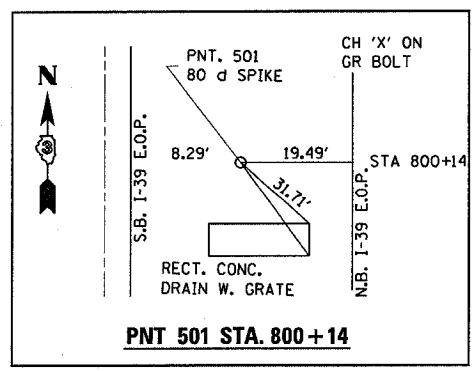

PNT 501 STA. 800+14

PLOT DATE : 4/22/2005
 FILE NAME : #FILEL#
 PLOT SCALE : #SCALE#
 REFERENCE : #REF#

REVISED
7-27-2005

REVISIONS	
NAME	DATE

ILLINOIS DEPARTMENT OF TRANSPORTATION



CROSSOVER PLAN SOUTH

SCALE: VERT. _____
 HORIZ. _____
 DATE _____

DRAWN BY _____
 CHECKED BY _____

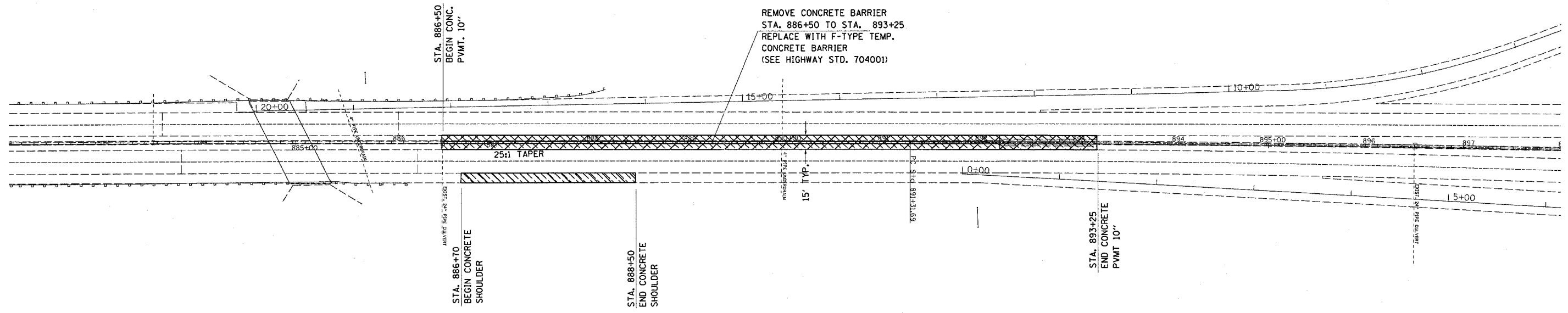
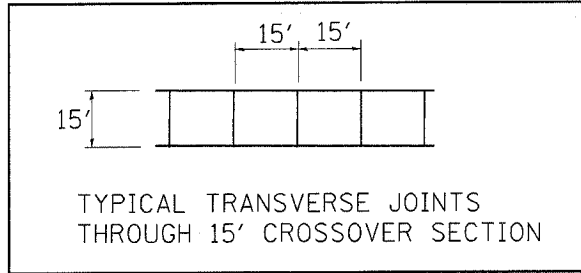
F.A. RTE.	SECTION	COUNTY	TOTAL SHEETS	SHEET NO.
39	(50-4)I	LASALLE	33	13
STA.	TO STA.			
FED. ROAD DIST. NO.	ILLINOIS	FED. AID PROJECT		

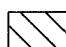

-  PCC SHOULDER REMOVAL
-  BITUMINOUS SHOULDER REMOVAL
-  PROPOSED 10" CONCRETE SHOULDER
-  CONTINUOUSLY REINFORCED PCC PVMT 10" (JOINTED)

REVISED
7-27-2005

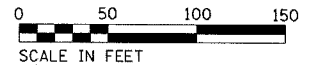
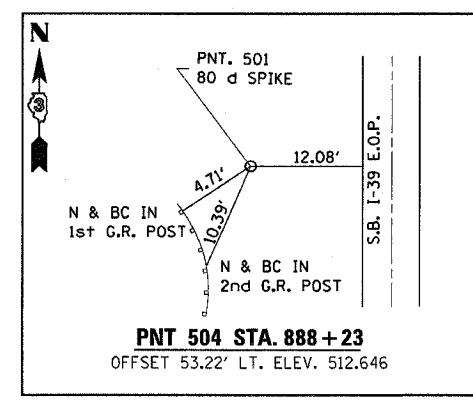

REVISIONS	
NAME	DATE

ILLINOIS DEPARTMENT OF TRANSPORTATION

CROSSOVER PLAN NORTH

SCALE: VERT. DATE
HORIZ. CHECKED BY

DRAWN BY

PLOT DATE: 4/25/2005
 FILE NAME: **FILE**
 PLOT SCALE: **SCALE**
 REFERENCE: **REF**