

F.A.P. RTE.	SECTION	COUNTY	TOTAL SHEETS	SHEET NO.
325	113RS-2	JERSEY	8	1

STATE OF ILLINOIS
DEPARTMENT OF TRANSPORTATION
DIVISION OF HIGHWAYS

**PROPOSED
HIGHWAY PLANS**

FAP ROUTE 325 (IL 16)
SECTION 113RS-2
PROJECT (-)
MILLING & RESURFACING
JERSEY COUNTY
C-98-100-05

FOR INDEX OF SHEETS, SEE SHEET NO. 2

D-98-080-05

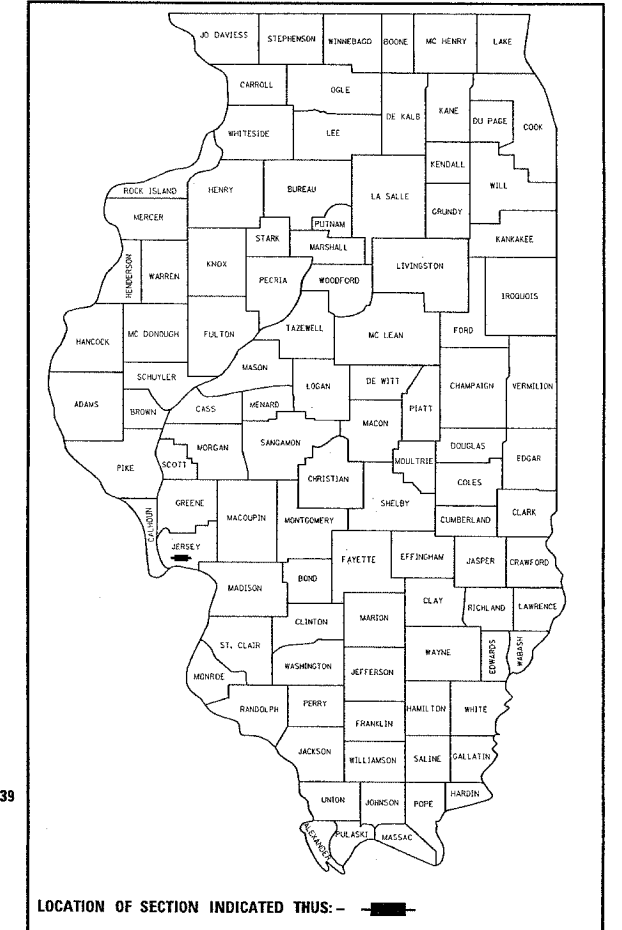

LOCATION OF SECTION INDICATED THUS: —

BRIDGE OMISSION:
S.N. 042-0018
M.S. 16.01 TO M.S. 16.06
(252 FT)

BRIDGE OMISSION:
S.N. 042-0019
M.S. 17.35 TO M.S. 17.39
(212 FT)

BEGIN PROJECT
M.S. 15.59
LAT: 39.11656
LONG: -90.28189

END PROJECT
M.S. 22.79
LAT: 39.11610
LONG: -90.14569

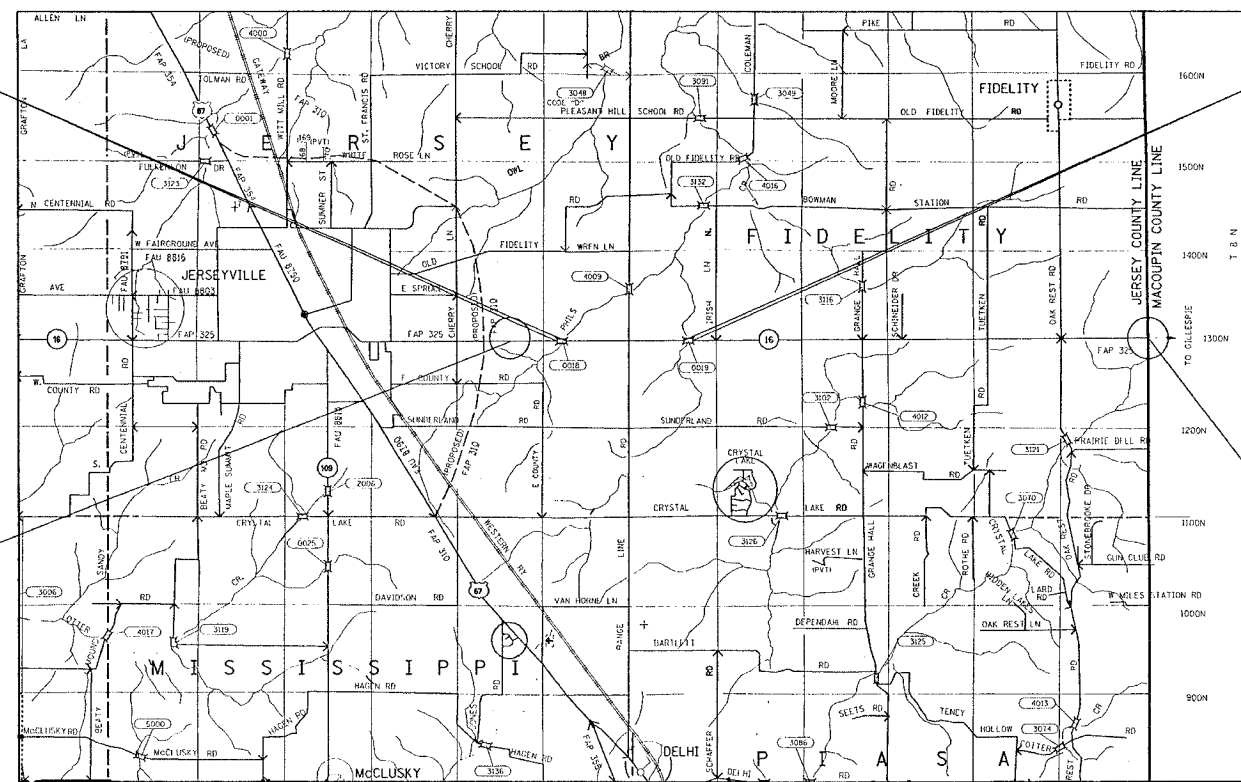

MICROFILMED
REEL NUMBER _____
AWARDED _____
RESIDENT ENGINEER _____
AS BUILT CHANGES WERE MADE
ON THE FOLLOWING SHEETS _____

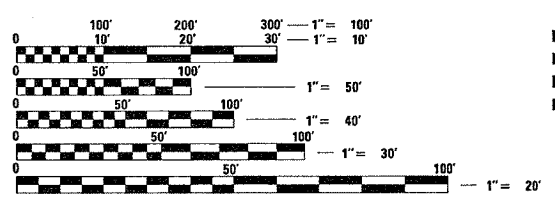

FULL SIZE PLANS HAVE BEEN PREPARED USING STANDARD ENGINEERING SCALES. REDUCED SIZED PLANS WILL NOT CONFORM TO STANDARD SCALES. IN MAKING MEASUREMENTS ON REDUCED PLANS, THE ABOVE SCALES MAY BE USED.

J.U.L.I.E.
JOINT UTILITY LOCATION INFORMATION FOR EXCAVATION
1-800-892-0123

2003 ADT: 2750
2025 ADT: 3400
SU: 4.0%
MU: 3.3%

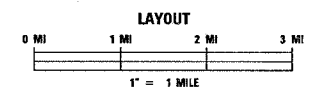

GROSS LENGTH: 7.2 MILES (38,016 FT)
NET LENGTH: 7.1 MILES (37,552 FT)

CONTRACT NO. 76937

STATE OF ILLINOIS
DEPARTMENT OF TRANSPORTATION
DIVISION OF HIGHWAYS

SUBMITTED May 19 2005

May C. Lammie
DEPUTY DIRECTOR OF HIGHWAYS
REGION FIVE ENGINEER

July 1 2005
Mike Shea
ENGINEER OF DESIGN AND ENVIRONMENT

July 1 2005
Victor Moders
DIRECTOR, DIVISION OF HIGHWAYS

**PRINTED BY THE AUTHORITY
OF THE STATE OF ILLINOIS**

PROJECT ENGINEER: PATTI LEBEAU (618) 346-3179
SQUAD LEADER: CHERYL KEPLAR (618) 346-3186

FAP ROUTE	SECTION	COUNTY	TOTAL SHEETS	SHEET NO
325	113RS-2	JERSEY	8	2
STA _____		TO STA _____		
CONTRACT NUMBER:				76937

GENERAL NOTES

1. THE STANDARDS AND REVISIONS NUMBERS LISTED APPLY TO THIS PROJECT.
2. IF ANY SECTION OR SUBSECTION MONUMENTS ARE ENCOUNTERED, THE ENGINEER SHALL BE NOTIFIED BEFORE SUCH MONUMENTS ARE REMOVED OR RESURFACED OVER. THE CONTRACTOR SHALL PROTECT AND CAREFULLY PRESERVE ALL PROPERTY MARKERS AND MONUMENTS UNTIL THE OWNER, AN AUTHORIZED SURVEYOR, OR AGENT HAS WITNESSED OR OTHERWISE REFERENCE THEIR LOCATION.
3. THE THICKNESS OF BITUMINOUS MIXTURES SHOWN IN THE PLANS IS THE NOMINAL THICKNESS. DEVIATIONS FROM THE NOMINAL THICKNESS WILL BE PERMITTED WHEN SUCH DEVIATIONS OCCUR DUE TO IRREGULARITIES IN THE EXISTING SURFACE ON WHICH THE BITUMINOUS MIXTURE IS PLACED.
4. AN ESTIMATED 2,870 TONS OF BITUMINOUS SURFACE WILL BE REMOVED.
5. THE FOLLOWING MIXTURE REQUIREMENTS ARE APPLICABLE FOR THIS PROJECT.

MIXTURE REQUIREMENTS	
MIXTURE USE	SURFACE
ACPG	PG 64-22
RAP% (MAX)	15%
DESIGN AIR VOIDS	4.0% @ Ndes = 50
MIX COMPOSITION	
(GRADATION MIXTURE)	
FRICITION AGG	MIXTURE "C"

6. THE CONTRACTOR SHALL VERIFY ALL DIMENSIONS AND CONDITIONS IN THE FIELD PRIOR TO CONSTRUCTION AND ORDERING OF MATERIALS.
7. NO OVERNIGHT LANE CLOSURES WILL BE ALLOWED.
8. UTILITY CONFLICTS ARE NOT ANTICIPATED ON THIS CONTRACT. SHOULD THIS PROVE TO BE OTHERWISE DURING ANY OF THE REQUIRED OPERATIONS. THE ENGINEER IS TO BE NOTIFIED AT THE TIME OF THE OCCURRENCE. NO ADDITIONAL COST SHALL BE ADDED TO THE CONTRACT RESULTING FROM THIS OCCURRENCE. THE JOINT UTILITY LOCATING INFORMATION FOR EXCAVATORS (J.U.L.I.E.) SYSTEM NUMBER IS (800-892-0123).
 - * AMEREN-CIPS
 - * FRONTIER COMMUNICATIONS COMPANY
 - * JERSEY COUNTY RURAL WATER COMPANY
9. "ROAD CONSTRUCTION AHEAD" SIGNS SHALL BE PLACED AT ENTRANCES AND SIDE STREETS WHERE WORK IS BEING CONDUCTED AS DIRECTED BY THE RESIDENT ENGINEER. ALL CONSTRUCTION SIGN SHALL BE FLORESCENT ORANGE. THIS SHALL BE INCLUDED IN THE COST OF THE TRAFFIC CONTROL AND PROTECTION.
10. SHORT-TERM PAVEMENT MARKINGS SHALL BE APPLIED TO THE MILLED, PRIMED, AND FINAL BITUMINOUS SURFACE. A QUANTITY FOR TEMPORARY PAVEMENT MARKING EQUAL TO THE AMOUNT OF PERMANENT PAVEMENT MARKING HAS BEEN ADDED TO THE PLANS.
11. ALL TEMPORARY PAVEMENT MARKING WILL BE PLACED IN SUCH A MANNER SO AS NOT TO INTERFERE WITH THE PLACEMENT OF PERMANENT PAVEMENT MARKINGS.

INDEX OF SHEETS

1. COVER SHEET
2. INDEX OF SHEETS, HIGHWAY STANDARDS, MIXTURE REQUIREMENTS, GENERAL NOTES, AND COMMITMENTS
3. SUMMARY OF QUANTITIES
- 4.-5. TYPICAL SECTIONS
6. SCHEDULES OF QUANTITIES
7. LOCATION MAP
8. PLAN DETAILS

LIST OF STANDARDS

- 000001-04
- 442201-01
- 701011-01
- 701301-02
- 701306-01
- 701311-02
- 701336-04
- 702001-05
- 780001-01
- 781001-02

COMMITMENT

NONE

REVISIONS	
NAME	DATE

ILLINOIS DEPARTMENT OF TRANSPORTATION
**INDEX OF SHEETS,
 STANDARDS, GENERAL NOTES**
 FAP ROUTE 325 (IL 16)
 SECTION 113RS-2
 JERSEY COUNTY

DRAWN BY:

PLOT DATE: *DATE-TIME*

DATE	BY	REVISIONS	PLANNED	FILED	FILED	FILED	FILED

STATES
 "DATE-TIME"
 "DATE-TIME"
 "DATE-TIME"

SUMMARY OF QUANTITIES

FAP ROUTE	SECTION	COUNTY	TOTAL SHEETS	SHEET NO.
325	113RS-2	JERSEY	8	3
STA. _____		TO STA. _____		
CONTRACT NUMBER: 76937				

SUMMARY OF QUANTITIES			CONSTRUCTION TYPE CODE		
CODE NO	ITEM	UNIT	TOTAL QUANTITIES	RURAL 1000 100% STATE	
40600200	BITUMINOUS MATERIALS (PRIME COAT)	TON	33	33	
40600300	AGGREGATE (PRIME COAT)	TON	154	154	
40600980	BITUMINOUS SURFACE REMOVAL - BUTT JOINT	SQ YD	342	342	
40600990	TEMPORARY RAMP	SQ YD	139	139	
44000002	BITUMINOUS SURFACE REMOVAL 1/2"	SQ YD	102444	102444	
44200274	PAVEMENT PATCHING, TYPE I	SQ YD	6.7	6.7	
44200276	PAVEMENT PATCHING, TYPE II	SQ YD	86.1	86.1	
44200278	PAVEMENT PATCHING, TYPE III	SQ YD	17.8	17.8	
44200280	PAVEMENT PATCHING, TYPE IV	SQ YD	86.7	86.7	
48101200	AGGREGATE SHOULDERS, TYPE B	TON	1402	1402	
67000400	ENGINEER'S FIELD OFFICE, TYPE A	CAL MO	3	3	
67100100	MOBILIZATION	L SUM	1	1	
70100460	TRAFFIC CONTROL AND PROTECTION, STANDARD 701306	L SUM	1	1	
70100600	TRAFFIC CONTROL AND PROTECTION, STANDARD 701336	L SUM	1	1	
70300100	SHORT-TERM PAVEMENT MARKING	FOOT	6828	6828	
70300220	TEMPORARY PAVEMENT MARKING - LINE 4"	FOOT	96162	96162	
70301000	WORK ZONE PAVEMENT MARKING REMOVAL	SQ FT	1175	1175	
* 78000200	THERMOPLASTIC PAVEMENT MARKING - LINE 4"	FOOT	96162	96162	
* 78100100	RAISED REFLECTIVE PAVEMENT MARKER	EACH	469	469	
78300200	RAISED REFLECTIVE PAVEMENT MARKER REMOVAL	EACH	469	469	
X4066414	BITUMINOUS CONCRETE SURFACE COURSE, SUPERPAVE, MIX "C", N50	TON	8606	8606	

SUMMARY OF QUANTITIES			CONSTRUCTION TYPE CODE		
CODE NO	ITEM	UNIT	TOTAL QUANTITIES		

*SPECIALTY ITEMS

FAP ROUTE	SECTION	COUNTY	TOTAL SHEETS	SHEET NO
325	113RS-2	JERSEY	8	4
STA. _____		TO STA. _____		
CONTRACT NUMBER:		76937		

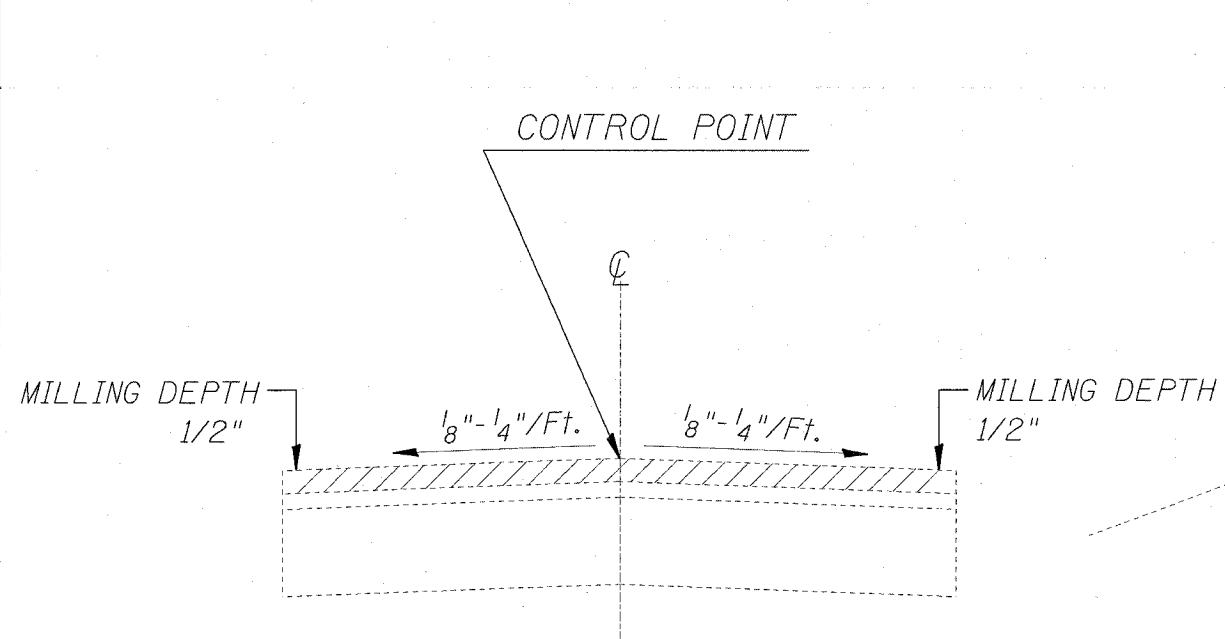

MILLING DETAIL

M.S. 15.59 TO M.S. 16.01
M.S. 16.06 TO M.S. 17.35
M.S. 17.39 TO M.S. 17.67
M.S. 17.67 TO M.S. 22.79

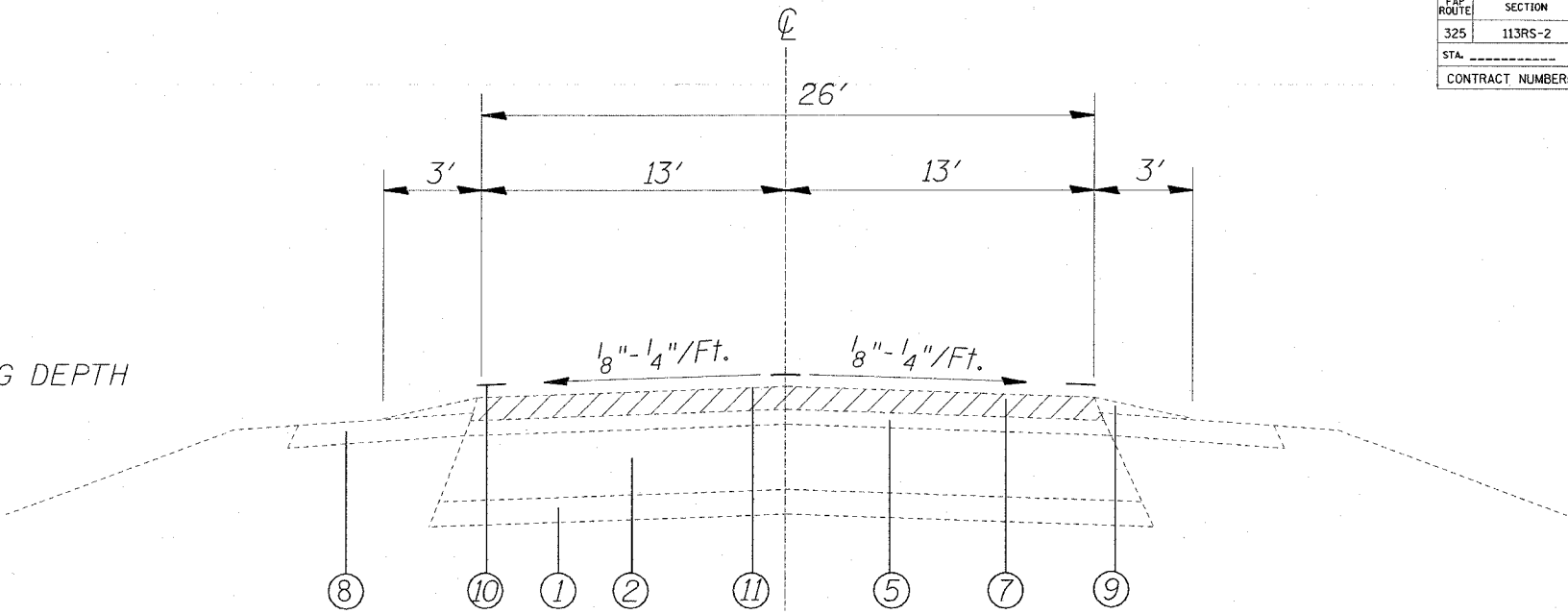

EXISTING TYPICAL SECTION

M.S. 15.59 TO M.S. 16.01
M.S. 16.06 TO M.S. 17.35
M.S. 17.39 TO M.S. 17.67

LEGEND

- ① EXISTING 4" SUB-BASE GRANULAR MATERIAL, TYPE A
- ② EXISTING 6" BITUMINOUS BASE COURSE
- ③ EXISTING PAVEMENT 9"-6"-9"
- ④ EXISTING BITUMINOUS BASE COURSE WIDENING, 9"
- ⑤ EXISTING RESURFACING
- ⑥ EXISTING STRIP REFLECTIVE CRACK CONTROL TREATMENT
- ⑦ EXISTING BITUMINOUS CONCRETE SURFACE COURSE, MIXTURE "D" CLASS I, T2 1 1/2"
- ⑧ EXISTING AGGREGATE SHOULDERS TYPE A, 6"
- ⑨ EXISTING AGGREGATE WEDGE
- ⑩ EXISTING PAVEMENT MARKINGS
- ⑪ PROPOSED BITUMINOUS SURFACE REMOVAL 1/2"

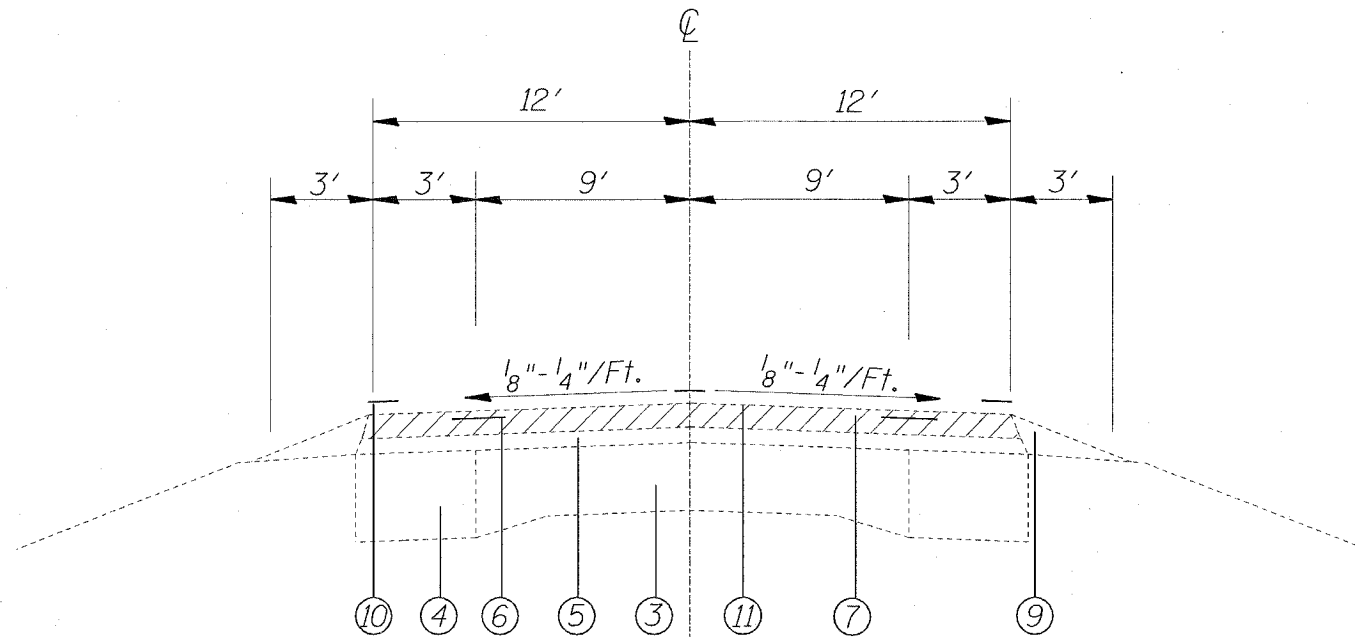

EXISTING TYPICAL SECTION

M.S. 17.67 to M.S. 22.79

REVISIONS	
NAME	DATE

ILLINOIS DEPARTMENT OF TRANSPORTATION

EXISTING TYPICAL SECTIONS

FAP ROUTE 325 (IL 16)
SECTION 113RS-2
JERSEY COUNTY

DRAWN BY:

PLOT DATE: .DATE-TIME-

DATE	
BY	
REVISIONS	
PLANNED	
ALIGNED	
DESIGNED	
CHECKED	
NO. _____	

DATE-TIME-
DATE-TIME-
DATE-TIME-

FAP ROUTE	SECTION	COUNTY	TOTAL SHEETS	SHEET NO.
325	113RS-2	JERSEY	8	5
STA.	TO STA.		CONTRACT NUMBER:	
			76937	

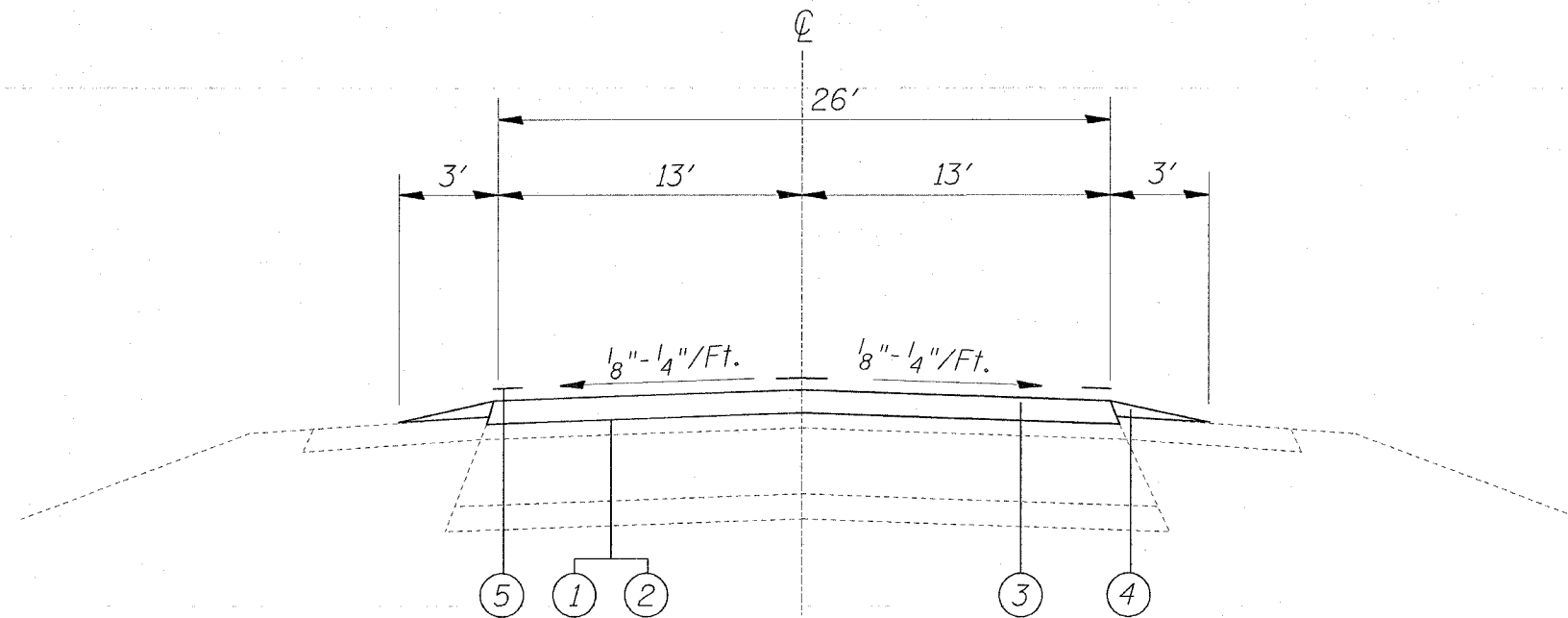

PROPOSED TYPICAL SECTION IL 16

M.S. 15.59 TO M.S. 16.01
M.S. 16.06 TO M.S. 17.35
M.S. 17.39 TO M.S. 17.67

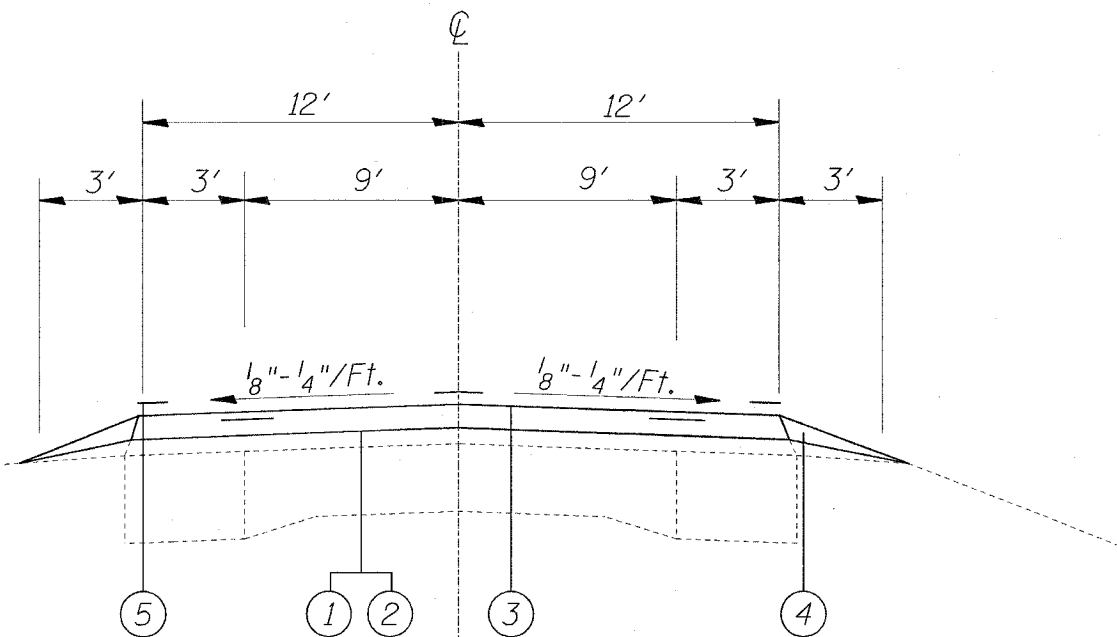

PROPOSED TYPICAL SECTION IL 16

M.S. 17.67 to M.S. 22.79

LEGEND

- ① PROPOSED AGGREGATE PRIME COAT
- ② PROPOSED BITUMINOUS PRIME COAT
- ③ PROPOSED BITUMINOUS SURFACE 1 1/2"
- ④ PROPOSED AGGREGATE WEDGE
- ⑤ PROPOSED PAVEMENT MARKINGS

REVISIONS	
NAME	DATE

ILLINOIS DEPARTMENT OF TRANSPORTATION
PROPOSED TYPICAL SECTIONS
FAP ROUTE 325 (IL 16)
SECTION 113RS-2
JERSEY COUNTY

DRAWN BY:

PLOT DATE: DATE-TIME

PLAN	DATE
SURVEYED	BY
NOTE BOOK	NO.
ALIGNED	FILE NAME
CHECKED	
NO. OF SHEETS	

#DATE#
#BOOK#
#REF#

FAP ROUTE	SECTION	COUNTY	TOTAL SHEETS	SHEET NO
325	113RS-2	JERSEY	8	6
STA. _____ TO STA. _____		CONTRACT NUMBER: 76937		

THERMOPLASTIC PAVEMENT MARKINGS

LOCATION			SKIP DASH YELLOW 4 IN (FT)	YELLOW 4 IN (FT)	WHITE 4 IN (FT)	EAST BOUND	WEST BOUND		
MILE STA	TO	MILE STA							
15.59	TO	15.61		211.2	211.2	NO PASSING	NO PASSING		
15.61	TO	15.72	145.2	580.8	1161.6	PASSING	NO PASSING		
15.72	TO	15.79	92.4		739.2	PASSING	PASSING		
15.79	TO	15.93	184.8	739.2	1478.4	NO PASSING	PASSING		
15.93	TO	16.01	105.6		844.8	PASSING	PASSING		
16.01	TO	16.06	BRIDGE OMISSION						
16.06	TO	16.77	937.2		7497.6	PASSING	PASSING		
16.77	TO	16.92	198	792	1584	PASSING	NO PASSING		
16.92	TO	16.98	79.2		633.6	PASSING	PASSING		
16.98	TO	17.16	237.6	950.4	1900.8	PASSING	NO PASSING		
17.16	TO	17.35	250.8		2006.4	PASSING	PASSING		
17.35	TO	17.39	BRIDGE OMISSION						
17.39	TO	17.57	237.6	950.4	1900.8	NO PASSING	PASSING		
17.57	TO	17.59		211.2	211.2	NO PASSING	NO PASSING		
17.59	TO	17.82	303.6	1214.4	2428.8	PASSING	NO PASSING		
17.82	TO	18.84	1346.4		10771.2	PASSING	PASSING		
18.84	TO	18.94	132	528	1056	NO PASSING	PASSING		
18.94	TO	19.31	488.4		3907.2	PASSING	PASSING		
19.31	TO	19.4	118.8	475.2	950.4	NO PASSING	PASSING		
19.4	TO	19.55	198		1584	PASSING	PASSING		
19.55	TO	19.63	105.6	422.4	844.8	PASSING	NO PASSING		
19.63	TO	19.65		211.2	211.2	NO PASSING	NO PASSING		
19.65	TO	19.76	145.2	580.8	1161.6	NO PASSING	PASSING		
19.76	TO	19.84	105.6		844.8	PASSING	PASSING		
19.84	TO	19.97	171.6	686.4	1372.8	PASSING	NO PASSING		
19.97	TO	20.15	237.6		1900.8	PASSING	PASSING		
20.15	TO	20.26	145.2	580.8	1161.6	NO PASSING	PASSING		
20.26	TO	20.36	132		1056	PASSING	PASSING		
20.36	TO	20.47	145.2	580.8	1161.6	PASSING	NO PASSING		
20.47	TO	21.7	1623.6		12988.8	PASSING	PASSING		
21.7	TO	21.8	132	528	1056	NO PASSING	PASSING		
21.8	TO	21.97	224.4		1795.2	PASSING	PASSING		
21.97	TO	22.07	132	528	1056	PASSING	NO PASSING		
22.07	TO	22.5	567.6		4540.8	PASSING	PASSING		
22.5	TO	22.69	250.8	1003.2	2006.4	NO PASSING	PASSING		
22.69	TO	22.79	132		1056	PASSING	PASSING		
TOTAL:			9306	11774.4	75081.6				
			96162						

RAISED REFLECTIVE PAVEMENT MARKERS				
LOCATION			DOUBLE AMBER	REMOVAL
MILE STA	TO	MILE STA		
15.59	TO	16.01	28	28
16.01	TO	16.06	BRIDGE OMISSION	
16.06	TO	17.35	85	85
17.35	TO	17.39	BRIDGE OMISSION	
17.39	TO	22.79	356	356
TOTAL:			469	469

PAVEMENT PATCHING

PATCH LOCATION		PATCH SIZE	PATCH TYPE			
MILE STA.	LANES		I	II	III	IV
17.79	WB	6X20		13.3		
	WB	6X30				20
	WB	6X15		10		
18.69	WB	12X15				20
18.89	WB	6X15		10		
19.19	EB	6X6	4			
19.59	WB	12X8		10.7		
19.99	WB	6X4	2.7			
20.39	WB	12X15				20
20.79	WB	12X8		10.7		
22.19	WB	12X8		10.7		
	WB	40X4			17.8	
22.79	WB	12X20				26.7
	EB	12X8		10.7		
EB	6X15			10		
SUB TOTALS:			6.7	86.1	17.8	86.7

RESURFACING SCHEDULE

MILE STA	TO	MILE STA	BIT. CONC. SURF. CSE. MIX C, N50 TONS	BIT. MATL. PRIME COAT TONS	AGGREGATE PRIME COAT TONS	BIT. SURF. REMOVAL 1/2" SQ. YDS.	AGGREGATE SHOULDER TONS
15.59	TO	16.01	538.6	2.2	9.6	6406.9	83
BRIDGE OMISSION							
16.06	TO	17.35	1652.9	6.3	29.6	19676.8	255
BRIDGE OMISSION							
17.39	TO	17.67	358.8	1.4	6.4	4270.7	55
17.67	TO	22.79	6055.7	22.7	108.4	72089.6	1009
TOTAL:			8606	32.6	154	102444	1402

REVISIONS	
NAME	DATE

ILLINOIS DEPARTMENT OF TRANSPORTATION

SCHEDULE OF QUANTITIES

FAP ROUTE 325 (IL 16)
SECTION 113RS-2
JERSEY COUNTY

DRAWN BY: _____

PLAN
 DATE _____
 DRAWN BY _____
 CHECKED BY _____
 IN CHARGE _____
 TITLE _____
 NO. _____
 SHEET NO. _____

QUANTITIES
 DATE-TIME
 REF.
 FILE

Rev.

PLOT DATE: _____ DATE-TIME: _____

FAP ROUTE	SECTION	COUNTY	TOTAL SHEETS	SHEET NO
325	113RS-2	JERSEY	8	7
STA.	TO STA.		CONTRACT NUMBER: 76937	

PLAN	SURVEYED	DATE
NO.	BY	
	NOTED	
	PLotted	
	INT. CHECKED	
	EXT. CHECKED	
	ADD. FILE NAME	

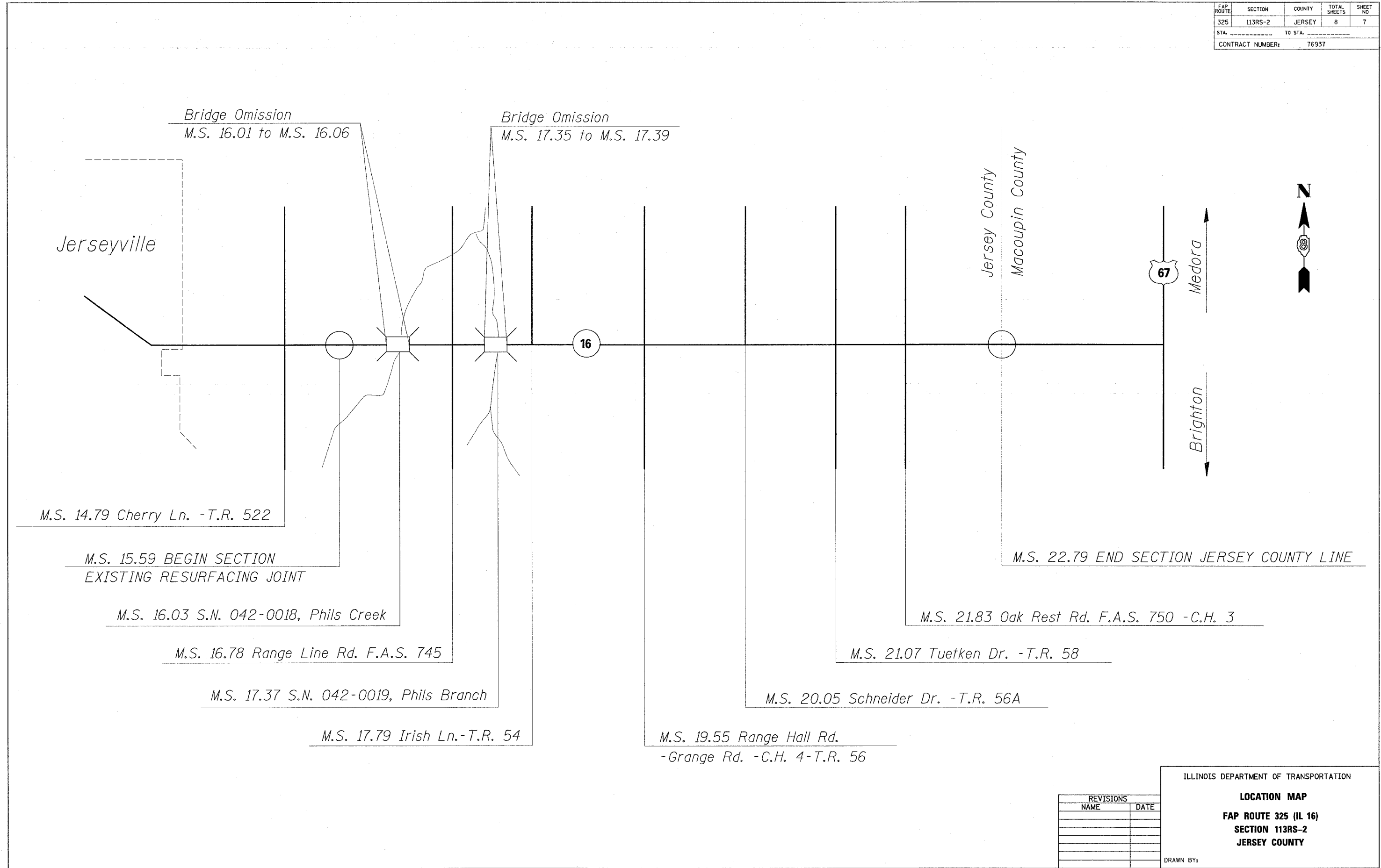

*DATE**
 DATE-TIME
 SPEC
 REF
 REF

REVISIONS	
NAME	DATE

ILLINOIS DEPARTMENT OF TRANSPORTATION

LOCATION MAP

FAP ROUTE 325 (IL 16)

SECTION 113RS-2

JERSEY COUNTY

DRAWN BY:

PLOT DATE: *DATE-TIME*

FAP ROUTE	SECTION	COUNTY	TOTAL SHEETS	SHEET NO
325	113RS-2	JERSEY	8	8
STA.	TO STA.			
CONTRACT NUMBER:			76937	

PLAN	DATE
BY	
DESIGNED	
CHECKED	
IN CHARGE	
DATE	
NO.	
FILE NAME	

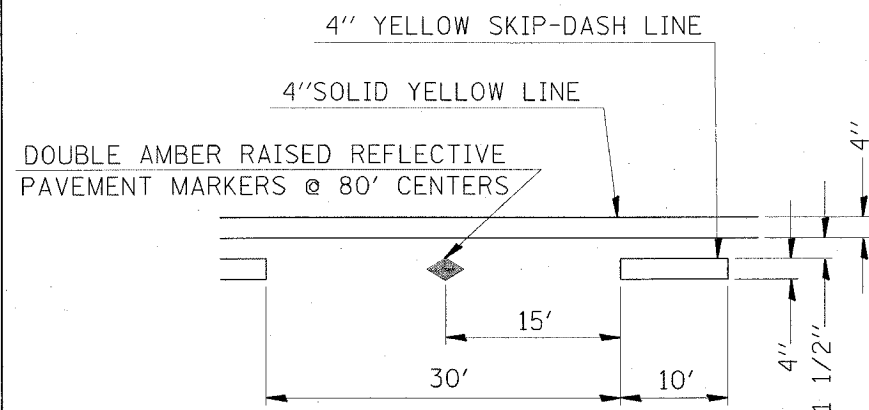

TYPICAL APPLICATION FOR PASSING/NO PASSING LINES WITH RAISED REFLECTIVE PAVEMENT MARKERS

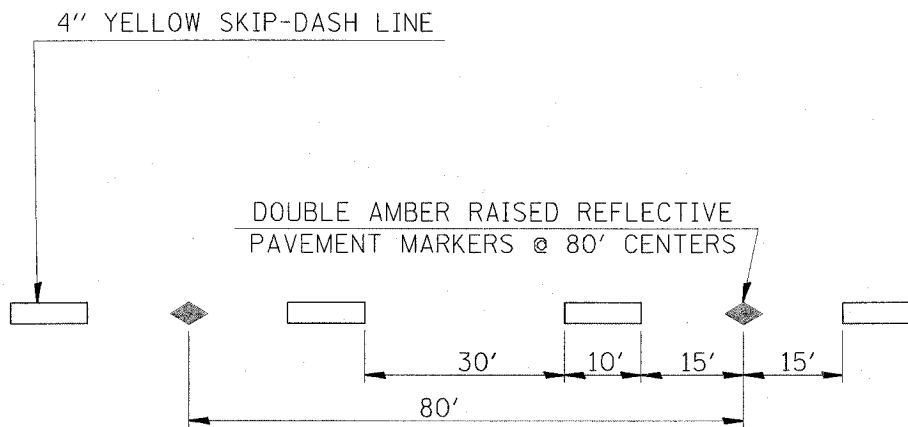

TYPICAL APPLICATION FOR YELLOW SKIP-DASH LINES WITH RAISED REFLECTIVE PAVEMENT MARKERS

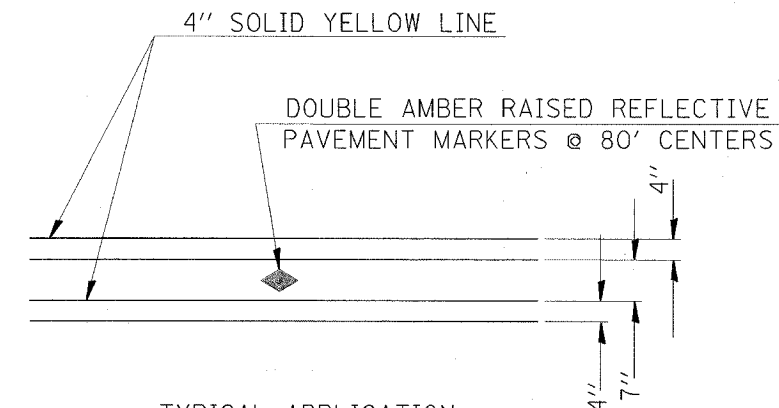

TYPICAL APPLICATION FOR DOUBLE YELLOW LANE LINES WITH RAISED REFLECTIVE PAVEMENT MARKERS

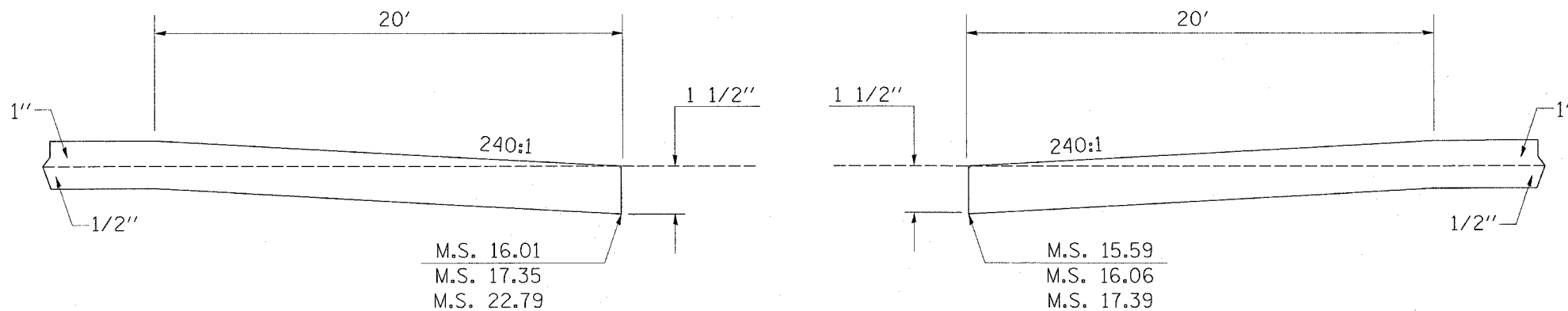

BUTT JOINT DETAIL

REVISIONS	
NAME	DATE

ILLINOIS DEPARTMENT OF TRANSPORTATION

PLAN DETAILS
FAP ROUTE 325 (IL 16)
SECTION 113RS-2
JERSEY COUNTY

DRAWN BY:

PLOT DATE: _DATE-TIME_

DATE
DATE-TIME
REF-SPEC
REF