

F.A.U. RITE	SECTION	COUNTY	TOTAL SHEETS	SHEET NO.
1636	92-0003-03-PV	WILL	33	17
STA		TO STA.		
FED. ROAD DIST. NO.	ILLINOIS	FED. AID PROJECT		

83680

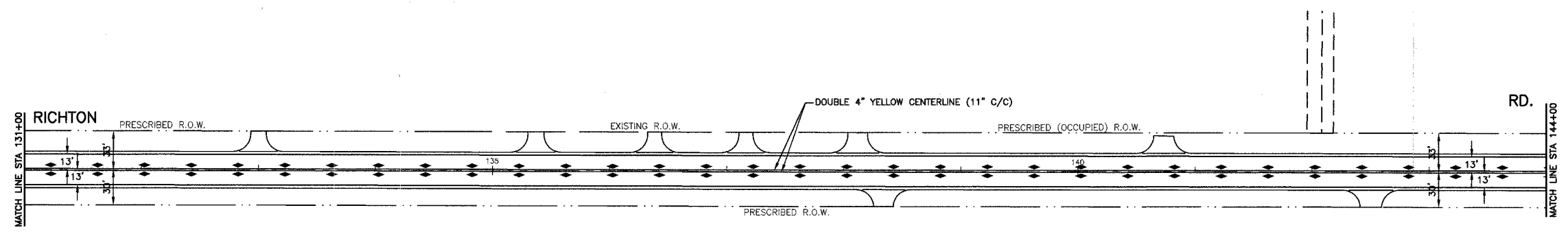
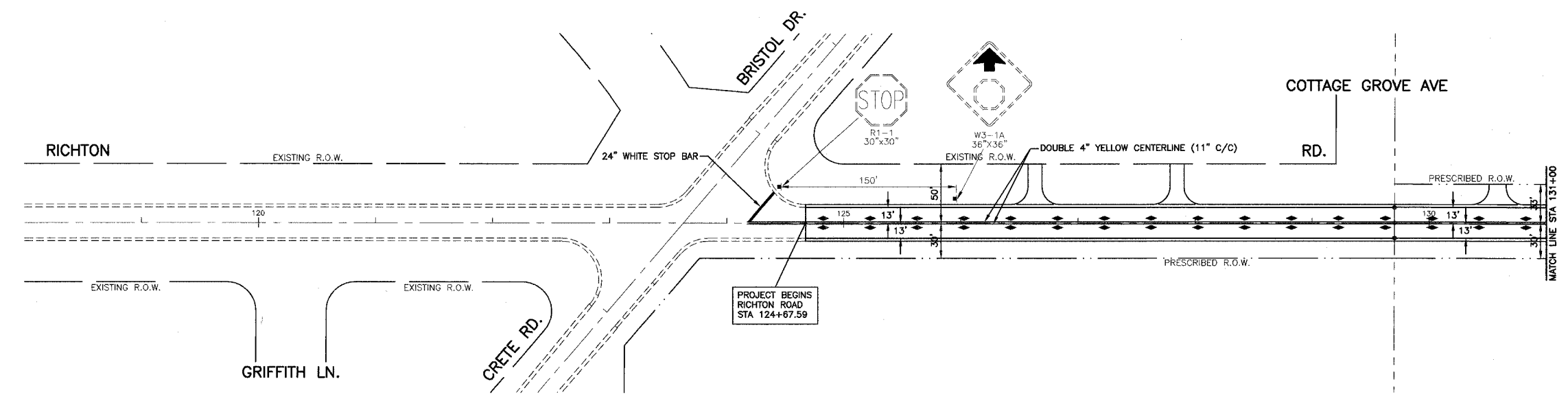

PAVEMENT MARKING LEGEND

- ◁ ONE-WAY CRYSTAL MARKER
(40' C-C UNLESS OTHERWISE NOTED.)
- ◆ TWO-WAY AMBER MARKER
(40' C-C UNLESS OTHERWISE NOTED.)
- ✦ PROPOSED SIGN

NOTE:
ALL PAVEMENT MARKINGS SHALL BE THERMOPLASTIC UNLESS OTHERWISE NOTED.

REVISIONS	
NAME	DATE

ILLINOIS DEPARTMENT OF TRANSPORTATION

F.A.U. 1636 RICHTON ROAD

PAVEMENT MARKING AND SIGNING

BEGIN PROJECT TO STA 144+00

SCALE: VERT. 1"=50'
HORIZ. 1"=50'

DATE 02-17-03

DRAWN BY AG
CHECKED BY PKB