

DAVID C. & ANN G. BONNER
SE 1/4, NW 1/4, SEC 31, T 46 N, R 11 E, 3RD P.M.

C.H.	SECTION	COUNTY	TOTAL SHEETS	SHEET NO.
14	99-00076-11-BR	LAKE	66	13
STA. 16+40		TO STA. 22+00		
FED. ROAD DIST. NO. ILLINOIS FED. AID PROJECT				
CONTRACT NO: 83763				

DATE	BY	REVISION

DATE	BY	REVISION

CURVE DATA
 PI STA. 17+12.00
 $\Delta = 18^\circ 56' 05''$ (RT)
 $D = 4^\circ 00' 00''$
 $T = 238.91'$
 $R = 1,432.70'$
 $L = 473.47'$
 $E = 19.78'$
 P.C. STA. 14+73.09
 P.T. STA. 19+46.56
 S.E. = 0.056 FT/FT
 TRANSITION IN 124 FT.
 FROM STA. 13+46.02 TO STA. 15+14.42
 FROM STA. 19+05.23 TO STA. 20+73.63

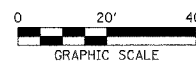

MATCH LINE STATION 16+40

IMPROVEMENT ENDS STATION 20+73.63

AREA #1 WETLANDS IMPACTED 2,126 SQ. FT. 0.049 ACRES

AREA #2 WETLANDS IMPACTED 1,567 SQ. FT. 0.036 ACRES

AREA #3 WETLANDS IMPACTED 322 SQ. FT. 0.007 ACRES

STA. 17+65 - SPECIAL BRIDGE DESIGN CONTINUOUS REINFORCED CONCRETE SLAB BRIDGE. 3 SPANS: 36'-0", 43'-0", 36'-0" 40'-0" RDWY; 14' BIKE PATH; SKEW=10° S.E. = 0.056 FT/FT.

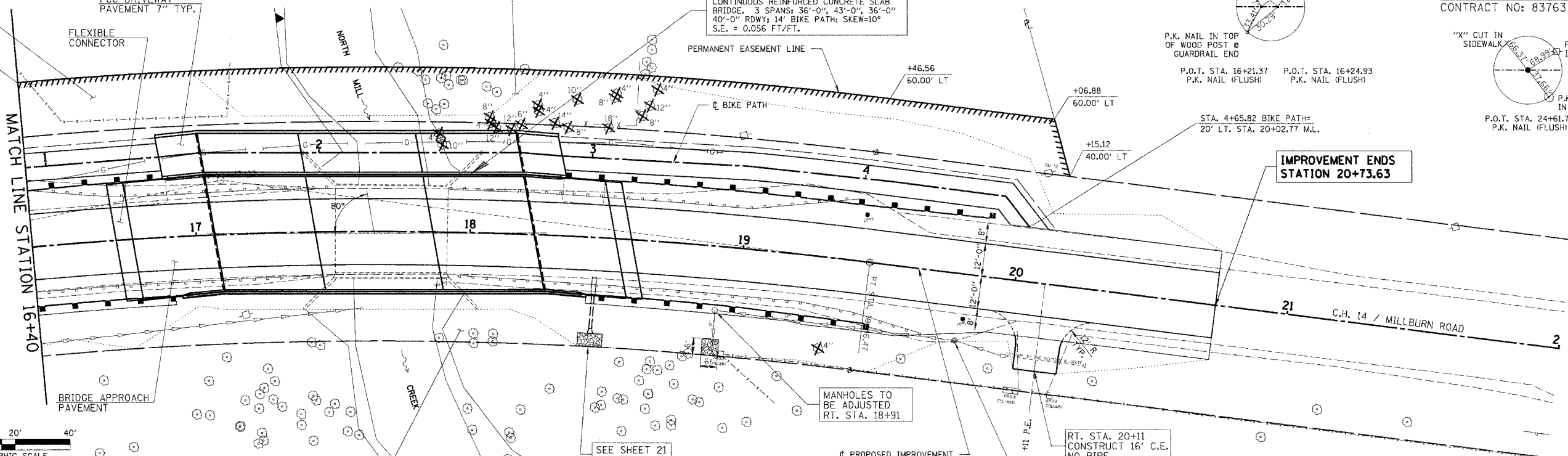
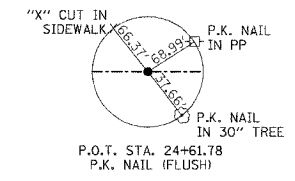
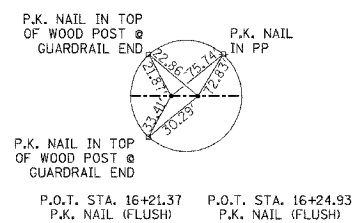

LEGEND
 STONE RIPRAP, CLASS A4

EXISTING STRUCTURE NO. 049-3013
 STATION 14+50 - SINGLE SPAN REINFORCED CONCRETE TEE GIRDER BRIDGE WITH CONCRETE RAILING ON CLOSED CONCRETE ABUTMENTS. 43.0' BK-BK. ABUTTS: 33.0' O-O. DECK REMOVAL OF EXISTING STRUCTURES = 1 EACH

