

FAA FILE NO.	SECTION	COUNTY	TOTAL SHEETS	SHEET NO.
1346	*	COOK/DUPAGE	84	9
CONSTRUCTION PROCEDURE-STAGE 1				
FED. ROAD DISTRICT NO. 7	ILLINOIS	FED. AID PROJECT M-7003(857)		

*ELK GROVE VILLAGE SECTION 99-00041-00-CH
CONTRACT NO. 83766

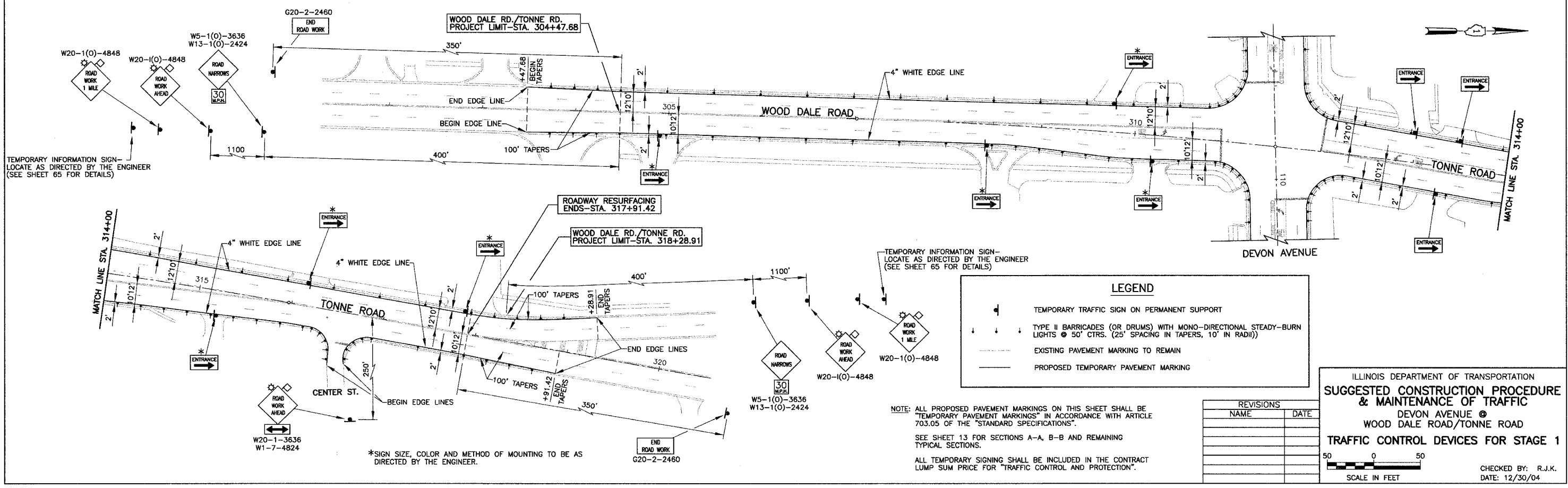
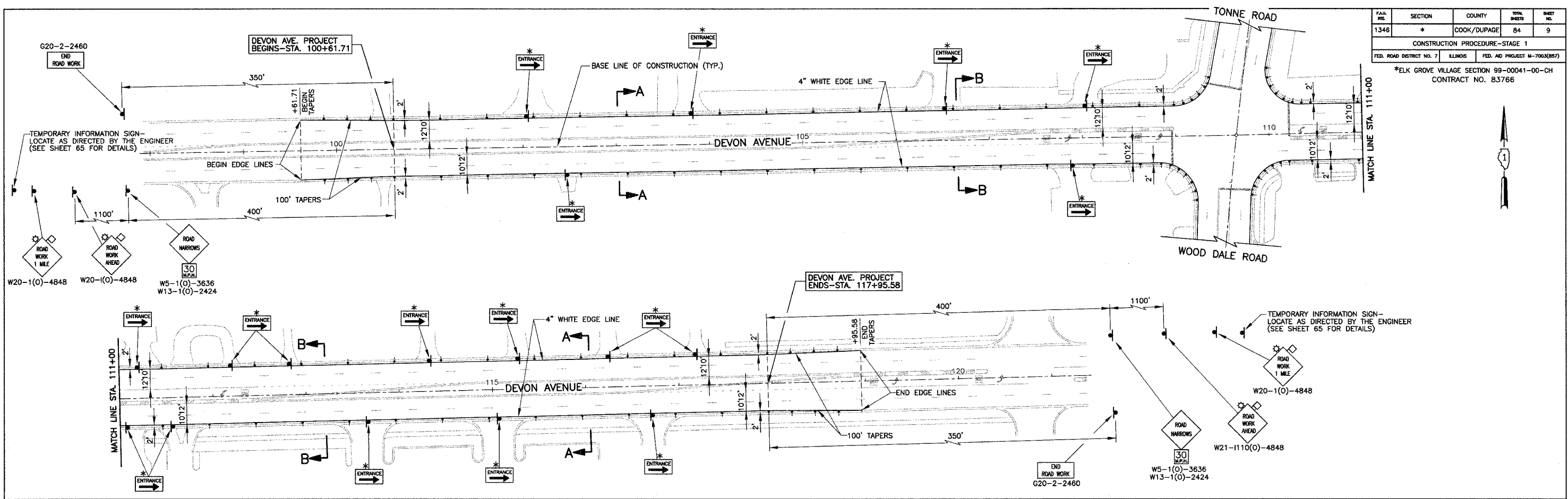

LEGEND

- ▲ TEMPORARY TRAFFIC SIGN ON PERMANENT SUPPORT
- ▼ TYPE II BARRICADES (OR DRUMS) WITH MONO-DIRECTIONAL STEADY-BURN LIGHTS @ 50' CTRS. (25' SPACING IN TAPERS, 10' IN RADII)
- EXISTING PAVEMENT MARKING TO REMAIN
- PROPOSED TEMPORARY PAVEMENT MARKING

NOTE: ALL PROPOSED PAVEMENT MARKINGS ON THIS SHEET SHALL BE "TEMPORARY PAVEMENT MARKINGS" IN ACCORDANCE WITH ARTICLE 703.05 OF THE "STANDARD SPECIFICATIONS".
SEE SHEET 13 FOR SECTIONS A-A, B-B AND REMAINING TYPICAL SECTIONS.
ALL TEMPORARY SIGNING SHALL BE INCLUDED IN THE CONTRACT LUMP SUM PRICE FOR "TRAFFIC CONTROL AND PROTECTION".

REVISIONS	
NAME	DATE

ILLINOIS DEPARTMENT OF TRANSPORTATION
SUGGESTED CONSTRUCTION PROCEDURE & MAINTENANCE OF TRAFFIC
DEVON AVENUE @
WOOD DALE ROAD/TONNE ROAD
TRAFFIC CONTROL DEVICES FOR STAGE 1

50 0 50
SCALE IN FEET

CHECKED BY: R.J.K.
DATE: 12/30/04

*SIGN SIZE, COLOR AND METHOD OF MOUNTING TO BE AS DIRECTED BY THE ENGINEER.