

FILE NO.	SECTION	COUNTY	TOTAL SHEETS	SHEET NO.
1346	*	COOK/DUPAGE	84	17

PLAN & PROFILE-DEVON AVE. STA. 102+00 TO 107+00  
 FED. ROAD DISTRICT NO. 7 ILLINOIS FED. AID PROJECT M-7003(857)

\*ELK GROVE VILLAGE SECTION 99-00041-00-CH  
 CONTRACT NO. 83766

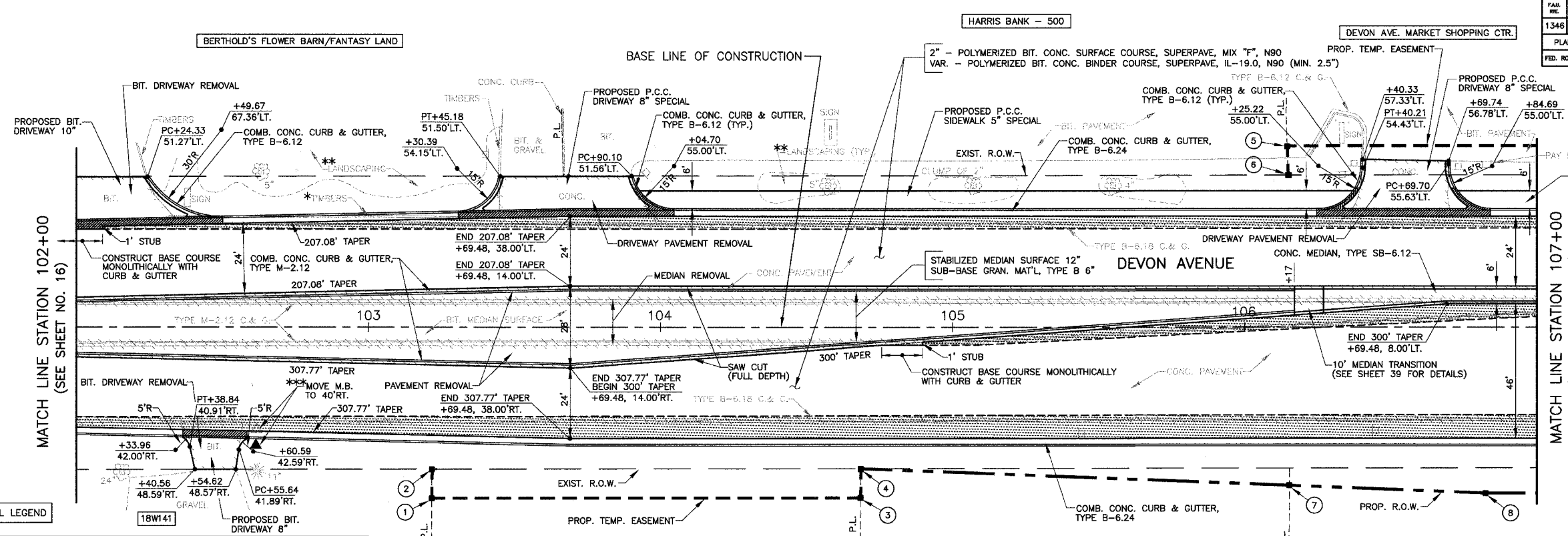

SEE SHEET 38 FOR ADDITIONAL LEGEND

**LEGEND**

- 2" - POLYMERIZED BIT. CONC. SURFACE COURSE, SUPERPAVE, MIX "F", N90  
 VAR. - POLYMERIZED BIT. CONC. BINDER COURSE, SUPERPAVE, IL-19.0, N90 (MIN. 2.5")
- 10" - PORTLAND CEMENT CONCRETE BASE COURSE
- 6" - SUB-BASE GRANULAR MATERIAL, TYPE B
- PROPOSED DEPRESSED CURB (FINAL LAYOUT SHALL BE APPROVED BY ENGINEER)
- PAVEMENT REMOVAL, DRIVEWAY PAVEMENT REMOVAL, BITUMINOUS DRIVEWAY REMOVAL OR MEDIAN REMOVAL
- COMBINATION CURB & GUTTER REMOVAL
- KEYED LONGITUDINAL JOINT WITHOUT TIE BARS
- PROP. R.O.W. CONTROL POINT (SEE SHEET 8 FOR LOCATIONS)

VACANT

\*TO BE REMOVED (COST INCLUDED IN "EARTH EXCAVATION")  
 \*\*TO BE REMOVED FROM R.O.W. (INCIDENTAL TO "EARTH EXCAVATION")  
 \*\*\*SEE NOTE "C" ON SHEET 2

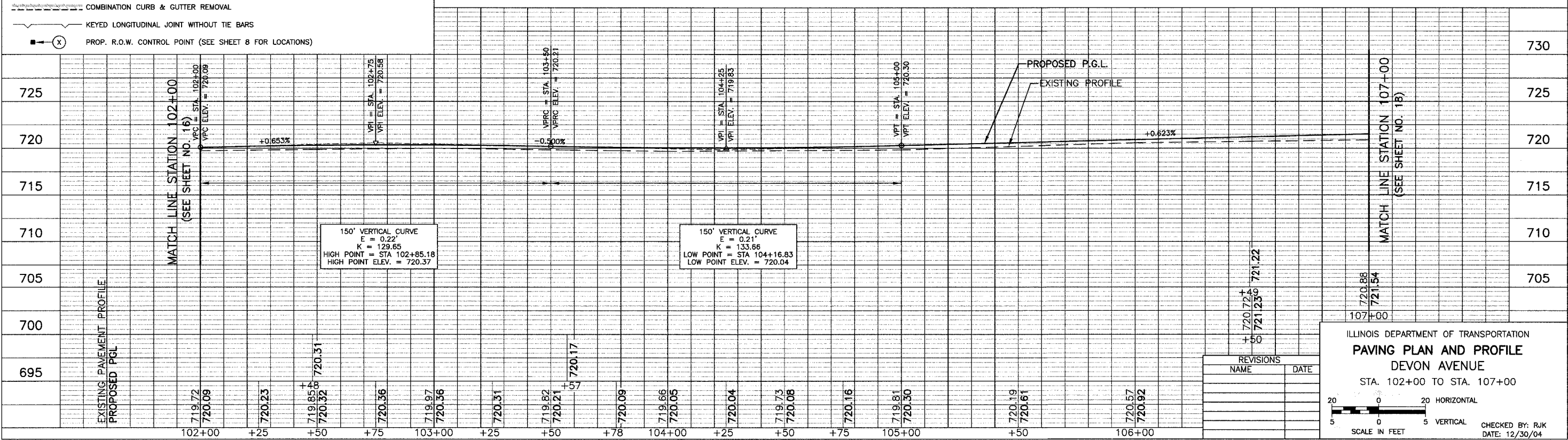

REVISIONS

NAME	DATE

ILLINOIS DEPARTMENT OF TRANSPORTATION  
**PAVING PLAN AND PROFILE**  
 DEVON AVENUE  
 STA. 102+00 TO STA. 107+00

SCALE IN FEET: 20 0 20 HORIZONTAL, 5 0 5 VERTICAL

CHECKED BY: RJK  
 DATE: 12/30/04