

SECTION	COUNTY	TOTAL SHEETS	SHEET NO.
*	COOK/DUPAGE	84	23

PLAN & PROFILE-TONNE RD. STA. 312+50 TO 317+50  
 ILLINOIS FED. AID PROJECT M-7003(857)  
 \*ELK GROVE VILLAGE SECTION 99-00041-00-CH  
 CONTRACT NO. 83766

BITUMINOUS SURFACE TREATMENT, CLASS A-1  
 PARKING LOT PAVEMENT REMOVAL  
 END 126.43' TAPER  
 BEGIN 56.58' TAPER  
 +32.65, 24.29'LT.

NOTE: REMOVAL OF EXISTING CURB STOPS WHEN DIRECTED BY THE ENGINEER SHALL BE INCLUDED IN THE COST OF "PARKING LOT PAVEMENT REMOVAL"

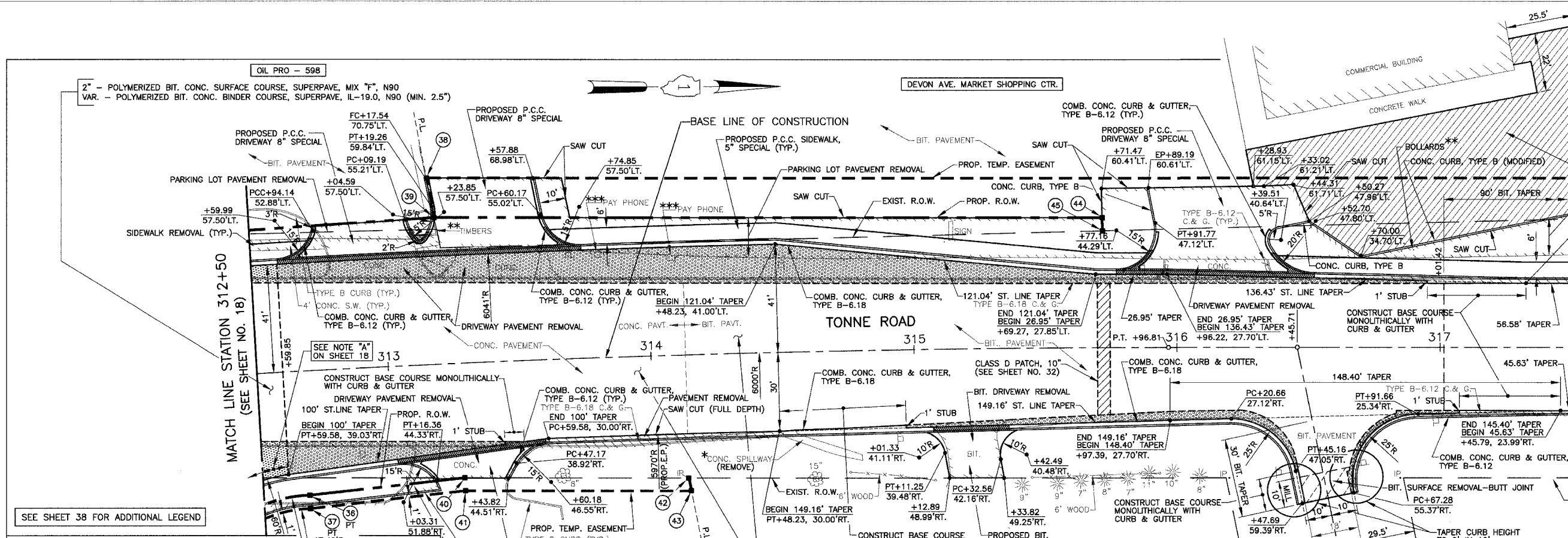

SEE SHEET 38 FOR ADDITIONAL LEGEND

**LEGEND**

- 2" - POLYMERIZED BIT. CONC. SURFACE COURSE, SUPERPAVE, MIX "F", N90  
VAR. - POLYMERIZED BIT. CONC. BINDER COURSE, SUPERPAVE, IL-19.0, N90 (MIN. 2.5")
- 10" - PORTLAND CEMENT CONCRETE BASE COURSE  
6" - SUB-BASE GRANULAR MATERIAL, TYPE B
- 2" - BIT. CONC. SURFACE COURSE, SUPERPAVE, MIX "D", N70  
VAR. - BIT. CONC. BINDER COURSE, SUPERPAVE, IL-19.0, N70 (MIN. 2.5")
- 10" - PORTLAND CEMENT CONCRETE BASE COURSE  
4" - SUB-BASE GRANULAR MATERIAL, TYPE B
- PROPOSED DEPRESSED CURB (FINAL LAYOUT SHALL BE APPROVED BY THE ENGINEER)
- PAVEMENT REMOVAL, PARKING LOT PAVEMENT REMOVAL, DRIVEWAY PAVEMENT REMOVAL, BITUMINOUS DRIVEWAY REMOVAL OR SIDEWALK REMOVAL
- COMBINATION CURB & GUTTER REMOVAL
- CURB REMOVAL
- PROP. R.O.W. CONTROL POINT (SEE SHEET 8 FOR LOCATIONS)

- \*TO BE PAID FOR AS "COMBINATION CURB AND GUTTER REMOVAL"
- \*\*TO BE REMOVED (COST INCLUDED IN "EARTH EXCAVATION")
- \*\*\*TO BE REMOVED BY OTHERS

**BASE LINE CURVE DATA**

Δ = 8°-32'-57"  
 R = 8000.00'  
 T = 448.42'  
 L = 895.28'  
 E = 16.73'  
 P.C. = 307+01.53  
 P.I. = 311+49.95  
 P.T. = 315+96.81

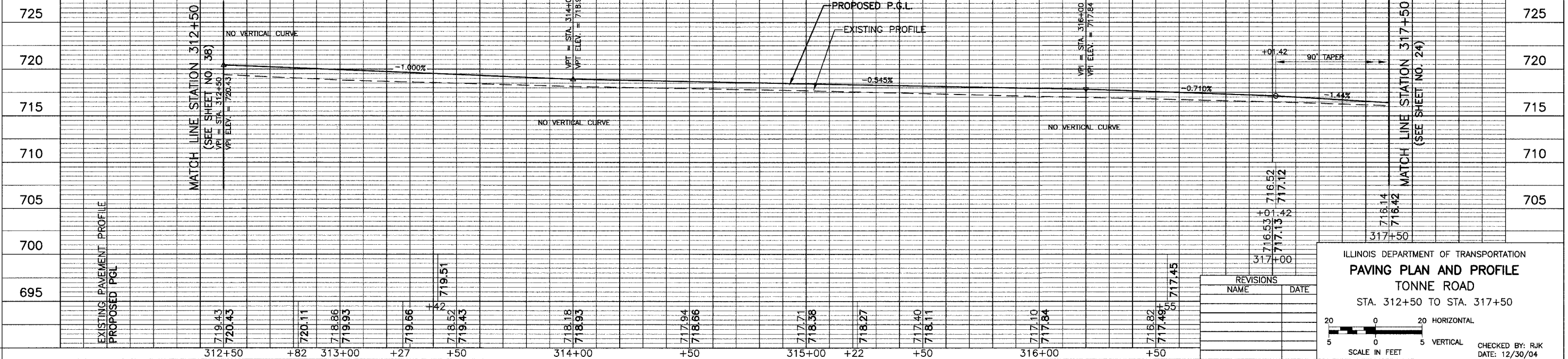

ILLINOIS DEPARTMENT OF TRANSPORTATION  
**PAVING PLAN AND PROFILE**  
**TONNE ROAD**  
 STA. 312+50 TO STA. 317+50

REVISIONS	NAME	DATE

SCALE IN FEET  
 20 0 20 HORIZONTAL  
 5 0 5 VERTICAL

CHECKED BY: RJK  
 DATE: 12/30/04