

F.A.P. ROUTE	COUNTY SECTION	COUNTY	TOTAL SHEET
336	99-00243-00-PV	KANE	268
CONTRACT NO. 83782			12
PROPOSED TYPICAL SECTIONS			
F.H.W.A. REG. 5 [ILLINOIS] PROJECT F-0336(00B)			

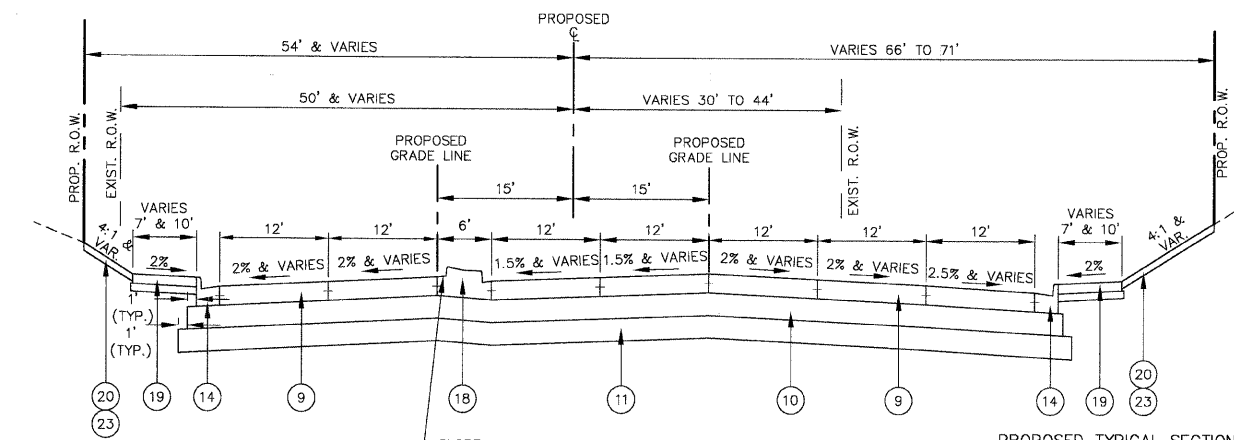

**PROPOSED TYPICAL SECTION**  
 RANDALL ROAD / IL. RTE. 64 INTERSECTION  
 STA. 349+07 TO STA. 350+95

- 12 HIGH-EARLY-STRENGTH PCC PAVEMENT, 10" (JOINTED)  
SEE SHEET NO. 109 FOR PAVEMENT JOINTS AND ELEVATIONS.
- 10 AGGREGATE SUBGRADE, 12"
- 11 POROUS GRANULAR EMBANKMENT, SPECIAL 12" WITH GEOTECHNICAL FABRIC FOR GROUND STABILIZATION

**PROPOSED TYPICAL SECTION**  
 IL. RTE. 64  
 STA. 347+46 TO STA. 349+07

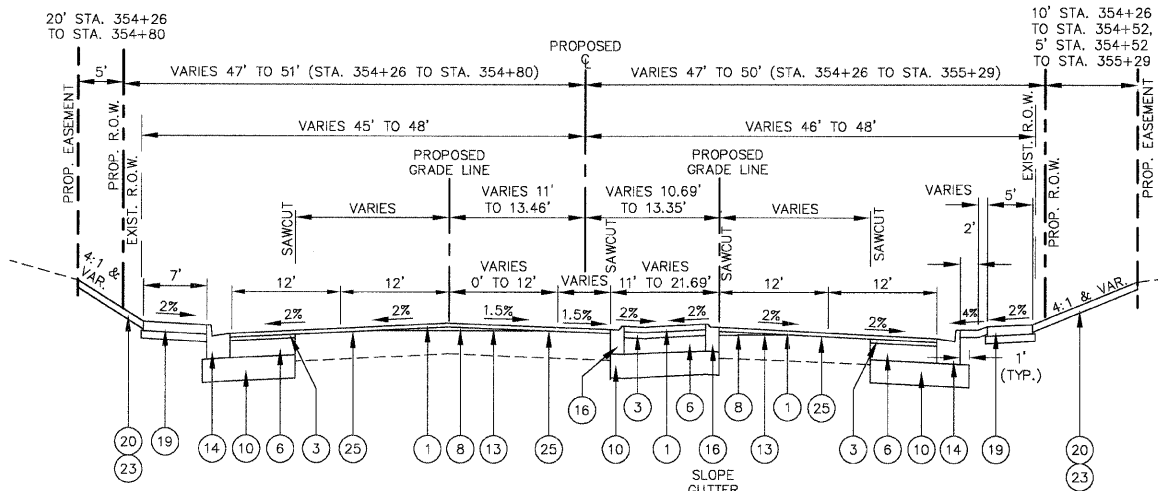

**PROPOSED TYPICAL SECTION**  
 IL. RTE. 64  
 STA. 354+26 TO STA. 356+05

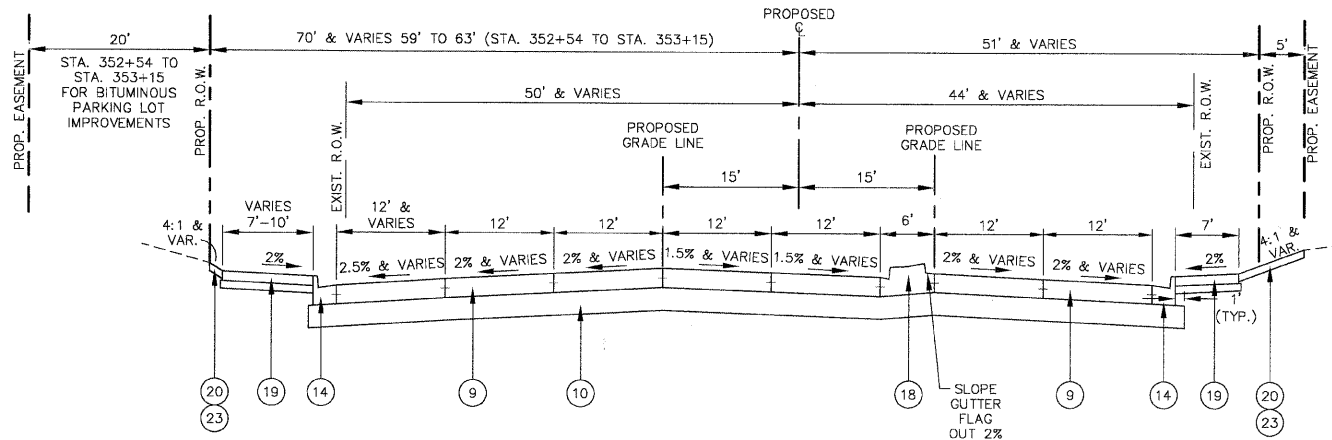

**PROPOSED TYPICAL SECTION**  
 IL. RTE. 64  
 STA. 350+95 TO STA. 353+15

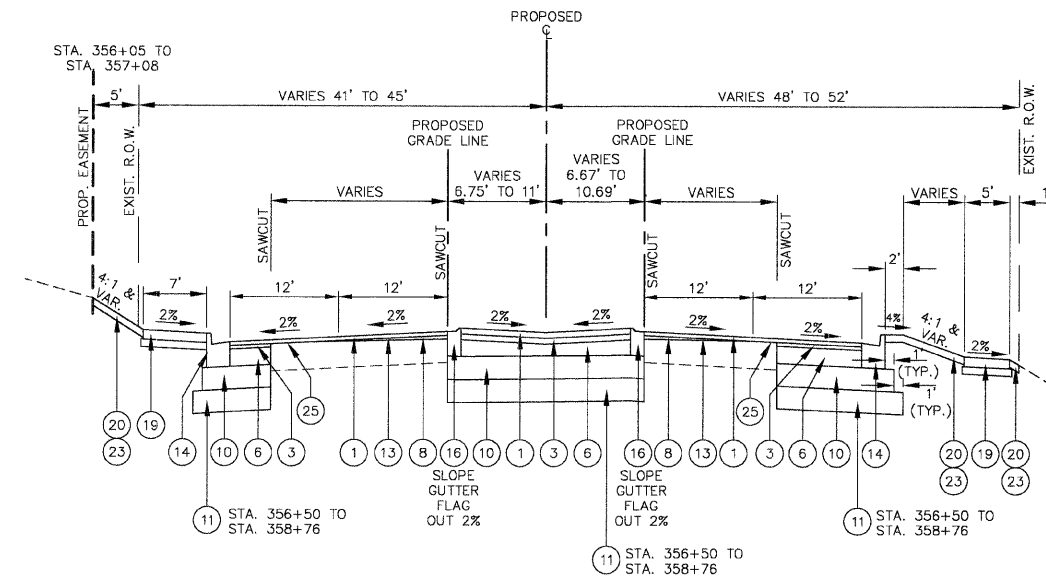

**PROPOSED TYPICAL SECTION**  
 IL. RTE. 64  
 STA. 356+05 TO STA. 358+76

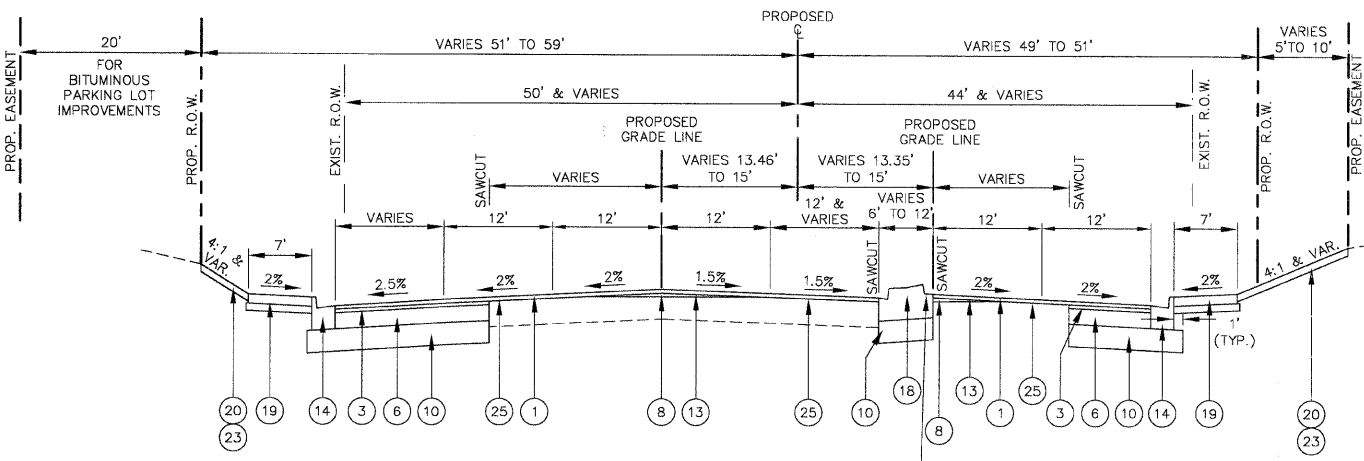

**PROPOSED TYPICAL SECTION**  
 IL. RTE. 64  
 STA. 353+15 TO STA. 354+26

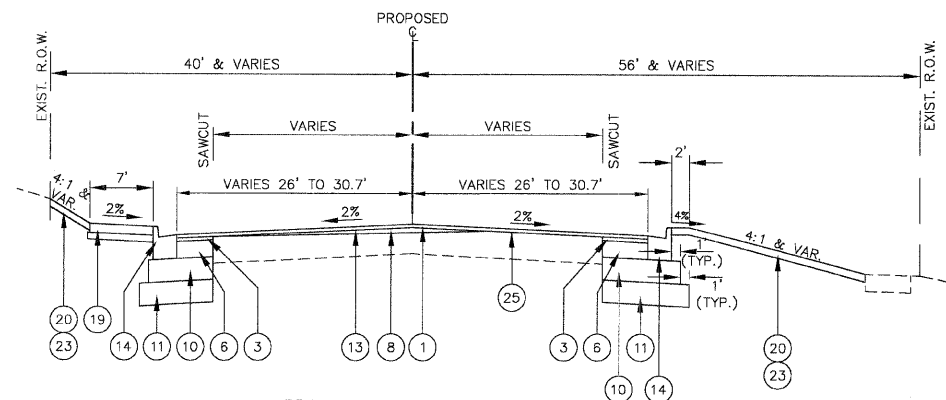

**PROPOSED TYPICAL SECTION**  
 IL. RTE. 64  
 STA. 358+76 TO STA. 361+18

NOTE: STA. 361+18 TO STA. 364+25  
 GRIND 2" (25)  
 OVERLAY (1)

**PROPOSED TYPICAL SECTION ITEMS**

- 1 POLYMERIZED BITUMINOUS CONCRETE SURFACE COURSE, SUPERPAVE, MIX "F", N90, 2"
- 2 BITUMINOUS CONCRETE SURFACE COURSE, SUPERPAVE, MIX "D", N50, 2"
- 3 BITUMINOUS CONCRETE BINDER COURSE, SUPERPAVE, IL-19, N90, 2 1/4"
- 4 BITUMINOUS CONCRETE BINDER COURSE, SUPERPAVE, IL-19, N50, 2 1/4"
- 5 BITUMINOUS BASE COURSE, SUPERPAVE, 9 3/4"
- 6 BITUMINOUS BASE COURSE, SUPERPAVE, 8 3/4"
- 7 BITUMINOUS BASE COURSE, SUPERPAVE, 5 3/4"
- 8 LEVELING BINDER (MACHINE METHOD), SUPERPAVE, N70
- 9 PORTLAND CEMENT CONCRETE PAVEMENT, 10" (JOINTED) JOINTS @ 15' C/C SEE STANDARDS FOR TIE BARS AND DOWEL BARS
- 10 AGGREGATE SUBGRADE, 12"
- 11 POROUS GRANULAR EMBANKMENT, SPECIAL 12" WITH GEOTECHNICAL FABRIC FOR GROUND STABILIZATION
- 12 HIGH-EARLY-STRENGTH PORTLAND CEMENT CONCRETE PAVEMENT, 10" (JOINTED)
- 13 AREA REFLECTIVE CRACK CONTROL TREATMENT, SYSTEM A
- 14 COMBINATION CONCRETE CURB AND GUTTER, TYPE B-6.24
- 15 COMBINATION CONCRETE CURB AND GUTTER, TYPE B-6.12
- 16 COMBINATION CONCRETE CURB AND GUTTER, TYPE M-2.12
- 17 PORTLAND CEMENT CONCRETE CORRUGATED MEDIAN
- 18 CONCRETE MEDIAN, TYPE SB-6.12
- 19 PORTLAND CEMENT CONCRETE SIDEWALK, 5" WITH AGGREGATE BASE COURSE, TYPE B, 4"
- 20 TOPSOIL FURNISH AND PLACE, 4"
- 21 TOPSOIL FURNISH AND PLACE, 24" (LANDSCAPED MEDIAN, SEE LANDSCAPING PLANS FOR GRADING)
- 22 SEEDING CLASS 2A
- 23 SODDING, SALT TOLERANT
- 24 STEEL PLATE BEAM GUARD RAIL, TYPE A & GUARDRAIL STABILIZATION BITUMINOUS SHOULDERS SUPERPAVE 6"
- 25 BITUMINOUS SURFACE REMOVAL
- 26 STABILIZED BIKE PATH BITUMINOUS CONCRETE SURFACE COURSE, SUPERPAVE, MIX "C", N50, 3"; AGGREGATE BASE COURSE, TYPE B, 6"; AGGREGATE SHOULDERS, TYPE B, 6"
- 27 PIPE UNDERDRAIN, 4"