

F.A.P. ROUTE	99-00243-00-PV	COUNTY SECTION	336	COUNTY	KANE	TOTAL SHEET NO.	268
CONTRACT NO.	83782					SHITS	68
PLAN & PROFILE STA. 36+50 TO STA. 41+50							
F.H.W.A. REG. 5 ILLINOIS PROJECT F-0336(008)							

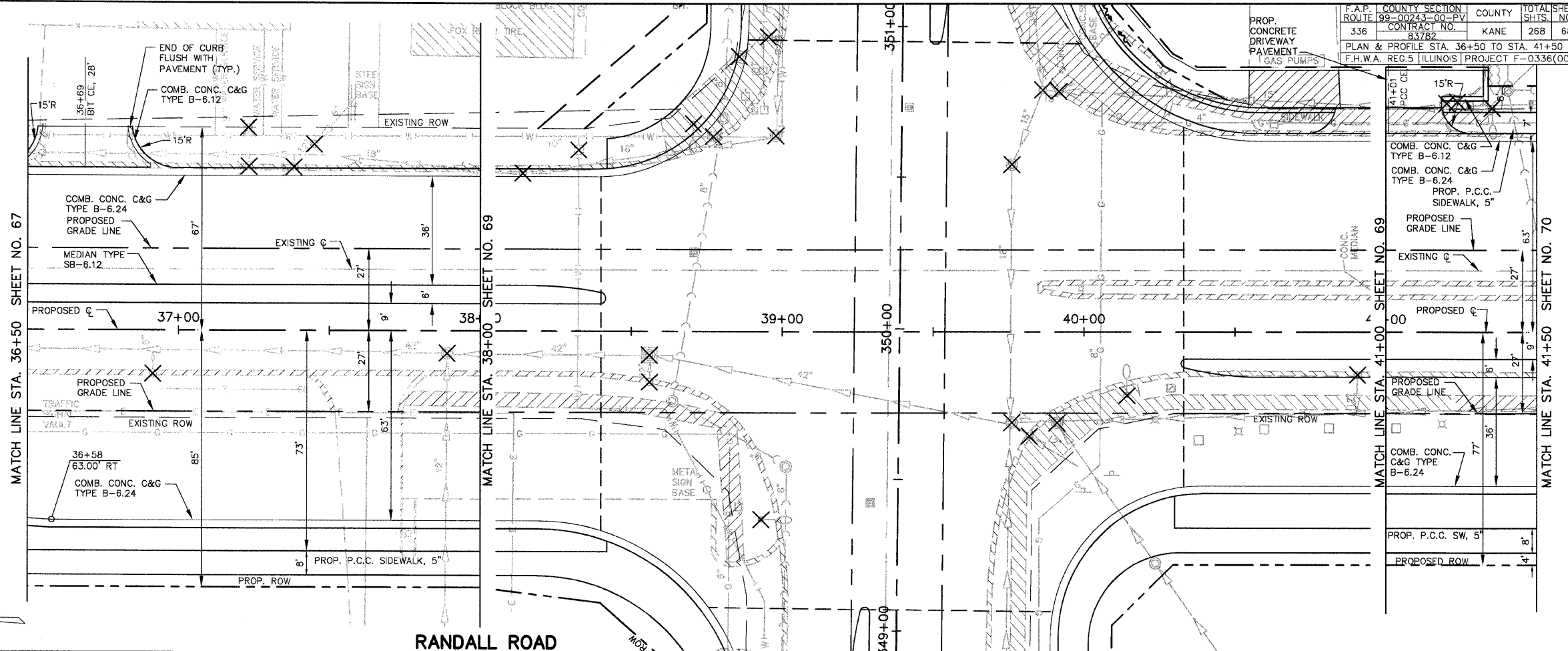

SCALE: 1" = 20'

**RANDALL ROAD**

