

F.A.P. ROUTE	COUNTY SECTION	COUNTY	TOTAL SHEET SHITS	NO.
336	99-00243-00-PV	KANE	268	132
CONTRACT NO. 83782				
TEMPORARY INTERCONNECT SCHEMATIC				
F.H.W.A. REG.5 ILLINOIS PROJECT F-0336(00B)				

TEMPORARY TRAFFIC SIGNAL INTERCONNECT SCHEDULE OF QUANTITIES

- 1 L. SUM MAINTAIN EXISTING TRAFFIC SIGNAL INTERCONNECT
- 3 EACH MAINTENANCE OF EXISTING TRAFFIC SIGNAL INSTALLATION

WIRELESS INTERCONNECT SCHEMATIC LEGEND

EXISTING	PROPOSED	
EMC	MC	MASTER CONTROLLER
⊠	⊠	INTERSECTION CONTROLLER
⊠ T	⊠ T	TEMPORARY CONTROLLER
◁	◁	SIGNAL HEAD
○	●	SIGNAL POST
○	●	MAST ARM ASSEMBLY AND POLE, STEEL
⊗ ^{E'}	⊗	TEMPORARY WOOD POLE
⊗ ^{E'}	⊗	YAGI ANTENNA (SHOWING DIRECTION TO BE INSTALLED)
⊗ ^{E'}	⊗	FIBER OPTIC CABLE IN CONDUIT, NO. 62.5/125, MM12F SM12
⊗	⊗	ELECTRIC CABLE, 1/C NO. 14
⊗	⊗	TELEPHONE CONNECTION

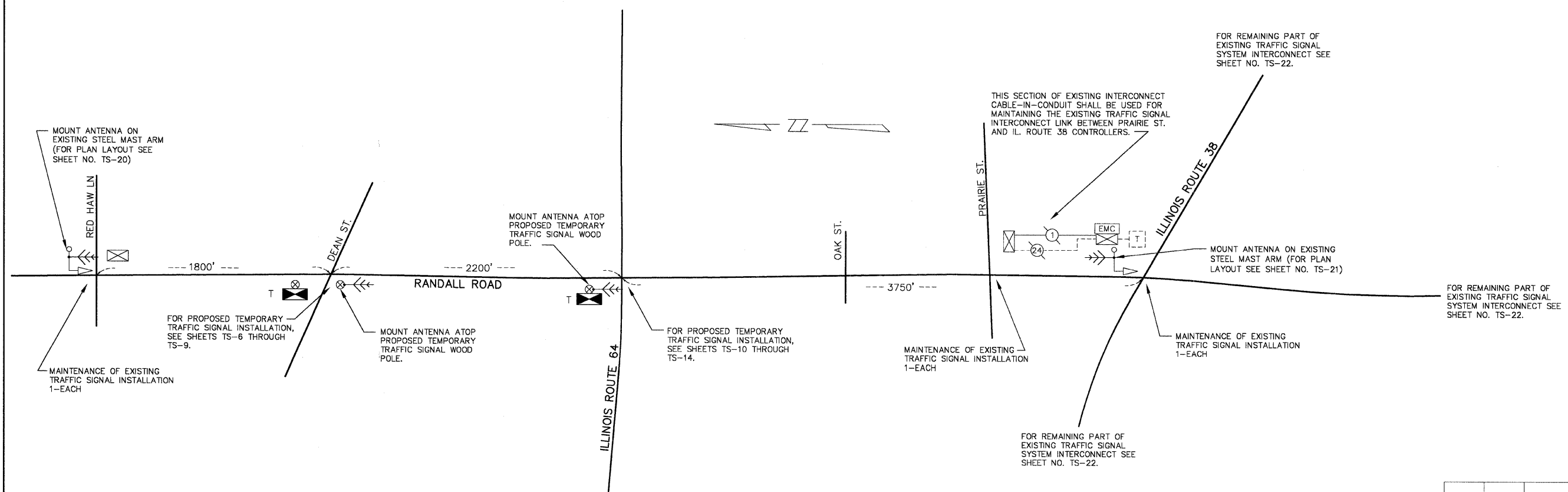

PROPOSED TEMPORARY TRAFFIC SIGNAL (WIRELESS) INTERCONNECT SCHEMATIC

THE TRAFFIC SIGNAL CONTROL EQUIPMENT FOR THIS PROJECT SHALL BE "EAGLE" TO MATCH THE EXISTING SYSTEM.

DIVISION OF TRANSPORTATION	
TEMPORARY TRAFFIC SIGNALS INTERCONNECT SCHEMATIC	
RANDALL ROAD (FROM RED HAW LANE TO IL. ROUTE 38)	
NAME	DATE
REVISIONS	
SCALE: NONE	DATE: SEPTEMBER 23, 2004
DRAWN BY: JMH	DESIGNED BY: DMH
CHECKED BY: JRL	