

F.A.P. ROUTE	COUNTY SECTION	COUNTY	TOTAL SHEET
336	99-00243-00-PV	KANE	268
CONTRACT NO. 83782			143
LIGHTING PLAN			
F.H.W.A. REG.5 ILLINOIS PROJECT F-0336(008)			

MATCH LINE STA. 353+50 SHEET NO. 145

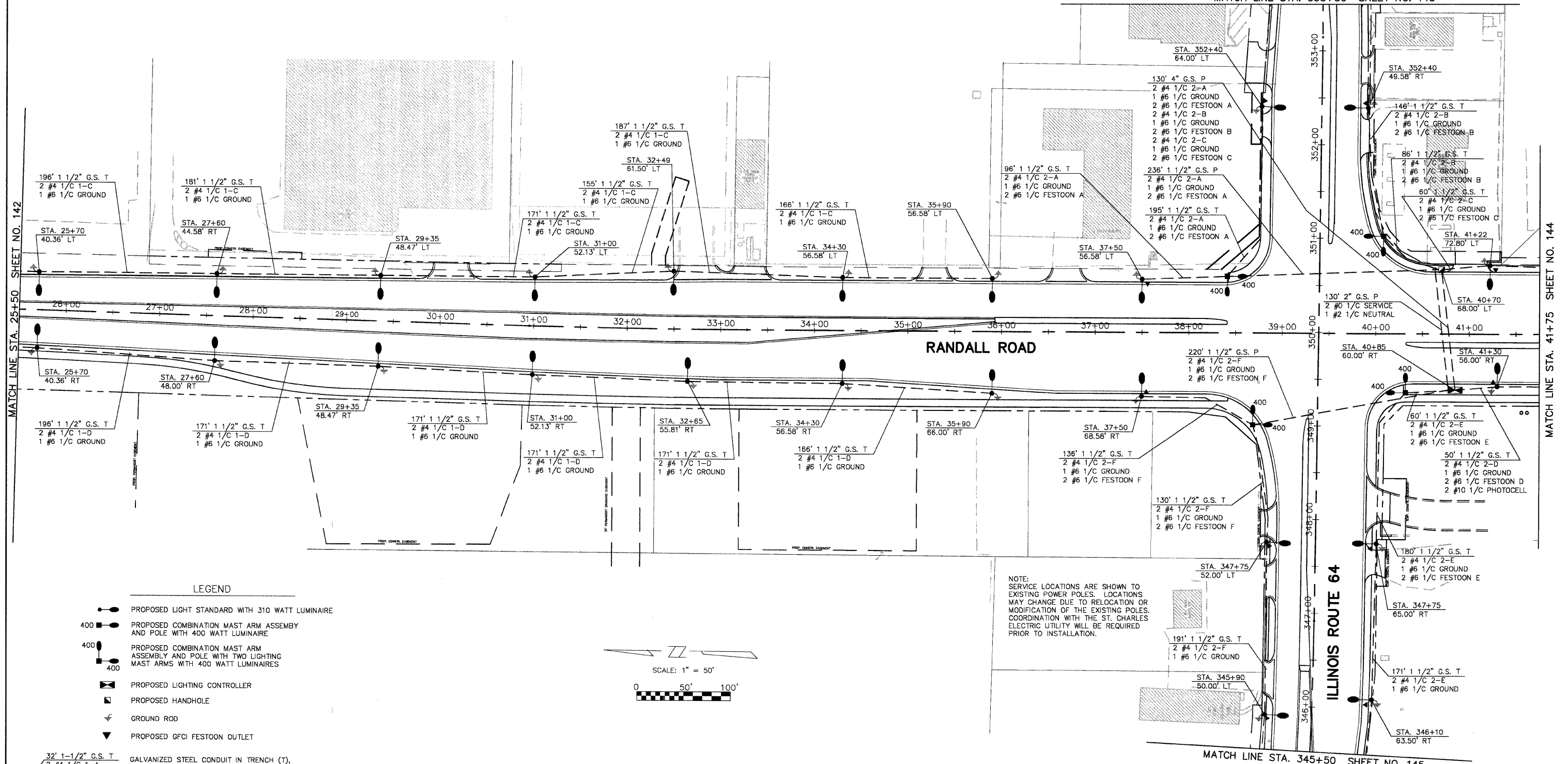

MATCH LINE STA. 25+50 SHEET NO. 142

MATCH LINE STA. 41+75 SHEET NO. 144

MATCH LINE STA. 345+50 SHEET NO. 145

LEGEND

- PROPOSED LIGHT STANDARD WITH 310 WATT LUMINAIRE
- PROPOSED COMBINATION MAST ARM ASSEMBLY AND POLE WITH 400 WATT LUMINAIRE
- PROPOSED COMBINATION MAST ARM ASSEMBLY AND POLE WITH TWO LIGHTING MAST ARMS WITH 400 WATT LUMINAIRES
- PROPOSED LIGHTING CONTROLLER
- PROPOSED HANDHOLE
- GROUND ROD
- PROPOSED GFCI FESTOON OUTLET
- GALVANIZED STEEL CONDUIT IN TRENCH (T), IN COMMON TRENCH (CT), EMBEDDED (EM), OR PUSHED (P) OF THE SIZE SPECIFIED WITH THE NUMBER AND SIZE OF CABLES SPECIFIED. CONDUIT LENGTHS INCLUDE 3 FEET OF VERTICAL CONDUIT AT EACH LIGHT STANDARD.
- EXISTING LIGHT STANDARD
- EXISTING LIGHT STANDARD TO BE REMOVED

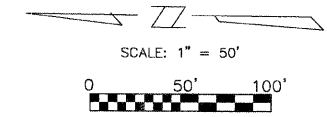

NOTE: SERVICE LOCATIONS ARE SHOWN TO EXISTING POWER POLES. LOCATIONS MAY CHANGE DUE TO RELOCATION OR MODIFICATION OF THE EXISTING POLES. COORDINATION WITH THE ST. CHARLES ELECTRIC UTILITY WILL BE REQUIRED PRIOR TO INSTALLATION.

REVISIONS	
NAME	DATE
PER BEC REVIEW	10-7-04
PER BEC REVIEW	12-29-04

STREET LIGHTING PLAN

STATION 25+50 TO 41+75

RANDALL ROAD

SCALE: AS SHOWN
 DATE: 5-26-04
 DRAWN BY: JMH
 CHECKED BY: DAY