

F.A.P. 1	COUNTY SECTION	COUNTY	TOTAL SHEET
ROUTE 336	99-00243-00-PV	KANE	SHITS. NO.
	CONTRACT NO.		268 196
	83782		
LANDSCAPING PLANS			
F.H.W.A. REG. 5 ILLINOIS PROJECT F-0336(008)			

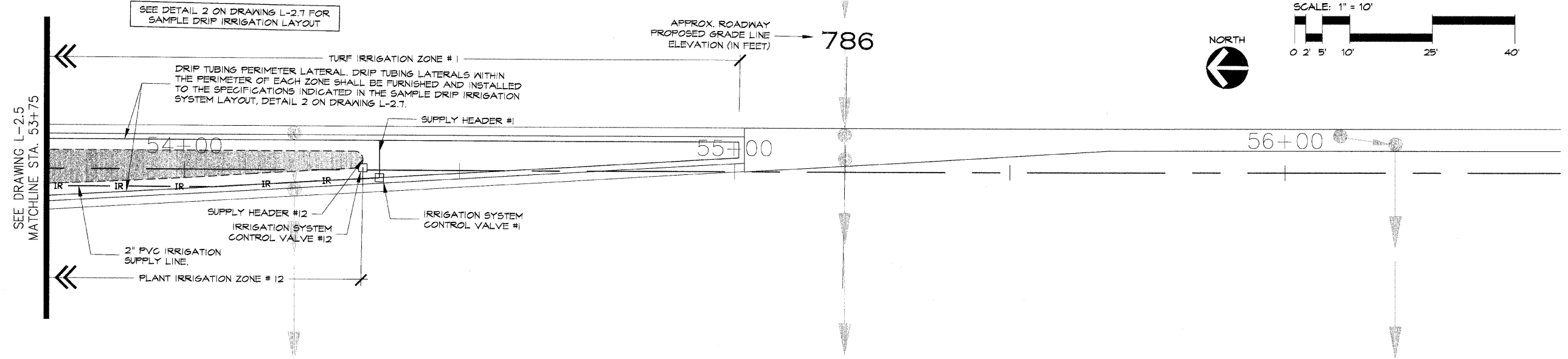

SEE DRAWING L-2.5  
MATCHLINE STA. 53+75

SEE DETAIL 2 ON DRAWING L-2.7 FOR  
SAMPLE DRIP IRRIGATION LAYOUT

APPROX. ROADWAY  
PROPOSED GRADE LINE  
ELEVATION (IN FEET) → 786

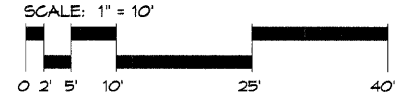

**MEDIAN PLANTER SEGMENT MP-3.05**

SCALE: 1" = 10'-0"

**HAYDEN  
BULIN LARSON**  
HAYDEN BULIN LARSON  
Design Group Ltd.  
750 North Franklin Street, Suite 205  
Chicago, Illinois 60610  
312.943.3234 FAX 312.943.3302

**RANDALL  
ROAD  
MEDIANS**  
City of St. Charles  
St. Charles, Illinois

HBL Submittal: Dec. 23, 2004  
HBL Project No.: 04-001.01  
CADD File: *h-irrigation.dwg*  
Drawn By: J.E.  
Approved By: J.E.  
Revisions:

**IRRIGATION  
PLANS**

Drawing	Sheet
L-2.6	196