

1 SCHEMATIC IRRIGATION SUPPLY SYSTEM DETAIL
No Scale

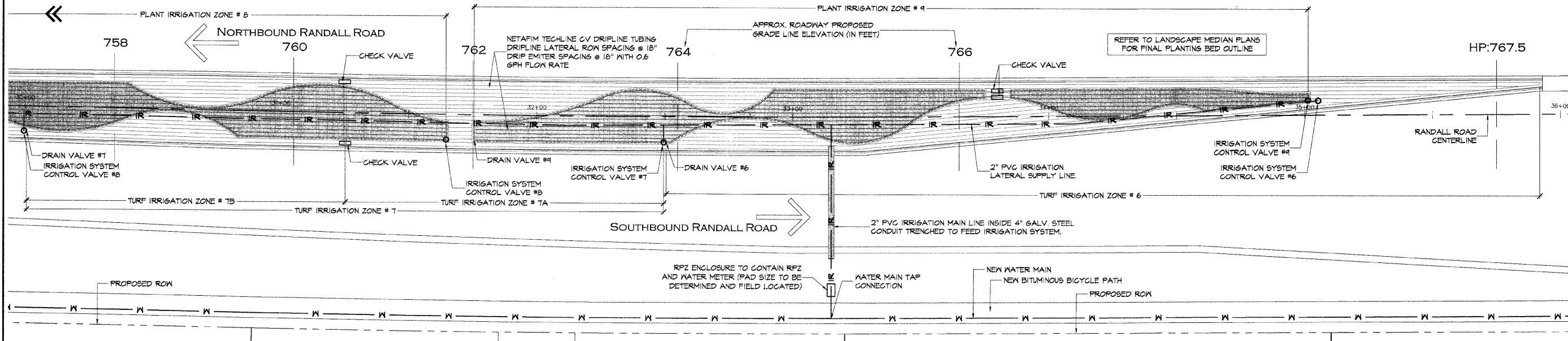

2 SCHEMATIC DRIP IRRIGATION LAYOUT
Scale: 1" = 10'-0"

- General Irrigation Notes
- BEFORE STARTING ANY EXCAVATION, THE CONTRACTOR SHALL CALL JULIE AT (800) 842-0123 FOR FIELD LOCATIONS OF BURIED UTILITIES INCLUDING ELECTRIC, TELEPHONE, AND GAS FACILITIES. (48 HOUR NOTIFICATION IS REQUIRED)
 - ALL STATIONS INDICATED ON PLANS ARE FROM THE PROPOSED RANDALL ROAD LAYOUT UNLESS OTHERWISE NOTED.
 - THE CONTRACTOR SHALL BE RESPONSIBLE FOR THE PROTECTION OF ANY UNDERGROUND OR ABOVE GROUND UTILITIES WITHIN THE PROJECT LIMITS WHETHER OR NOT THE UTILITIES ARE SHOWN ON THE PLANS. ANY UTILITY DAMAGED DURING CONSTRUCTION SHALL BE REPAIRED OR REPLACED BY THE CONTRACTOR AT HIS/HER OWN EXPENSE.
 - THE CONTRACTOR SHALL MAINTAIN PROPER AND ADEQUATE SURFACE DRAINAGE FOR THE ENTIRE LIMITS OF CONSTRUCTION THROUGHOUT THE ENTIRE CONSTRUCTION PERIOD.
 - THE CONTRACTOR SHALL PROTECT EXISTING AND NEW UTILITIES BY METHODS APPROVED BY THE ENGINEER. THE CONTRACTOR SHALL BRACE AND SUPPORT THE UTILITIES PROPERLY TO PREVENT SETTLEMENT, DISPLACEMENT OR CHANGE TO THE UTILITIES. THE PROTECTION OF THE UTILITIES AS SPECIFIED HEREIN WILL NOT BE PAID FOR SEPARATELY, BUT THE COST THEREOF SHALL BE CONSIDERED INCIDENTAL TO THE CONTRACT.
 - THE CONTRACTOR SHALL OBTAIN ALL NECESSARY PERMITS PRIOR TO COMMENCING CONSTRUCTION. THE COSTS SHALL BE CONSIDERED INCIDENTAL TO THE CONTRACT.
 - THE CONTRACTOR SHALL BE RESPONSIBLE FOR THE PROTECTION OF ANY EXISTING ITEMS NOT SCHEDULED TO BE ADJUSTED, RELOCATED, OR REMOVED INCLUDING CURBS, FENCES, PAVEMENTS, UTILITIES, AND EXISTING VEGETATION INTENDED TO REMAIN. ANY ITEMS DAMAGED DURING CONSTRUCTION SHALL BE REPAIRED OR REPLACED BY THE CONTRACTOR AT HIS/HER OWN EXPENSE.
 - THE CONTRACTOR SHALL COORDINATE WATER MAIN CONNECTIONS WITH THE CITY OF ST. CHARLES PUBLIC WORKS PRIOR TO THE BEGINNING OF CONSTRUCTION.
 - ALL GENERAL NOTES LISTED ON DRAWINGS AND WITHIN SPECIFICATIONS FOR THIS PROJECT ALSO APPLY.
 - IRRIGATION ITEMS SHOWN ARE DIAGRAMMATIC AND SHALL BE ADJUSTED BY THE CONTRACTOR TO ACCOMMODATE EXISTING AND PROPOSED CONDITIONS.
 - LANDSCAPE PLANT MATERIAL IS NOT SHOWN ON IRRIGATION PLANS. CONTRACTOR SHALL COORDINATE IRRIGATION PLANS WITH THE LANDSCAPE MEDIAN PLANS AND MAKE ADJUSTMENTS TO IRRIGATION ITEMS WHERE NEEDED TO ACCOMMODATE PROPOSED LANDSCAPE PLANTINGS.
 - IRRIGATION QUICK COUPLERS SHALL BE SPACED ON 100 FOOT CENTERS THROUGHOUT THE ENTIRE TURF IRRIGATION ZONE.
 - THE IRRIGATION CONTRACTOR SHALL COORDINATE WORK WITH ALL OTHER DISCIPLINES OF WORK AS DESCRIBED ON THE DRAWINGS AND AS OUTLINED IN THE SPECIFICATIONS AND PRIMARILY WITH THE LANDSCAPE SUBCONTRACTOR.

HAYDEN BULIN LARSON
Design Group Ltd.
750 North Franklin Street, Suite 205
Chicago, Illinois 60610
312.943.3234 FAX 312.943.3302

RANDALL ROAD MEDIANS
City of St. Charles
St. Charles, Illinois

HBL Submittal: Dec. 23, 2004
HBL Project No.: 04-001.01
CADD File: h-details.dwg
Drawn By: J.E.
Approved By: J.E.
Revisions:

IRRIGATION DETAILS

Drawing L-2.7 Sheet 197