

F.A.P.	COUNTY SECTION	COUNTY	TOTAL SHEET
ROUTE 99-00243-00-PV		KANE	268
336	CONTRACT NO. 83782		215
CROSS SECTION STA. 22+86 TO STA. 24+00			
F.H.W.A. REG.5 ILLINOIS PROJECT F-0336(008)			

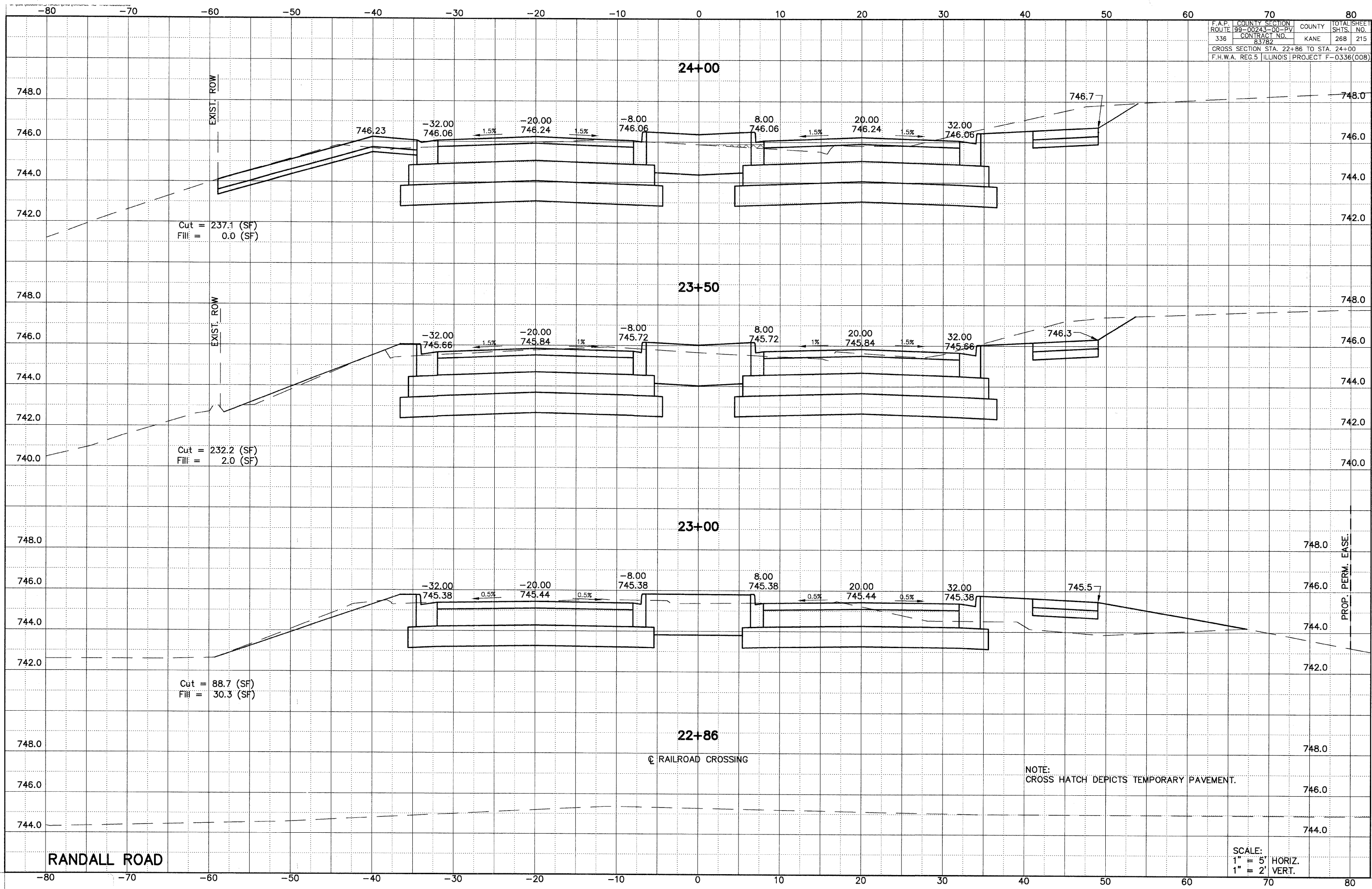

Cut = 237.1 (SF)
Fill = 0.0 (SF)

Cut = 232.2 (SF)
Fill = 2.0 (SF)

Cut = 88.7 (SF)
Fill = 30.3 (SF)

NOTE:
CROSS HATCH DEPICTS TEMPORARY PAVEMENT.

SCALE:
1" = 5' HORIZ.
1" = 2' VERT.

RANDALL ROAD

Ⓢ RAILROAD CROSSING

PROP. PERM. EASE