

F.A.P. COUNTY SECTION	ROUTE 99-00243-00-PV	COUNTY	TOTAL SHEET
336	CONTRACT NO. 83782	KANE	268
CROSS SECTION STA. 27+00 TO STA. 28+00			218
F.H.W.A. REG.5 ILLINOIS PROJECT F-0336(008)			

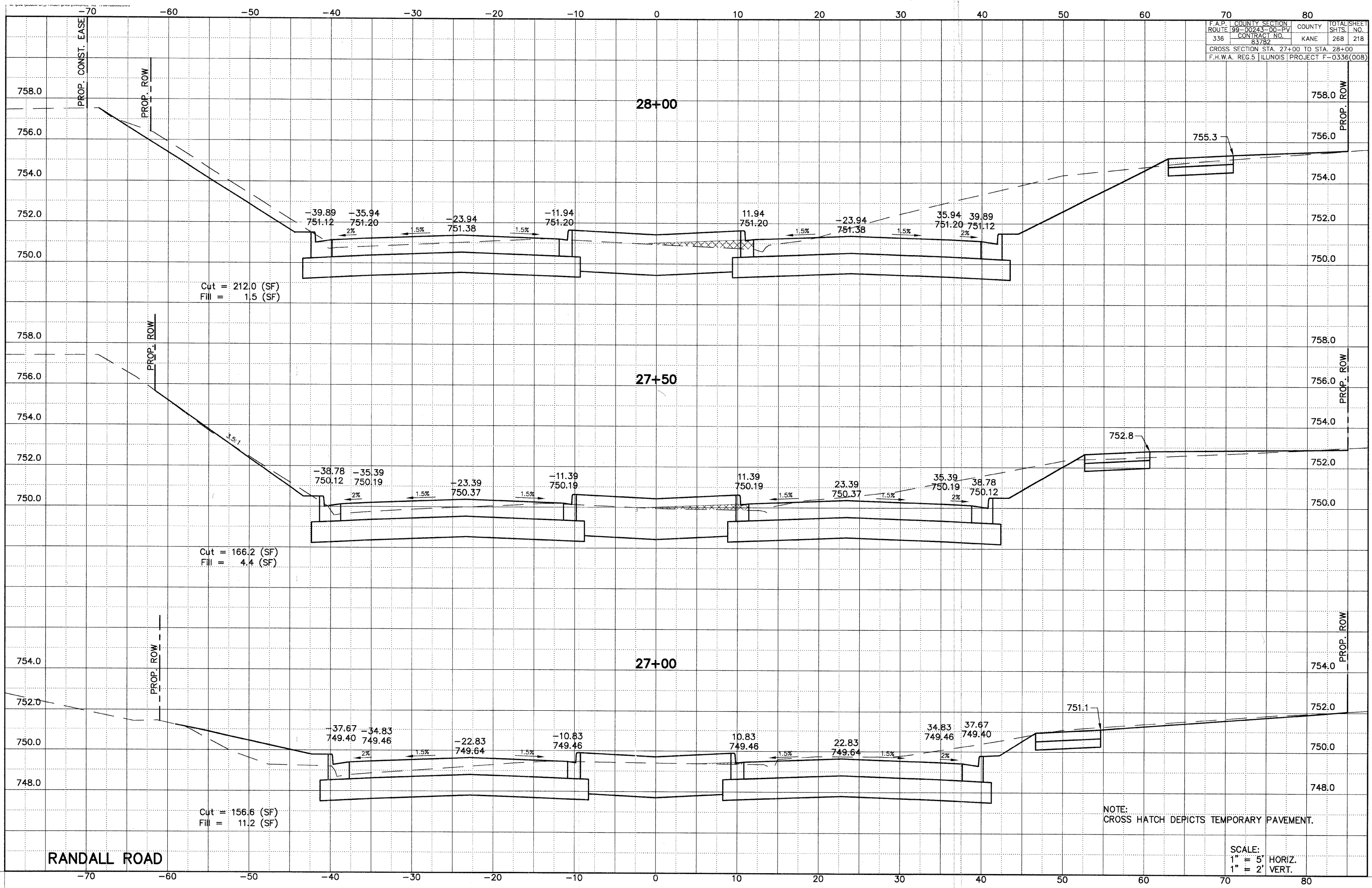

NOTE:  
CROSS HATCH DEPICTS TEMPORARY PAVEMENT.

SCALE:  
1" = 5' HORIZ.  
1" = 2' VERT.