

F.A.P. ROUTE	COUNTY SECTION	COUNTY	TOTAL SHEETS
336	99-00243-00-PV	KANE	268 222
CONTRACT NO. 83782			
CROSS SECTION STA. 32+73.1 TO STA. 33+50			
F.H.W.A. REG. 5 ILLINOIS PROJECT F-0336(00B)			

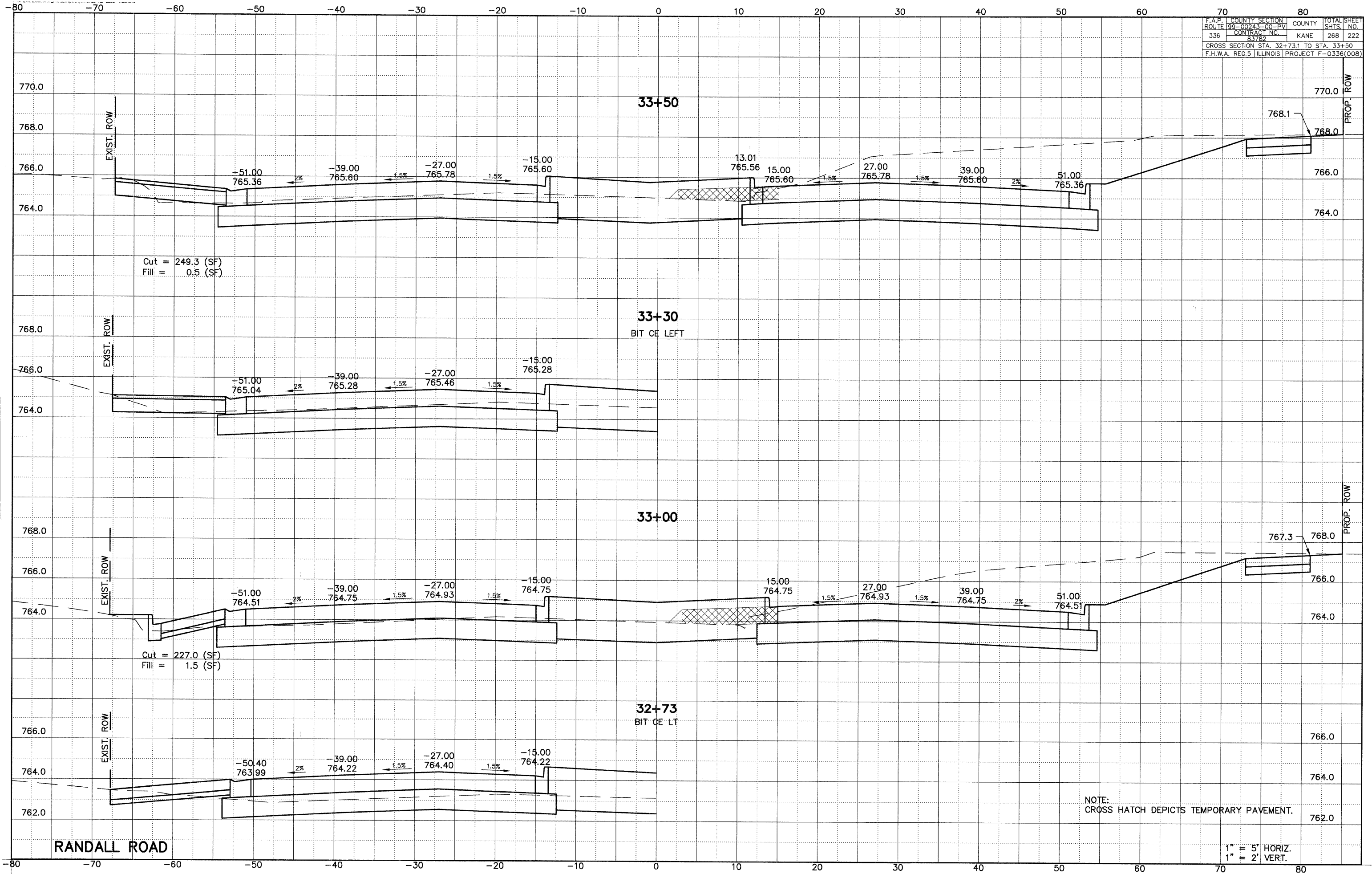

Cut = 249.3 (SF)
Fill = 0.5 (SF)

Cut = 227.0 (SF)
Fill = 1.5 (SF)

Cut = 227.0 (SF)
Fill = 1.5 (SF)

NOTE:
CROSS HATCH DEPICTS TEMPORARY PAVEMENT.

1" = 5' HORIZ.
1" = 2' VERT.

RANDALL ROAD