

F.A.P. ROUTE 336	COUNTY SECTION 98-00243-00-PV	COUNTY KANE	TOTAL SHEETS 268
	CONTRACT NO. 83782		SHTS. NO. 248
CROSS SECTION STA. 342+50 TO STA. 343+50			
F.H.W.A. REG. 5 ILLINOIS PROJECT F-0336(008)			

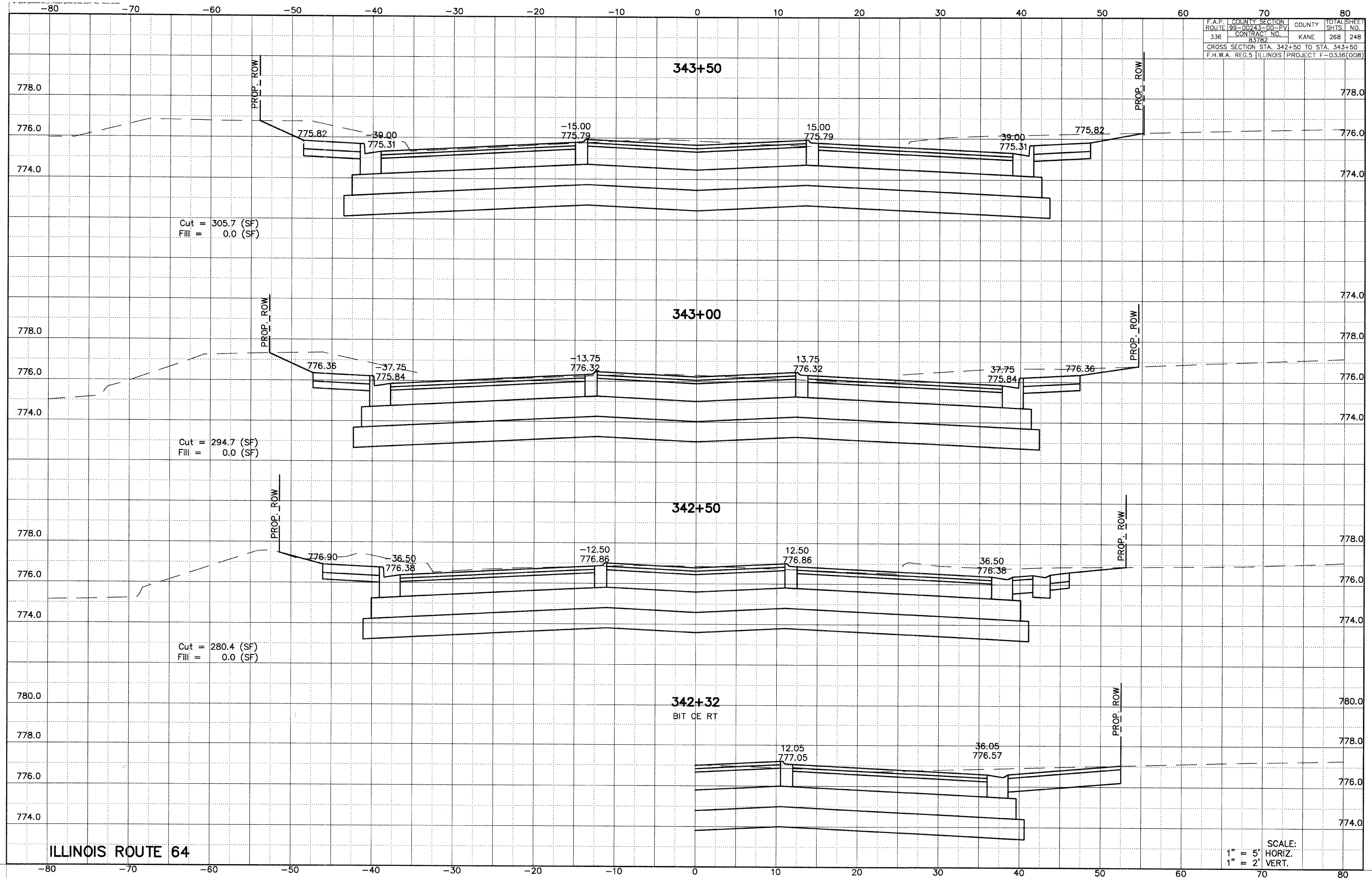

ILLINOIS ROUTE 64

SCALE:
1" = 5' HORIZ.
1" = 2' VERT.