

F.A.P. ROUTE	COUNTY	SECTION	COUNTY	TOTAL SHEETS
99-00243-00-PV	KANE			268
336		CONTRACT NO.		254
		83782		
CROSS SECTION STA. 351+00 TO STA. 352+09.6				
F.H.W.A. REG.5 ILLINOIS PROJECT F-0336(008)				

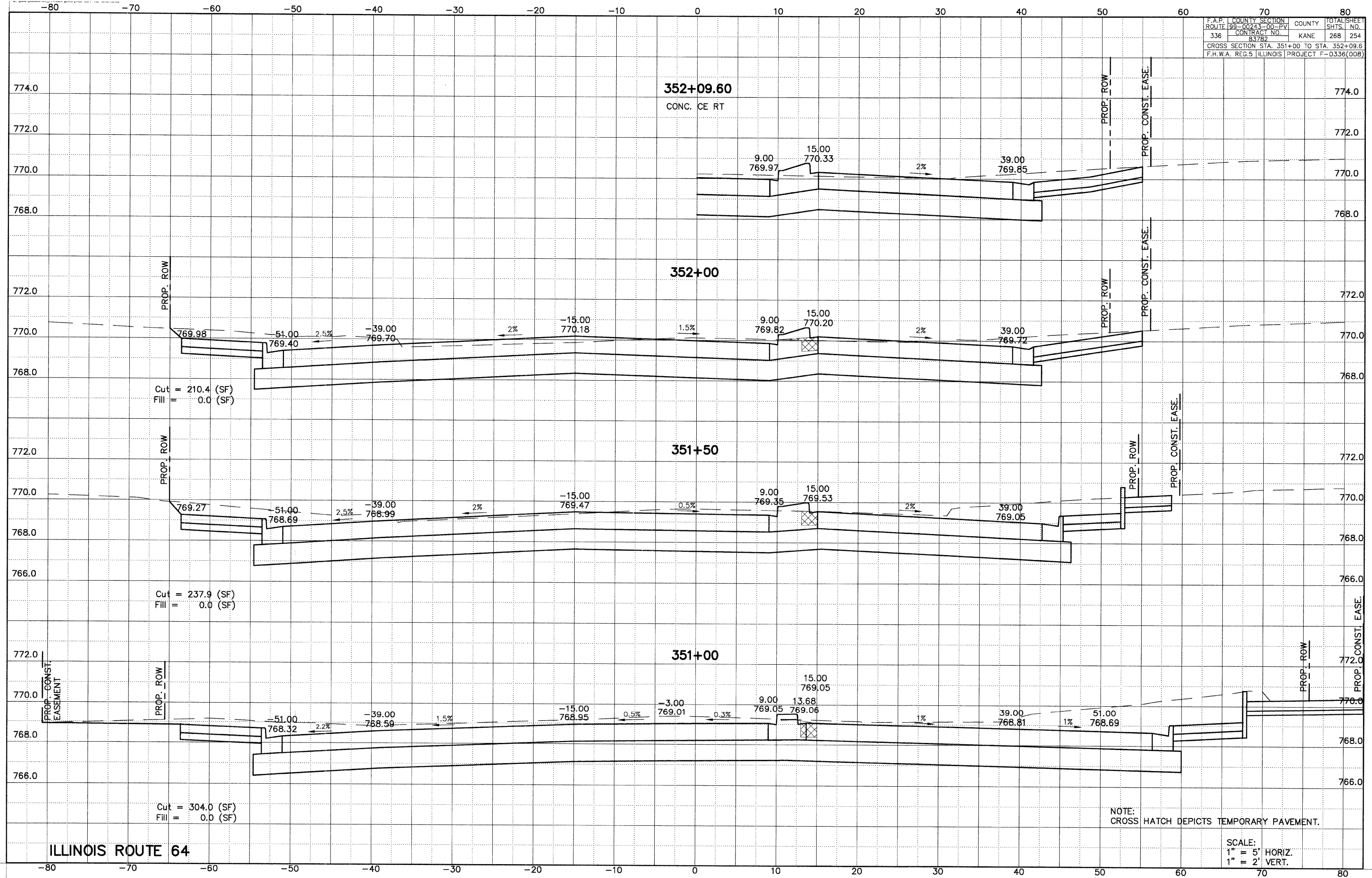

ILLINOIS ROUTE 64

NOTE:
CROSS HATCH DEPICTS TEMPORARY PAVEMENT.

SCALE:
1" = 5' HORIZ.
1" = 2' VERT.