

INDEX OF SHEETS
SHEET NO. DESCRIPTION

| | |
|---------|---|
| 1 | TITLE SHEET/INDEX |
| 2 | GENERAL NOTES |
| 3-6 | SUMMARY OF QUANTITIES |
| 7-14 | SCHEDULE OF QUANTITIES |
| 15-16 | EXISTING TYPICAL SECTIONS |
| 17-19 | PROPOSED TYPICAL SECTIONS |
| 20-23 | ALIGNMENT, TIES AND BENCHMARKS |
| 24-38 | STAGES OF CONSTRUCTION |
| 39-57 | PLAN AND PROFILE |
| 58-59 | INTERSECTION JOINTING PLAN |
| 60-78 | DRAINAGE AND UTILITIES |
| 79-82 | SIGNING, STRIPING AND LANDSCAPING PLANS |
| 83-110 | TRAFFIC SIGNAL PLANS |
| 111-132 | LIGHTING PLANS |
| 133-136 | SOIL EROSION AND SEDIMENT CONTROL |
| 137-160 | CROSS SECTIONS |
| 161-176 | CONSTRUCTION DETAILS |

IDOT STANDARDS REFERENCED

| NUMBER | DESCRIPTION |
|-----------|---|
| 000001-04 | STANDARD SYMBOLS, ABBREVIATIONS, & PATTERNS |
| 280001-02 | TEMPORARY EROSION CONTROL SYSTEMS |
| 420001-06 | PAVEMENT JOINTS |
| 420101-03 | 24" JOINTED PCC PAVEMENT |
| 420111-01 | PCC PAVEMENT ROUNDOUTS |
| 424001-04 | CURB RAMPS FOR SIDEWALKS |
| 482006-01 | BITUMINOUS SHOULDER ADJACENT TO RIGID PAVEMENT |
| 602001 | CATCH BASIN, TYPE A |
| 602011 | CATCH BASIN, TYPE C |
| 602401 | MANHOLE TYPE A |
| 602601 | PRECAST REINFORCED CONCRETE FLAT SLAB TOP |
| 602701 | CAST IRON STEPS |
| 604001-02 | FRAME AND LIDS, TYPE 1 |
| 604036-01 | GRATE, TYPE 8 |
| 604061-01 | FRAME AND GRATE, TYPE 12 |
| 604091-01 | FRAME AND GRATE, TYPE 24 |
| 606001-02 | CONCRETE CURB TYPE B AND COMBINATION CONCRETE CURB AND GUTTER |
| 606301-02 | PC CONCRETE ISLANDS AND MEDIANS |
| 606306-01 | CORRUGATED PC CONCRETE MEDIANS |
| 701301-02 | LANE CLOSURE, 2L 2W, SHORT TIME OPERATIONS |
| 701306-01 | LANE CLOSURE, 2L 2W, SLOW MOVING DAY ONLY OPERATIONS, FOR SPEEDS ≥ 45 MPH |
| 701326-02 | LANE CLOSURE, 2L 2W, PAVEMENT WIDENING, FOR SPEEDS ≥ 45 MPH |
| 701421-01 | LANE CLOSURE, MULTILANE, DAY OPERATIONS ONLY, FOR SPEEDS ≥ 45 MPH TO 55 MPH |
| 702001-05 | TRAFFIC CONTROL DEVICES |
| 720001 | SIGN PANEL MOUNTING DETAILS |
| 720006 | SIGN PANEL ERECTION DETAILS |
| 720011 | METAL POSTS FOR SIGNS, MARKERS, & DELINEATORS |
| 729001 | APPLICATION OF TYPES A & B METAL POSTS (FOR SIGNS AND MARKERS) |
| 780001-01 | TYPICAL PAVEMENT MARKINGS |

LAKE COUNTY STANDARDS REFERENCED

| NUMBER | DESCRIPTION |
|--------|--|
| LC1005 | TRIANGULAR SILT DIKE INSTALLATION FOR ROADWAY DITCH OR DRAINAGE DITCH |
| LC6005 | CURB & GUTTER TRANSITION (B-6.24) FOR 16' OFFSET |
| LC6009 | TRENCH WIDTHS FOR TRENCH BACKFILL AND PAVEMENT REPLACEMENT |
| LC6010 | SUBSURFACE DRAINS |
| LC7001 | TYPICAL APPLICATION OF TRAFFIC CONTROL DEVICES HIGHWAY CONSTRUCTION, CONTRACT MAINTENANCE |
| LC7002 | TYPICAL APPLICATION OF TRAFFIC CONTROL DEVICES HIGHWAY CONSTRUCTION, CONTRACT MAINTENANCE AND UTILITY OPERATIONS |
| LC7003 | TRAFFIC CONTROL AND PROTECTION FOR SIDE ROADS, INTERSECTIONS AND DRIVEWAYS |
| LC7004 | MULTILANE 2 WAY TRAFFIC, UNDIVIDED OR MULTILANE 2 WAY TRAFFIC DIVIDED WITH FLUSH MEDIAN, DAY OR NIGHT OPERATIONS |
| LC7005 | TYPICAL LANE CLOSURE 3 LANE ROAD SECTION |
| LC7006 | DIRECTION INDICATOR BARRICADES |
| LC7007 | TEMPORARY INFORMATION SIGNING FOR COMMERCIAL ENTRANCE |
| LC7008 | 2 LANE, 2 WAY, OFF-ROAD OPERATIONS, DAY ONLY OPERATIONS |
| - | TYPICAL PAVEMENT MARKINGS FOR COUNTY HIGHWAYS |

0 50' 100' - 1"=50'

0 50' 100' - 1"=20'

FULL SIZE PLANS HAVE BEEN PREPARED USING STANDARD ENGINEERING SCALES. REDUCED SIZE PLANS WILL NOT CONFORM TO STANDARD SCALES. WHEN MAKING MEASUREMENTS ON REDUCED PLANS, THE ABOVE SCALES MAY BE USED.

JOB NUMBER C-91-266-05
CONTRACT NUMBER 83807

STATE OF ILLINOIS
DEPARTMENT OF TRANSPORTATION
DIVISION OF HIGHWAYS

**PLANS FOR PROPOSED
FEDERAL AID HIGHWAY**

**DEERFIELD PARKWAY (IL ROUTE 83 TO WEILAND ROAD)
WIDENING, RECONSTRUCTION,
TRAFFIC SIGNALS, & LIGHTING
SECTION 03-00088-00-FP
PROJECT NO. M-8003(524)
VILLAGE OF BUFFALO GROVE
LAKE COUNTY**

IDOT STANDARDS REFERENCED (CONTD)

| NUMBER | DESCRIPTION |
|-----------|---|
| 805001 | ELECTRICAL SERVICE INSTALLATION DETAILS |
| 814001 | CONCRETE HANDHOLES |
| 814006 | DOUBLE HANDHOLES |
| 857001 | STANDARD PHASE DESIGNATION DIAGRAMS AND PHASE SEQUENCES |
| 877011-02 | STEEL COMBINATION MAST ARM ASSEMBLY AND POLE |
| 878001-03 | CONCRETE FOUNDATION DETAILS |
| 880001 | SPAN WIRE MOUNTED SIGNALS AND FLASHING BEACON INSTALLATION |
| 880006 | TRAFFIC SIGNAL MOUNTING DETAILS |
| BD-01 | DRIVEWAY DETAILS: DISTANCE BETWEEN R.O.W. AND FACE OF CURB/EDGE OF SHOULDER ≥ (15') |
| BD-07 | DETAIL OF STORM SEWER CONNECTION TO EXISTING SEWER |
| TC-11 | TYPICAL APPLICATIONS RAISED REFLECTIVE PAVEMENT MARKERS (SNOW-PLOW RESISTANT) |
| TC-14 | TRAFFIC CONTROL AND PROTECTION AT TURN BAYS (TO REMAIN OPEN TO TRAFFIC) |
| TC-16 | TEMPORARY PAVEMENT MARKING LETTERS AND SYMBOLS |
| TC-18 | SIGNING FOR FLAGGING OPERATIONS AT WORK ZONE OPENINGS |
| TC-22 | TEMPORARY INFORMATION SIGNING |
| TS-05 | DISTRICT ONE STANDARD TRAFFIC SIGNAL DESIGN DETAILS |
| - | MAST ARM MOUNTED STREET NAME SIGNS |
| - | VIDEO DETECTION DETAILS |

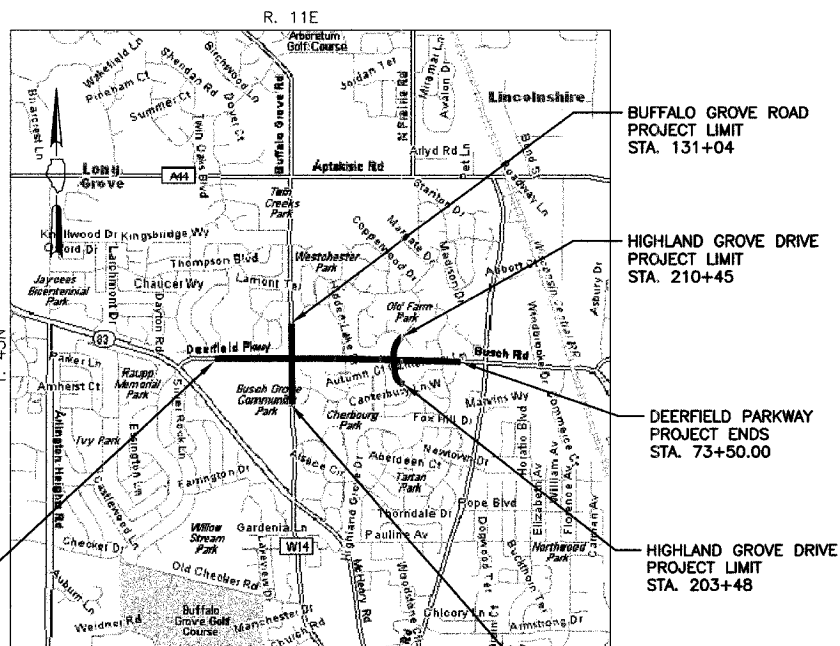

**LOCATION MAP
(NOT TO SCALE)**
DEERFIELD PARKWAY = 5,824.20 FT = 1.10 MILES
BUFFALO GROVE ROAD = 2,180 FT = 0.41 MILES
HIGHLAND GROVE DRIVE = 697 FT = 0.13 MILES
GROSS & NET PROJECT LENGTH = 8,701.20 FT = 1.65 MILES

DESIGN DESIGNATIONS

POSTED SPEED 35 M.P.H. / DESIGN SPEED 45 M.P.H. /
ADT 17,200 (2001) 25,000 (2020)

DEERFIELD PARKWAY (ILLINOIS ROUTE 83 TO BUFFALO GROVE ROAD)
- 1720 (20) • COLLECTOR • 1.71 (AC-20)

DEERFIELD PARKWAY (BUFFALO GROVE ROAD TO HIGHLAND GROVE DRIVE)
- 2345 (20) • COLLECTOR • 1.71 (AC-20)

DEERFIELD PARKWAY (HIGHLAND GROVE DRIVE TO WEILAND ROAD)
- 2260 (20) • COLLECTOR • 1.71 (AC-20)

| | | | | |
|-----------------------|---------|------------------------------|--------------|-----------|
| RTE# | SECTION | COUNTY | TOTAL SHEETS | SHEET NO. |
| CH | A47 | LAKE | 176 | 1 |
| SECTION NUMBER | | 03-00088-00-FP | | |
| FED. ROAD DIST. NO. 7 | | FED. AID PROJECT M-8003(524) | | |

JOB NUMBER C-91-266-05 CONTRACT NUMBER 83807

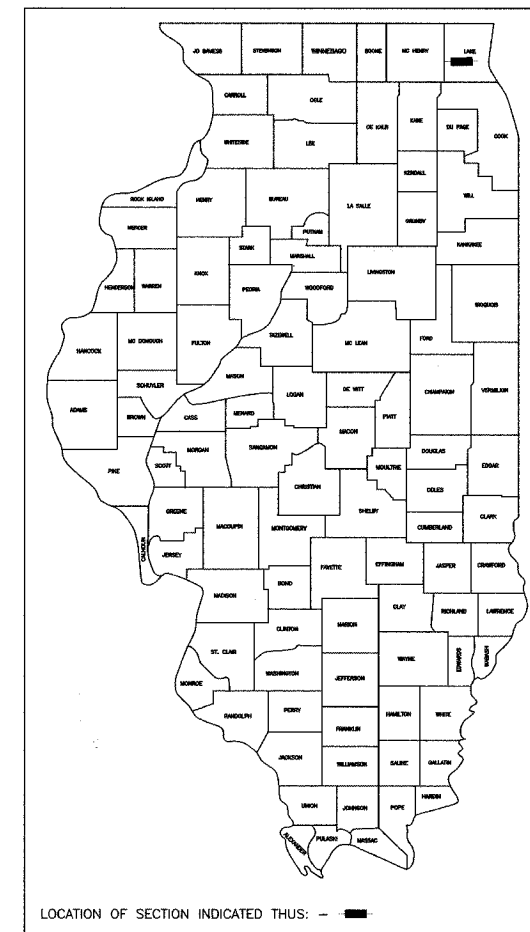

LOCATION OF SECTION INDICATED THUS: -

FOR UNDERGROUND UTILITY LOCATIONS

Call Before You Dig

1-800-4-A-DIG

ILLINOIS ONE-CALL SYSTEM

(800) 892-0123

LAKE COUNTY PUBLIC WORKS
(847) 680-1600

VILLAGE OF BUFFALO GROVE PUBLIC WORKS
(847) 459-2523

P.E. SIGNATURE: *Joseph J. Emry*

P.E. NAME: JOSEPH J. EMRY

DATE: 6/2/2005

IL LICENSE NO.: 062-057496

LICENSE EXPIRATION: 11/30/2005

P.E. SIGNATURE: *M. Anees Rahman*

P.E. NAME: M. ANEES RAHMAN

DATE: 6/2/2005

IL LICENSE NO.: 62-056318

LICENSE EXPIRATION: 11/30/2005

CIVILTECH ENGINEERING, INC.

104-050266
LAKEVIEW CORPORATION

ILLINOIS

CORPORATE SEAL

P.E. SIGNATURE: *Reid T. Magner*

P.E. NAME: REID T. MAGNER

DATE: 6/2/2005

IL LICENSE NO.: 062-056273

LICENSE EXPIRATION: 11/30/2005

STATE OF ILLINOIS
DEPARTMENT OF TRANSPORTATION
DIVISION OF HIGHWAYS

PASSED *June 5, 2005*

BUREAU CHIEF OF LOCAL ROADS AND STREETS

APPROVED *June 6, 2005*

DEPUTY DIRECTOR OF HIGHWAYS, REGION ENGINEER

APPROVED *June 1, 2005*

GREGORY P. BOYSEN, P.E.
DIRECTOR OF PUBLIC WORKS

PLANS PREPARED BY:

CIVILTECH

450 E Devon Ave, Suite 300 - Itasca, Illinois 60143
Tel: 630.773.3900 - Fax: 630.773.3975
www.civiltechinc.com

Burns & McDonnell
SINCE 1898

PRINTED BY THE AUTHORITY OF THE STATE OF ILLINOIS

BID SET

FEDERAL AID DESIGN ENGINEER: MS. JESSICA A. MILLER (847) 705-4487