

HIGHLAND GROVE DRIVE
MATCH LINE STA. 208+00 (SEE SHEET NO. 57)

FILE #	SECTION	COUNTY	TOTAL SHEETS	SHEET NO.
CH	A47	LAKE	176	48
STA.	57+00	TO STA.	62+25	
03-00088-00-PP	ELIMB	SURFACE TRANSPORTATION FUNDING		
CONTRACT NUMBER 83807				

CURVE #2
 $\Delta = 04'35''08''$
 $D = 00'24''01''$
 $R = 14,317.07'$
 $T = 573.23'$
 $L = 1145.85'$
 $E = 11.47'$
 $PC STA. = 60+41.56$
 $PI STA. = 66+14.80$
 $PT STA. = 71+87.41$

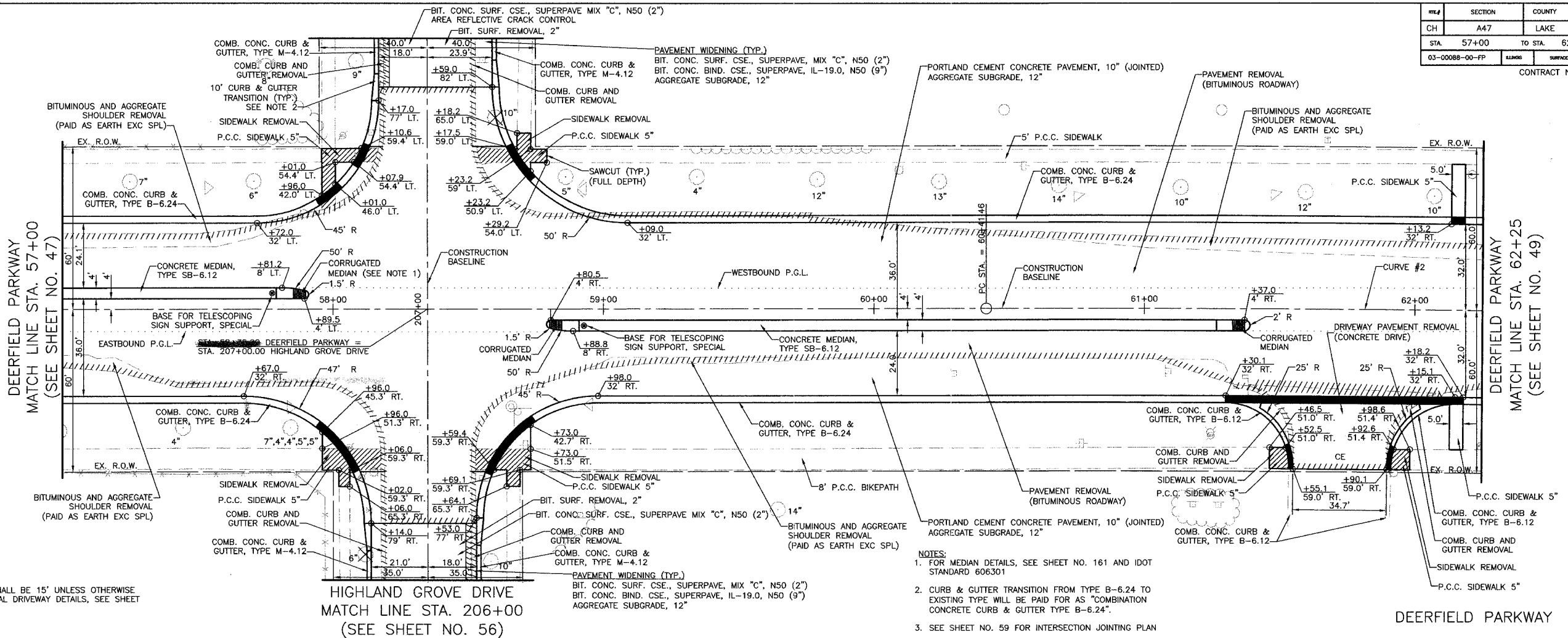

GENERAL NOTE:
 ALL DRIVEWAY RADII SHALL BE 15' UNLESS OTHERWISE NOTED. FOR ADDITIONAL DRIVEWAY DETAILS, SEE SHEET 168.

- NOTES:
- FOR MEDIAN DETAILS, SEE SHEET NO. 161 AND IDOT STANDARD 606301
 - CURB & GUTTER TRANSITION FROM TYPE B-6.24 TO EXISTING TYPE WILL BE PAID FOR AS "COMBINATION CONCRETE CURB & GUTTER TYPE B-6.24".
 - SEE SHEET NO. 59 FOR INTERSECTION JOINTING PLAN

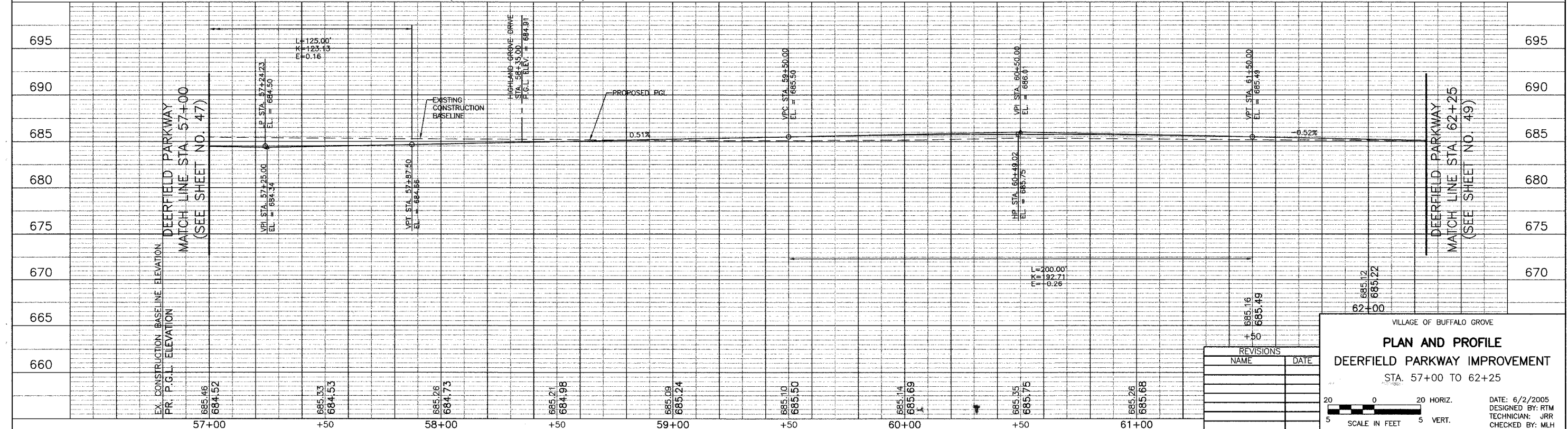

REVISIONS	
NAME	DATE

VILLAGE OF BUFFALO GROVE
PLAN AND PROFILE
DEERFIELD PARKWAY IMPROVEMENT
 STA. 57+00 TO 62+25

DATE: 6/2/2005
 DESIGNED BY: RTM
 TECHNICIAN: JRR
 CHECKED BY: MLH

20 0 20 HORIZ.
 5 SCALE IN FEET 5 VERT.

BID SET