

PROJECT	SECTION	COUNTY	TOTAL SHEETS	SHEET NO.
CH	A47	LAKE	176	69
STA. 57+00		TO STA. 62+25		
03-00088-00-FP		SURFACE TRANSPORTATION FUNDING		
CONTRACT NUMBER 83807				

119 STA. 57+14, 32' RT. CB TY C W/T-24 F&G RIM EL = 684.02 INV EL = 680.56 (E)	120 STA. 57+24.23, 32' RT. RD CB TY A, 4' DIA. W/T-24 F&G RIM EL = 684.02 INV EL = 680.52 (W) INV EL = 680.42 (N)	121 STA. 59+14, 32' RT. CB TY C W/T-24 F&G RIM EL = 684.83 INV EL = 680.83 (N)	MATCH LINE STA. 208+00 (SEE SHEET NO. 78)	122 STA. 61+18, 42' RT. CB TY C W/T-8 GRATE RIM EL = 683.60 INV EL = 679.60 (NE)	123 STA. 61+25, 32' RT. CB TY A, 4' DIA. W/T-24 F&G RIM EL = 685.12 INV EL = 679.57 (SW) INV EL = 678.58 (N)	124 STA. 57+14, 32' LT. CB TY C W/T-24 F&G RIM EL = 684.02 INV EL = 680.14 (E)	125 STA. 57+24.23, 32' LT. RD CB TY A, 4' DIA. W/T-24 F&G RIM EL = 684.02 INV EL = 680.10 (W) INV EL = 680.10 (S) INV EL = 680.00 (NE)	126 STA. 57+28, 39' LT. RD MH TY A, 5' DIA. W/T-1F CL RIM EL = 684.65 INV EL = 679.19 (W) INV EL = 679.99 (SW) INV EL = 679.09 (E)	127 STA. 59+14, 32' LT. RD CB TY A, 4' DIA. W/T-24 F&G RIM EL = 684.83 INV EL = 680.51 (S) INV EL = 679.16 (NE)
--	--	--	---	--	---	--	--	--	--

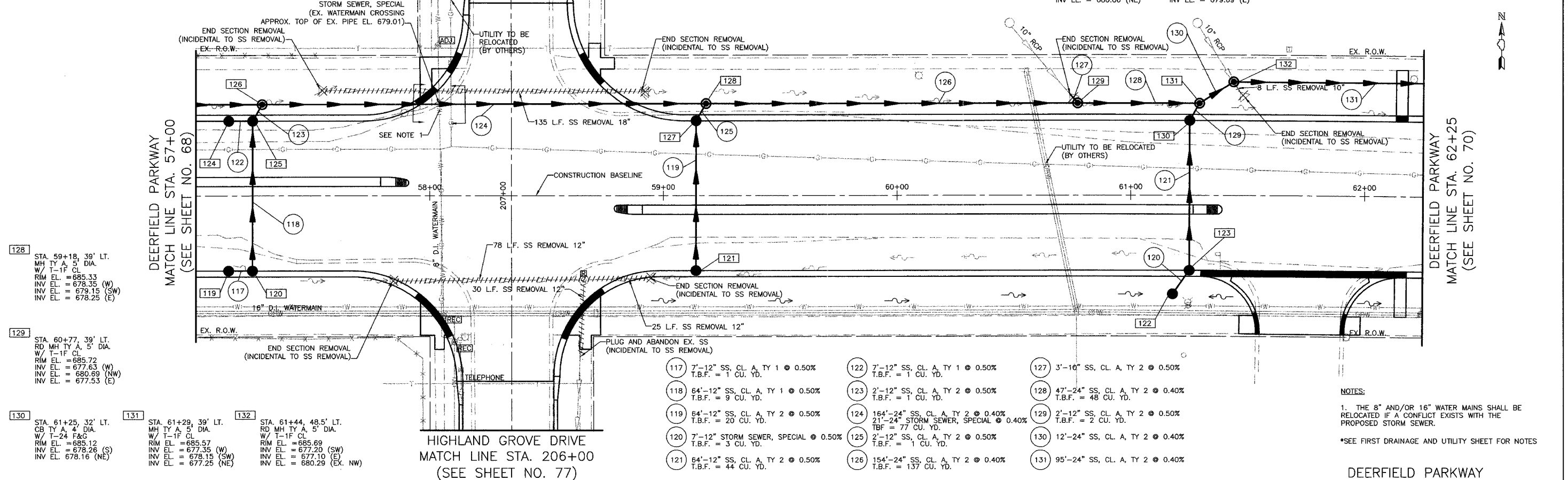

128 STA. 59+18, 39' LT. MH TY A, 5' DIA. W/T-1F CL RIM EL = 685.33 INV EL = 678.35 (W) INV EL = 679.15 (SW) INV EL = 678.25 (E)	129 STA. 60+77, 39' LT. RD MH TY A, 5' DIA. W/T-1F CL RIM EL = 685.72 INV EL = 677.63 (W) INV EL = 680.89 (NW) INV EL = 677.53 (E)	130 STA. 61+25, 32' LT. CB TY A, 4' DIA. W/T-24 F&G RIM EL = 685.12 INV EL = 678.26 (S) INV EL = 678.16 (NE)	131 STA. 61+29, 39' LT. MH TY A, 5' DIA. W/T-1F CL RIM EL = 685.57 INV EL = 677.35 (W) INV EL = 678.15 (SW) INV EL = 677.25 (NE)	132 STA. 61+44, 48.5' LT. RD MH TY A, 5' DIA. W/T-1F CL RIM EL = 685.69 INV EL = 677.20 (SW) INV EL = 677.10 (E) INV EL = 680.29 (EX. NW)
---	--	---	--	---

117 7'-12" SS, CL. A, TY 1 @ 0.50% T.B.F. = 1 CU. YD.	122 7'-12" SS, CL. A, TY 1 @ 0.50% T.B.F. = 1 CU. YD.	127 3'-10" SS, CL. A, TY 2 @ 0.50%
118 64'-12" SS, CL. A, TY 1 @ 0.50% T.B.F. = 9 CU. YD.	123 2'-12" SS, CL. A, TY 2 @ 0.50% T.B.F. = 1 CU. YD.	128 47'-24" SS, CL. A, TY 2 @ 0.40% T.B.F. = 48 CU. YD.
119 64'-12" SS, CL. A, TY 2 @ 0.50% T.B.F. = 20 CU. YD.	124 164'-24" SS, CL. A, TY 2 @ 0.40% 21'-24" STORM SEWER, SPECIAL @ 0.40% T.B.F. = 77 CU. YD.	129 2'-12" SS, CL. A, TY 2 @ 0.50% T.B.F. = 2 CU. YD.
120 7'-12" STORM SEWER, SPECIAL @ 0.50% T.B.F. = 3 CU. YD.	125 2'-12" SS, CL. A, TY 2 @ 0.50% T.B.F. = 1 CU. YD.	130 12'-24" SS, CL. A, TY 2 @ 0.40%
121 64'-12" SS, CL. A, TY 2 @ 0.50% T.B.F. = 44 CU. YD.	126 154'-24" SS, CL. A, TY 2 @ 0.40% T.B.F. = 137 CU. YD.	131 95'-24" SS, CL. A, TY 2 @ 0.40%

NOTES:
1. THE 8" AND/OR 16" WATER MAINS SHALL BE RELOCATED IF A CONFLICT EXISTS WITH THE PROPOSED STORM SEWER.
*SEE FIRST DRAINAGE AND UTILITY SHEET FOR NOTES

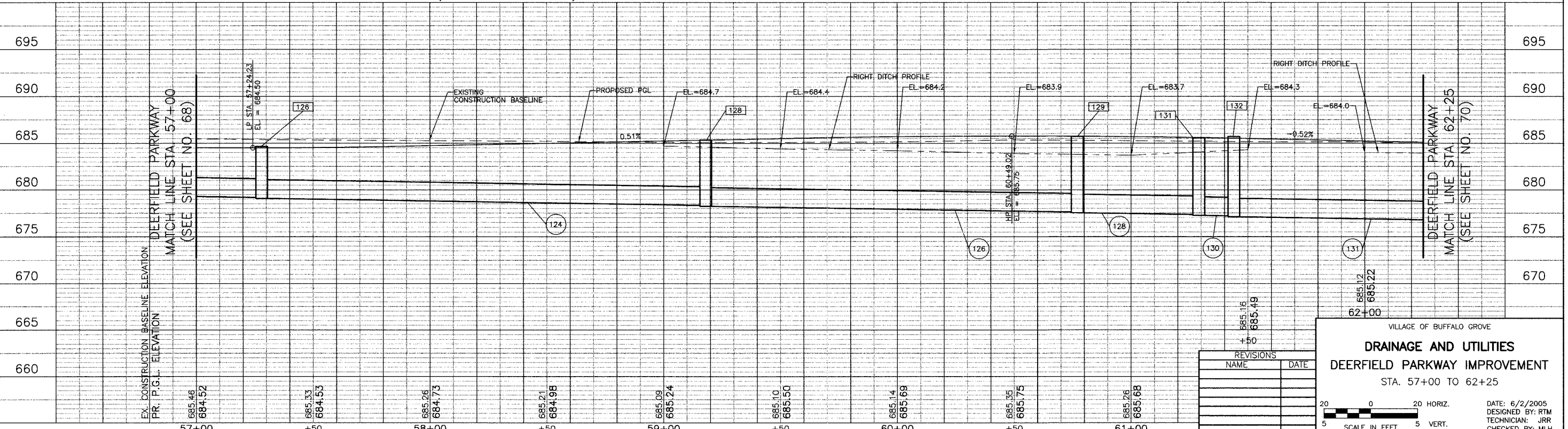

REVISIONS	
NAME	DATE

VILLAGE OF BUFFALO GROVE
DRAINAGE AND UTILITIES
DEERFIELD PARKWAY IMPROVEMENT
STA. 57+00 TO 62+25

DATE: 6/2/2005
DESIGNED BY: RTM
TECHNICIAN: JRR
CHECKED BY: MLH

20 0 20 HORIZ.
5 5 VERT.
SCALE IN FEET