

SHEET NO.	SECTION	COUNTY	TOTAL SHEETS	SHEET NO.
CH	A47	LAKE	176	116
STA.	33+00	TO STA.	38+00	
03-00088-00-PP	ILLINOIS	SURFACE TRANSPORTATION FUNDING		

CONTRACT NUMBER 83807

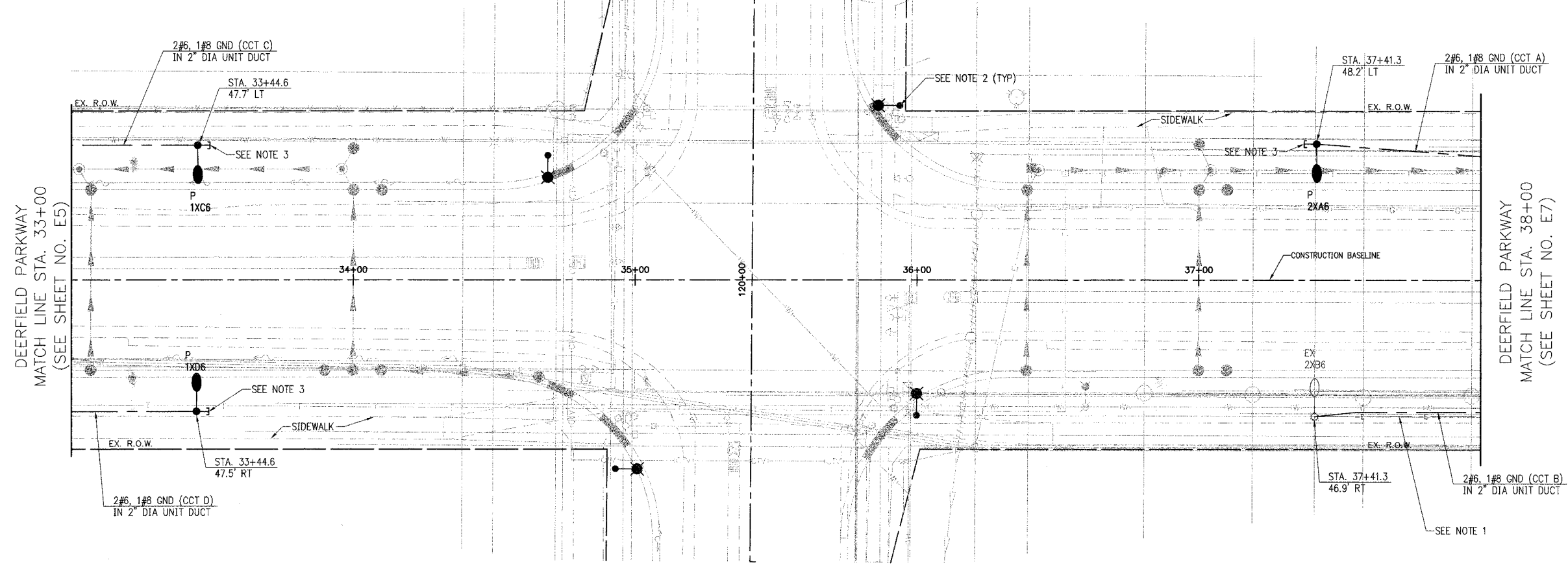

BUFFALO GROVE ROAD
MATCH LINE STA. 121+00 (SEE SHEET NO. E15)



NOTES:

1. LOCATION OF EXISTING WIRING IS APPROXIMATE. EXACT LOCATION AND SOURCE SHALL BE FIELD DETERMINED. CONTRACTOR SHALL DISCONNECT EXISTING WIRING AT THE SOURCE AND ABANDON IN PLACE.
2. COMBINATION TRAFFIC SIGNAL LIGHT POLE. SEE TRAFFIC SIGNAL PLANS (SHEET 88) FOR INSTALLATION DETAILS. CONTRACTOR SHALL INSTALL WIRING AND CONDUIT AS SHOWN ON SIGNAL PLANS. INTERSECTION LIGHTING WILL BE CONNECTED TO THE TRAFFIC SIGNAL CONTROLLER AND WILL BE OPERATED AND MAINTAINED BY LAKE COUNTY. ALL OTHER LIGHTING WILL BE OPERATED AND MAINTAINED BY THE VILLAGE OF BUFFALO GROVE.
3. CONTRACTOR SHALL STUB AND CAP 2" RGC CONDUIT 2'-0" BEYOND LIGHT POLE FOUNDATION FOR FUTURE USE.

E6 OF E22

VILLAGE OF BUFFALO GROVE

LIGHTING PLANS

DEERFIELD PARKWAY IMPROVEMENT

STA. 33+00 TO 38+00

DATE: 6/2/2005
DESIGNED BY: CMW
TECHNICIAN: LRS
CHECKED BY: MAR

SCALE IN FEET



REVISIONS	
NAME	DATE