

FILE#	SECTION	COUNTY	TOTAL SHEETS	SHEET NO
CH	A47	LAKE	176	128
STA	208+00	TO STA	210+50	
03-00088-00-FP		ILLINOIS	SURFACE TRANSPORTATION FUNDING	
CONTRACT NUMBER 83807				

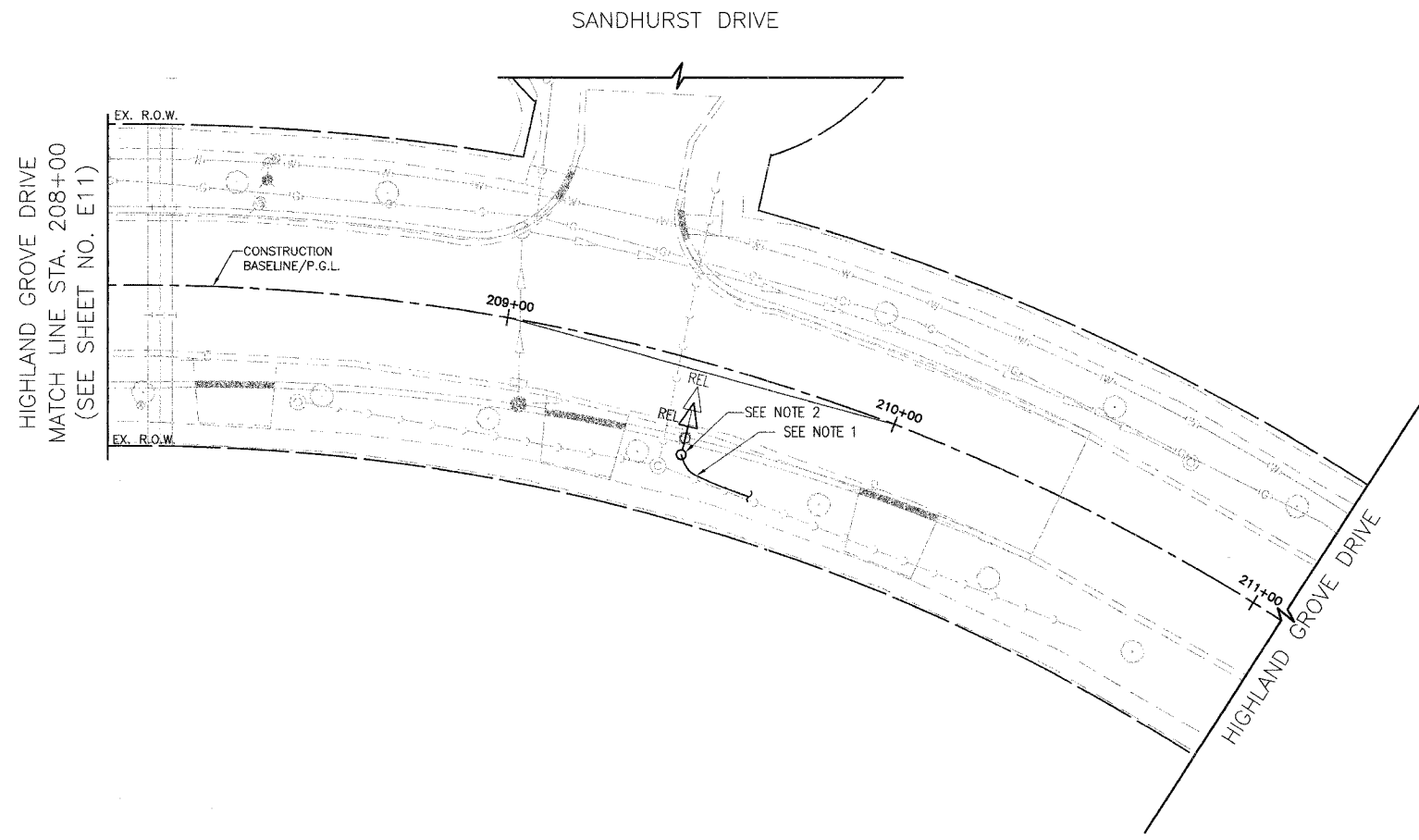
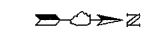

HIGHLAND GROVE DRIVE  
MATCH LINE STA. 208+00  
(SEE SHEET NO. E11)

- NOTE:**
1. LOCATION OF EXISTING WIRING IS APPROXIMATE. EXACT LOCATION AND SOURCE SHALL BE FIELD DETERMINED.
  2. CONTRACTOR SHALL DISCONNECT EXISTING WIRING AT THE SOURCE, LOCATE EXISTING WIRING, AND TERMINATE EXISTING WIRING IN THE RELOCATED POLE.

E18 OF E22



REVISIONS	
NAME	DATE

VILLAGE OF BUFFALO GROVE

**LIGHTING PLANS**

HIGHLAND GROVE DRIVE IMPROVEMENT

STA. 208+00 TO 210+50

SCALE 1" = 20'

DATE: 6/2/2005  
DESIGNED BY: CMW  
TECHNICIAN: EJB  
CHECKED BY: MAR