

RT #	SECTION	COUNTY	TOTAL SHEETS	SHEET NO.
CH	A47	LAKE	176	167
83807				

TYPICAL RAIL ROAD RELATED PAVEMENT MARKINGS

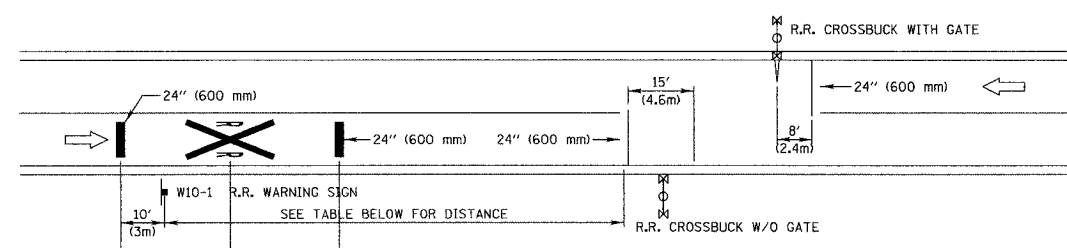

DISTANCE FOR W10-1 R.R. WARNING SIGN

POSTED SPEED LIMIT	DISTANCE FROM STOP BAR
30 MPH	325' (100m)
35 MPH	400' (125m)
40 MPH	475' (145m)
45 MPH	550' (165m)
50 MPH	625' (190m)
55 MPH	700' (215m)

NOTE: SUPPLEMENTAL R.R. PAVEMENT MARKINGS MAY BE ADDED AT THE DISCRETION OF THE COUNTY TRAFFIC ENGINEER.

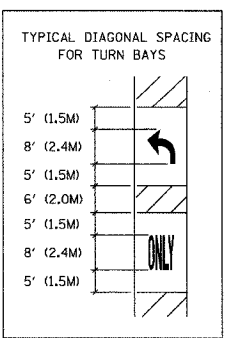
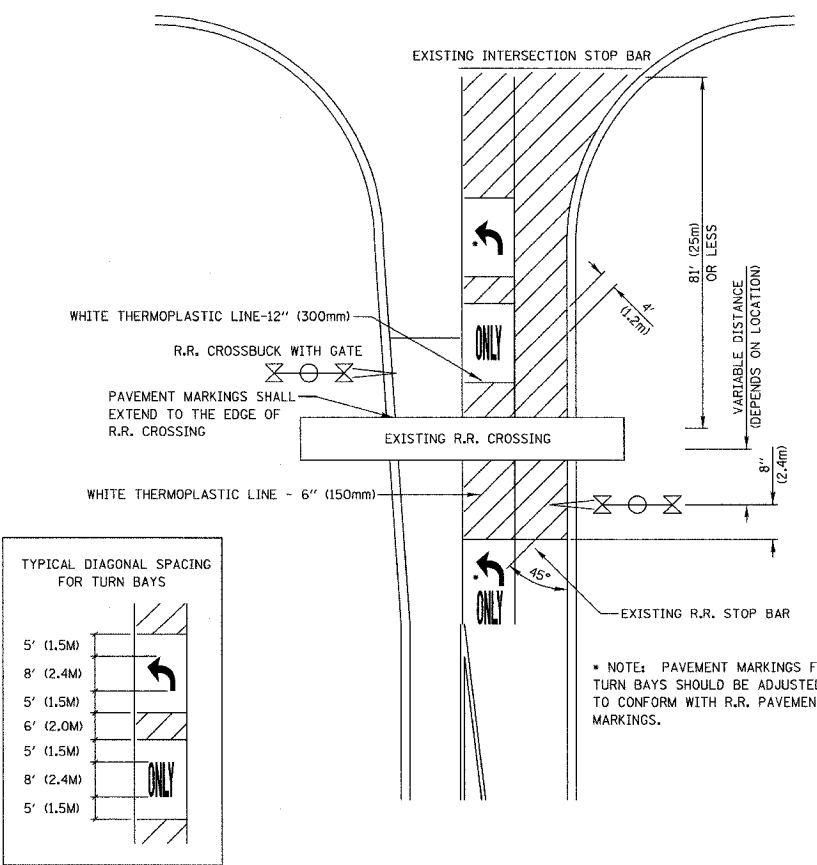
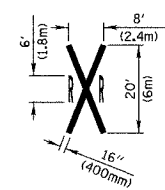

* NOTE: PAVEMENT MARKINGS FOR TURN BAYS SHOULD BE ADJUSTED TO CONFORM WITH R.R. PAVEMENT MARKINGS.

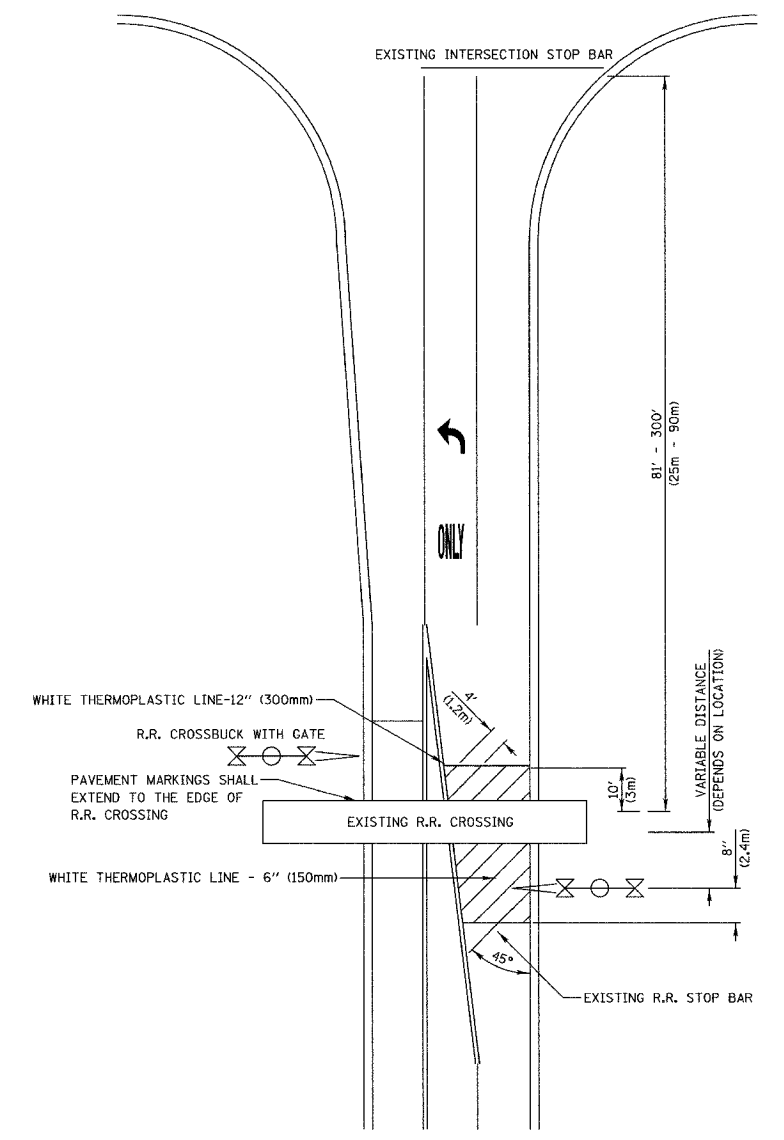

NOTE: DETAIL NOT APPLICABLE FOR DEERFIELD PARKWAY IMPROVEMENT.

REVISIONS		COUNTY	
NAME	DATE		
JOHN SAUTER	9/25/98		
JOHN SAUTER	7/7/99		

TYPICAL PAVEMENT MARKINGS FOR RAILROAD CROSSINGS ON COUNTY HIGHWAYS

SCALE: NONE SHEET 3 OF 3 DRAWN BY: JPS
DATE: JAN. 12, 1998 CHECKED BY: ANK