

F.A.U. RTE.	SECTION	COUNTY	TOTAL SHEETS
5352	04-00168-00-RS	DEKALB	67
DETAILS			
FED. ROAD DIST. NO. 5 ILLINOIS FED. AID PROJECT			

STANDARD DETAIL FOR SIDEWALK RAMPS

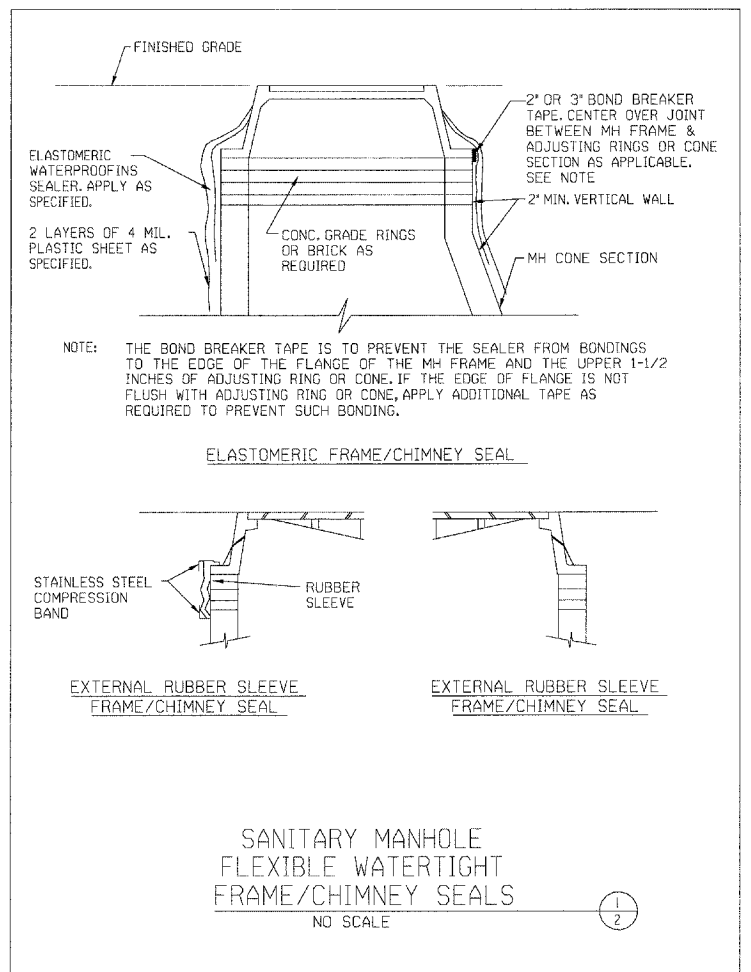
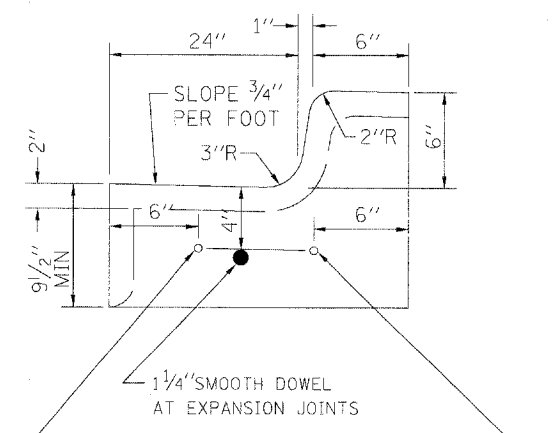
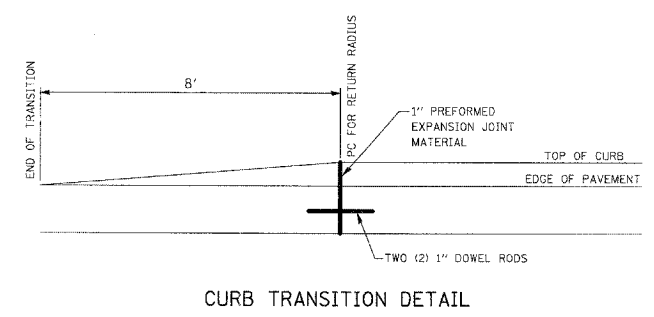
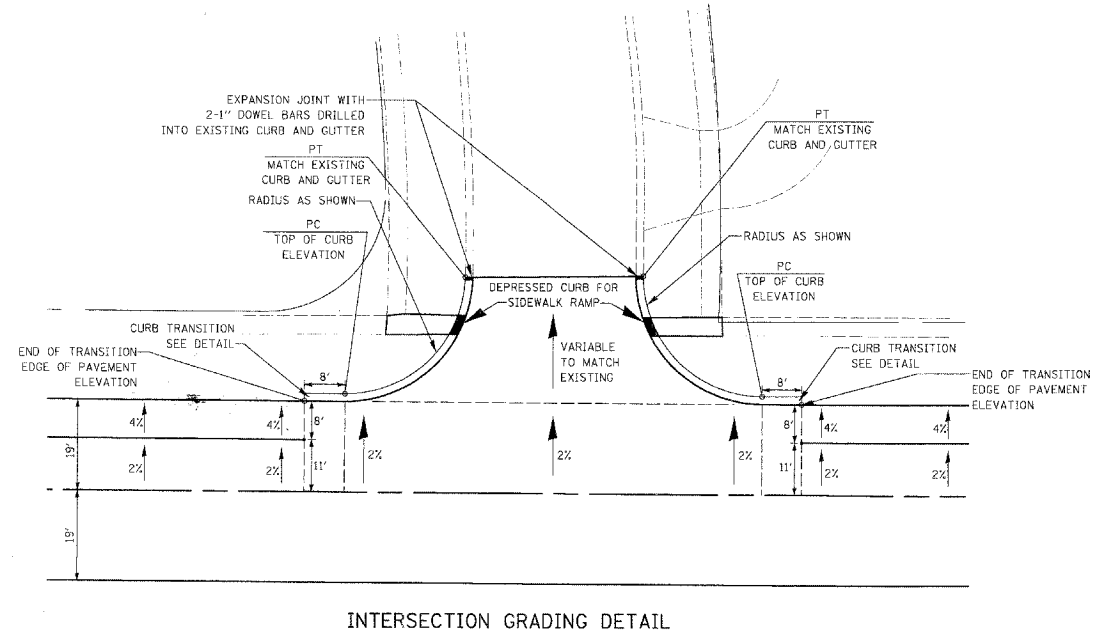
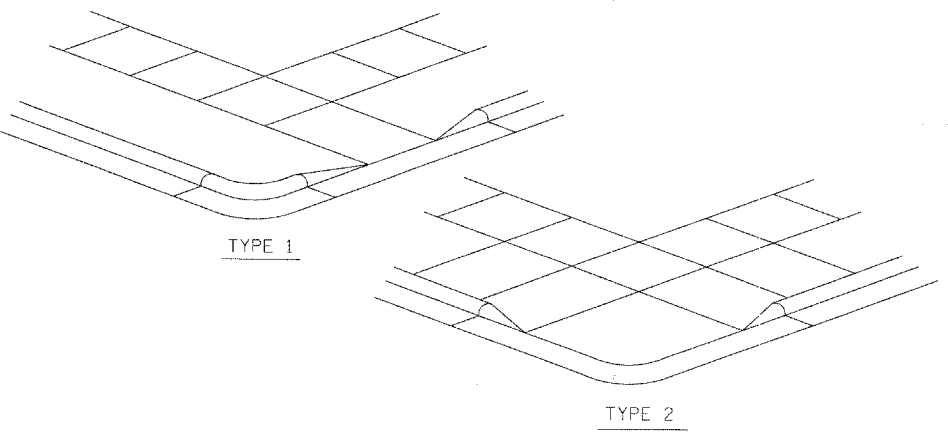
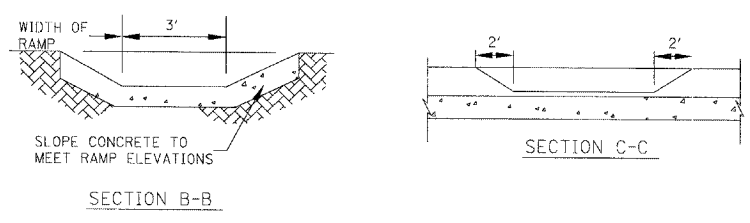
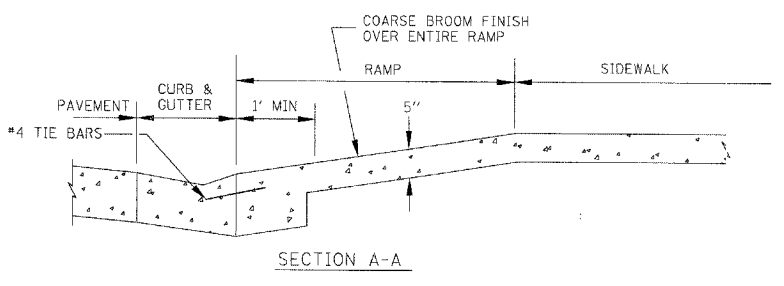
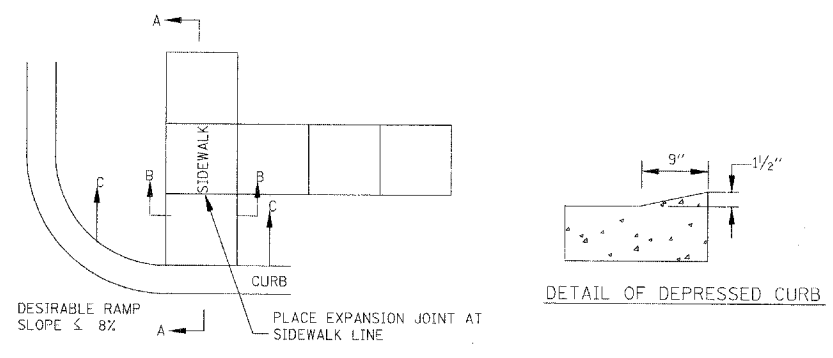

NOTES: CURB CUT RAMPS ARE TO BE LOCATED IN LINE WITH ALL CROSS WALKS OR AS DIRECTED BY THE ENGINEER

FINAL SURFACE TEXTURE OF THE RAMP SHALL BE THAT OBTAINED PLACING FIBERGLASS REINFORCED POLYMER CEMENT PANELS WITH RAISED TRUNCATED DOMES IN THE FINISHED CONCRETE.

CARE SHALL BE TAKEN TO ASSURE A UNIFORM GRADE ON THE RAMP, FREE OF SAGS AND SHORT GRADE CHANGES

IF POSSIBLE, DRAINAGE STRUCTURES SHALL NOT BE PLACED IN LINE WITH RAMPS, EXCEPT WHERE EXISTING DRAINAGE STRUCTURES ARE BEING UTILIZED IN THE NEW CONSTRUCTION. LOCATION OF THE RAMP SHOULD TAKE PRECEDENCE OVER LOCATION OF THE DRAINAGE STRUCTURE.

THE NORMAL GUTTER LINE PROFILE SHALL BE MAINTAINED THROUGH THE AREA OF THE RAMP.

CROSSWALK AND STOP LINE MARKINGS, IF USED, SHALL BE SO LOCATED AS TO STOP TRAFFIC SHORT OF RAMP CROSSING.

THE COST OF CONSTRUCTION OF CURB CUT RAMPS, INCLUDING DEPRESSED CURB, SHALL NOT BE PAID FOR SEPARATELY BUT SHALL BE INCLUDED IN THE CONTRACT UNIT PRICE FOR P.C.C. SIDEWALK AND COMBINATION CONCRETE CURB AND GUTTER.

NO. 4 TIE BARS, 2' LONG, ON MAXIMUM 2'-6" CENTERS SHALL BE INSTALLED BETWEEN THE CURB AND GUTTER SECTION AND THE SIDEWALK RAMP.

1 1/4" SMOOTH DOWEL AT EXPANSION JOINTS

TWO #4 REINFORCEMENT BARS, 10' IN LENGTH, CENTERED OVER TRENCH OR CONTINUOUS IF CURB IS WITHIN 3' OF TRENCH.

DEPTH OF SAWED CONTRACTION JOINT = 2"

CONTRACTION JOINTS SHALL BE 10' C/C

