

ROUTE NO.	SECTION	COUNTY	TOTAL SHEETS	SHEET NO.
CH 31	*	MACON	162	20
STA.		TO STA.		
FED. RD. DIST. NO. 7		ILLINOIS PROJECT		
* 02-00175-00-PV				

**EXISTING TOPO LEGEND**

- ⊙ MANHOLE
- GAS METER
- ⌘ MAILBOX
- ⊙ WATER METER
- ⊞ TELEPHONE BOX
- ⊕ FIRE HYDRANT
- ⊙ LIGHT POLE
- ⊙ GUY ANCHOR
- ⊕ POWER POLE
- ⊙ SIGN
- ⊙ TREE
- IRON PIN OR PROPERTY PIN
- ↔ SAME OWNERSHIP
- P — PROPERTY LINE
- X - X - X - FENCE
- W — WATER MAIN
- G — GAS
- T — TELEPHONE
- ~ CULTIVATION LINE
- — — EXISTING ROW
- /// UTILITY EASEMENT
- - - SECTION LINE
- ~ FLOW DIRECTION

**PROPOSED LEGEND**

- FLOW DIRECTION
- ◄ END SECTION
- CULVERT
- INLET
- ⊙ MANHOLE
- ↔ SUMMIT
- PIPE UNDERDRAIN
- STORM SEWER
- △ STRUCTURE NUMBER
- ① STORM SEWER NUMBER
- TBR TO BE REMOVED
- - - PROPOSED ROW
- /// TEMPORARY EASEMENT

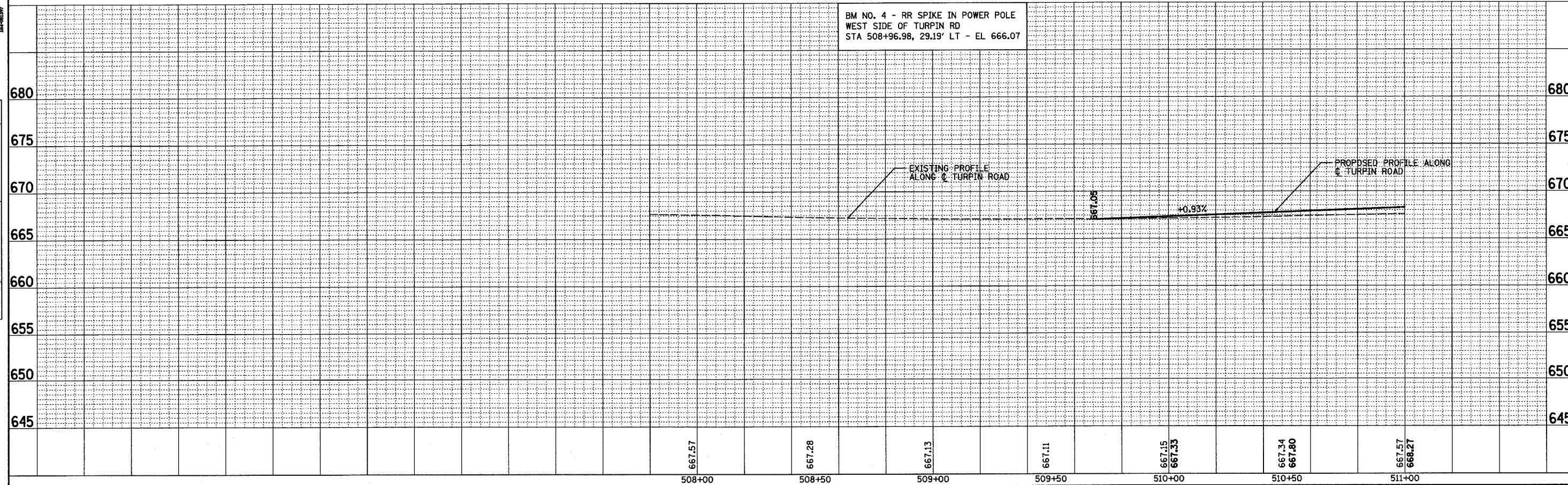
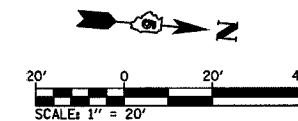
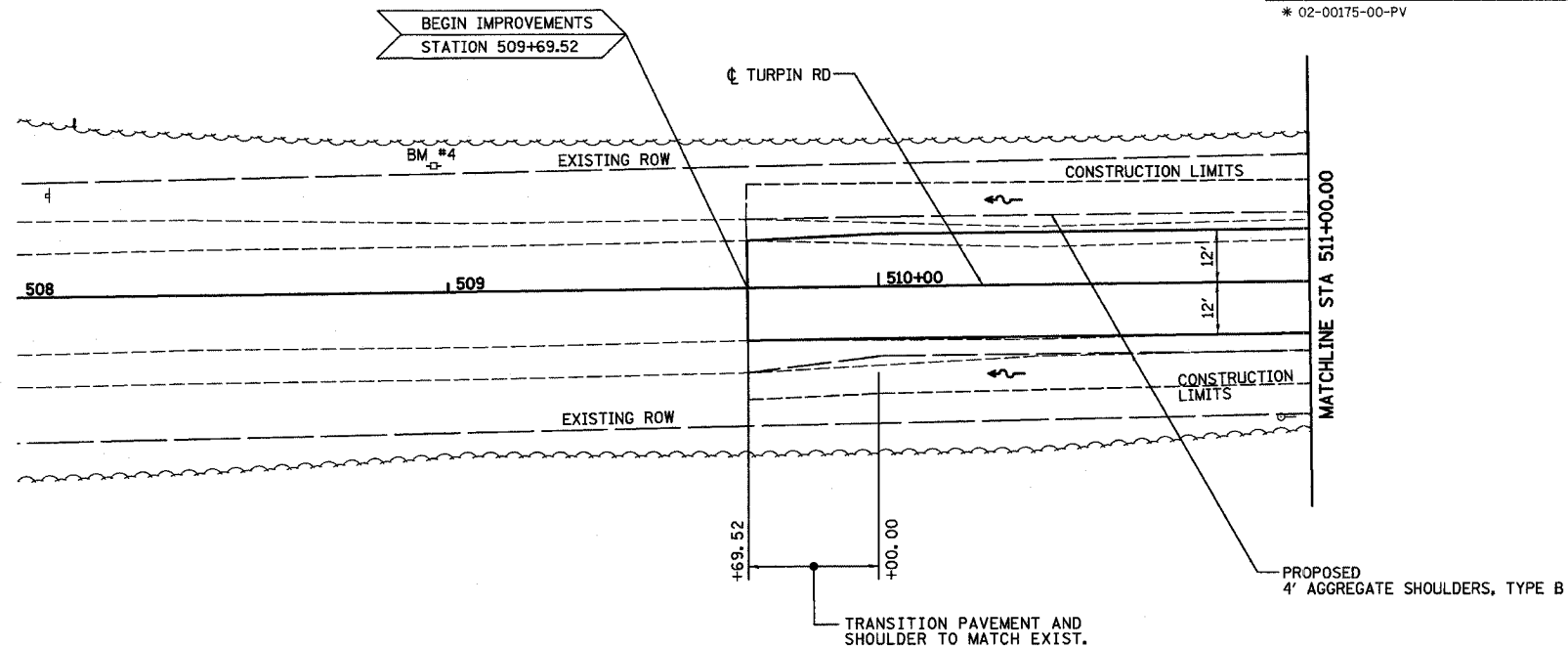

STA 508+00 TO STA 511+00

PLAN

DATE	BY
DATE	BY

CHICAGO

DECATUR  
317 422-8444  
CHICAGO  
773 714-0660

HOMER L. CHASTAIN & ASSOCIATES, LLP  
CORPORATE ENGINEERS

PROFILE

DATE	BY
DATE	BY

CHICAGO