

ROUTE NO.	SECTION	COUNTY	TOTAL SHEETS	SHEET NO.
CH 31	*	MACON	162	107
STA.		TO STA.		
FED. RD. DIST. NO. 7		ILLINOIS	PROJECT	
70-02-00175-00-PV				

FINAL	SURVEYED	BY	DATE
NOTEBOOK	PLOTTED		
NO.	RT. OF WAY CHECKED		
	NO.		

ORIGINAL	SURVEYED	BY	DATE
NOTEBOOK	PLOTTED		
NO.	STRUCTURE NOTATIONS OK'D		
	NO.		

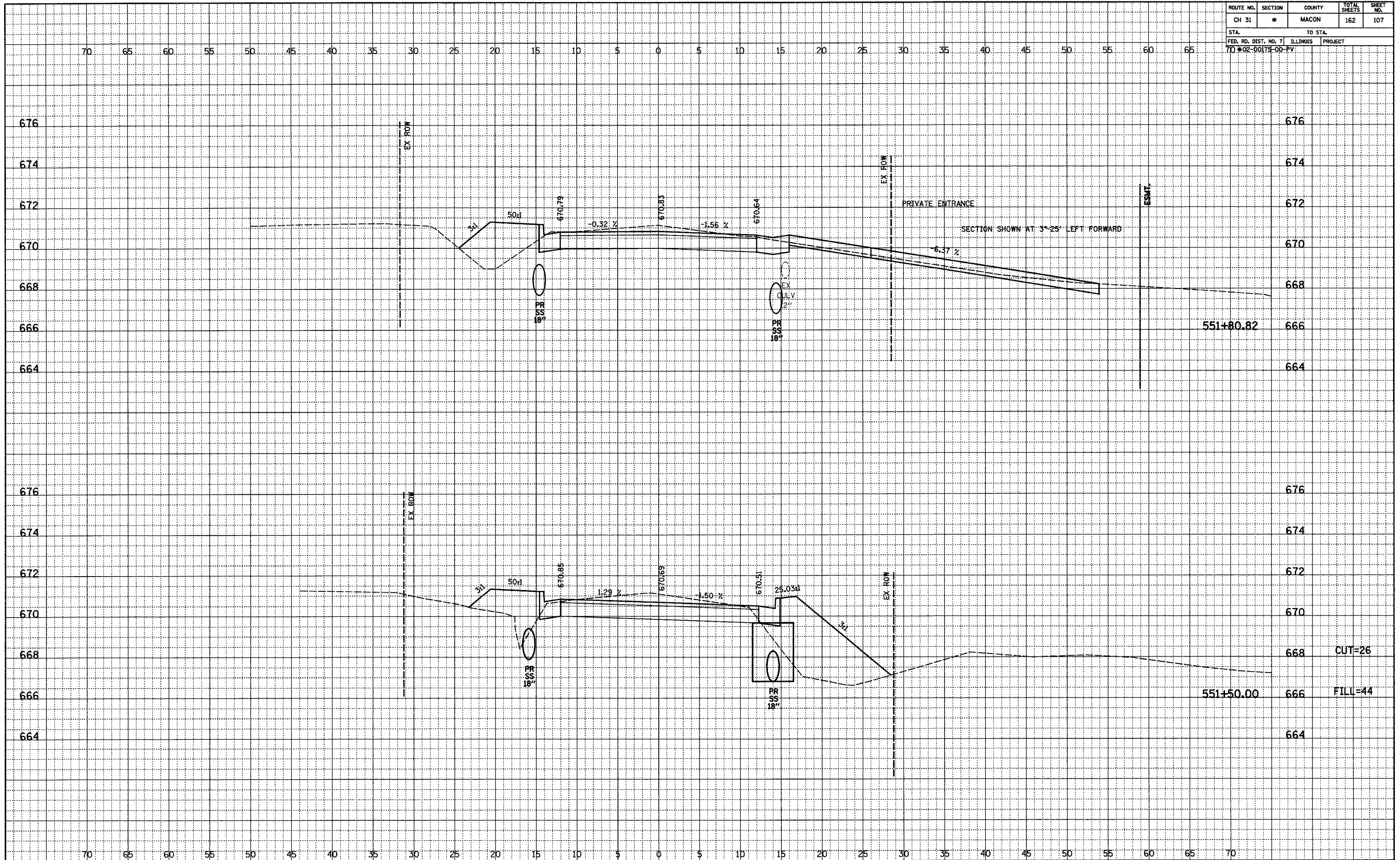

CUT=26

FILL=44