

T.R.	SECTION	COUNTY	TOTAL SHEETS	SHEET NO.
236	00-03136-00-BR	HAMILTON	13	2
FED. ROAD DIST. NO. 7 ILLINOIS		AUXIER CREEK		
LEC JOB # H02L024M		CONTRACT NO. 95421		

323 W. 3RD ST.
P.O. BOX 160
MT. CARMEL, IL
62863
PHONE: (618)-262-8651
FAX: (618)-263-3327

405 W. STATE ST
SUITE 1
FRANCIS LUEKE, IN
47670
PHONE: (812)-386-7611
FAX: (812)-385-2812

GENERAL NOTES:

THIS SECTION SHALL BE CONSTRUCTED IN ACCORDANCE WITH THE PLANS, SPECIAL PROVISIONS AND "STANDARD SPECIFICATIONS FOR ROAD AND BRIDGE CONSTRUCTION", ADOPTED JANUARY 1, 2002.

THE WORK INVOLVED ON THIS SECTION CONSISTS OF THE REMOVAL OF THE EXISTING STRUCTURE, THE CONSTRUCTION OF A 105 FOOT LONG TRIPLE SPAN (3 @ 35') PRECAST, PRESTRESSED CONCRETE DECK BEAM BRIDGE, EARTH APPROACHES, AGGREGATE SURFACE COURSE AND OTHER MISCELLANEOUS ITEMS NECESSARY TO COMPLETE THIS SECTION.

ALL ELEVATIONS ARE BASED ON U.S.G.S. MEAN SEA LEVEL DATUM.

IT SHALL BE THE CONTRACTOR'S RESPONSIBILITY TO CONTACT ALL THE UTILITIES, AFFECTING THE PROJECT, PRIOR TO CONSTRUCTION.

SEEDING SHALL BE DONE BY OTHERS.

PRIOR TO CONSTRUCTION THE CONTRACTOR SHALL INSTALL AGGREGATE (EROSION CONTROL) ACROSS AUXIER CREEK AT THE R-O-W LINE DOWNSTREAM FROM THE PROPOSED BRIDGES. GRADATION OF THE RIPRAP SHALL BE RR4 AND SHALL BE CONSTRUCTED IN ACCORDANCE WITH STD. 280001.

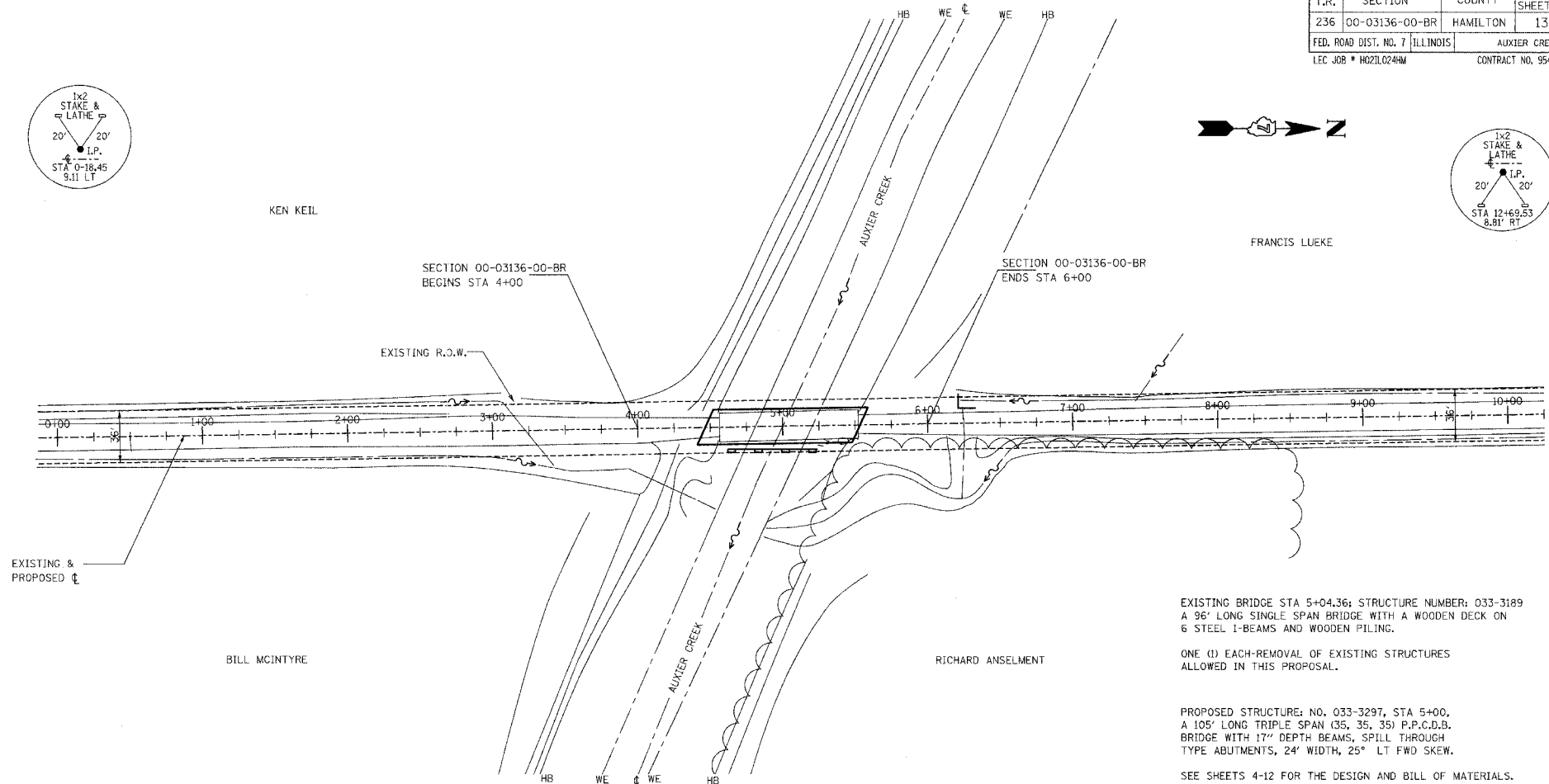
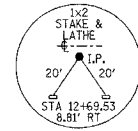
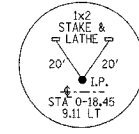

TYPICAL CROSS SECTION PROPOSED

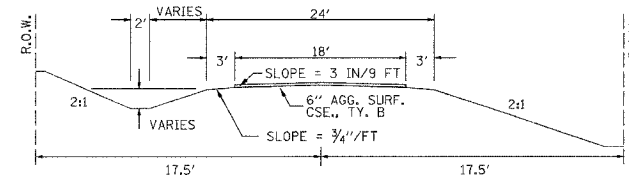

TYPICAL CROSS SECTION EXISTING

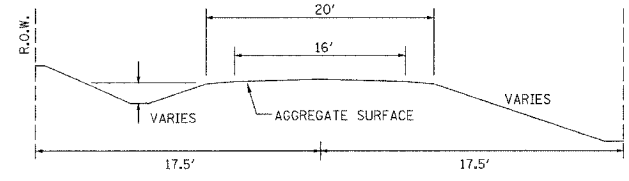

EXISTING BRIDGE STA 5+04.36, STRUCTURE NUMBER: 033-3189
A 96' LONG SINGLE SPAN BRIDGE WITH A WOODEN DECK ON 6 STEEL I-BEAMS AND WOODEN PILING.
ONE (1) EACH-REMOVAL OF EXISTING STRUCTURES ALLOWED IN THIS PROPOSAL.

PROPOSED STRUCTURE: NO. 033-3297, STA 5+00,
A 105' LONG TRIPLE SPAN (35, 35, 35) P.P.C.D.B. BRIDGE WITH 17\"/>

SEE SHEETS 4-12 FOR THE DESIGN AND BILL OF MATERIALS.

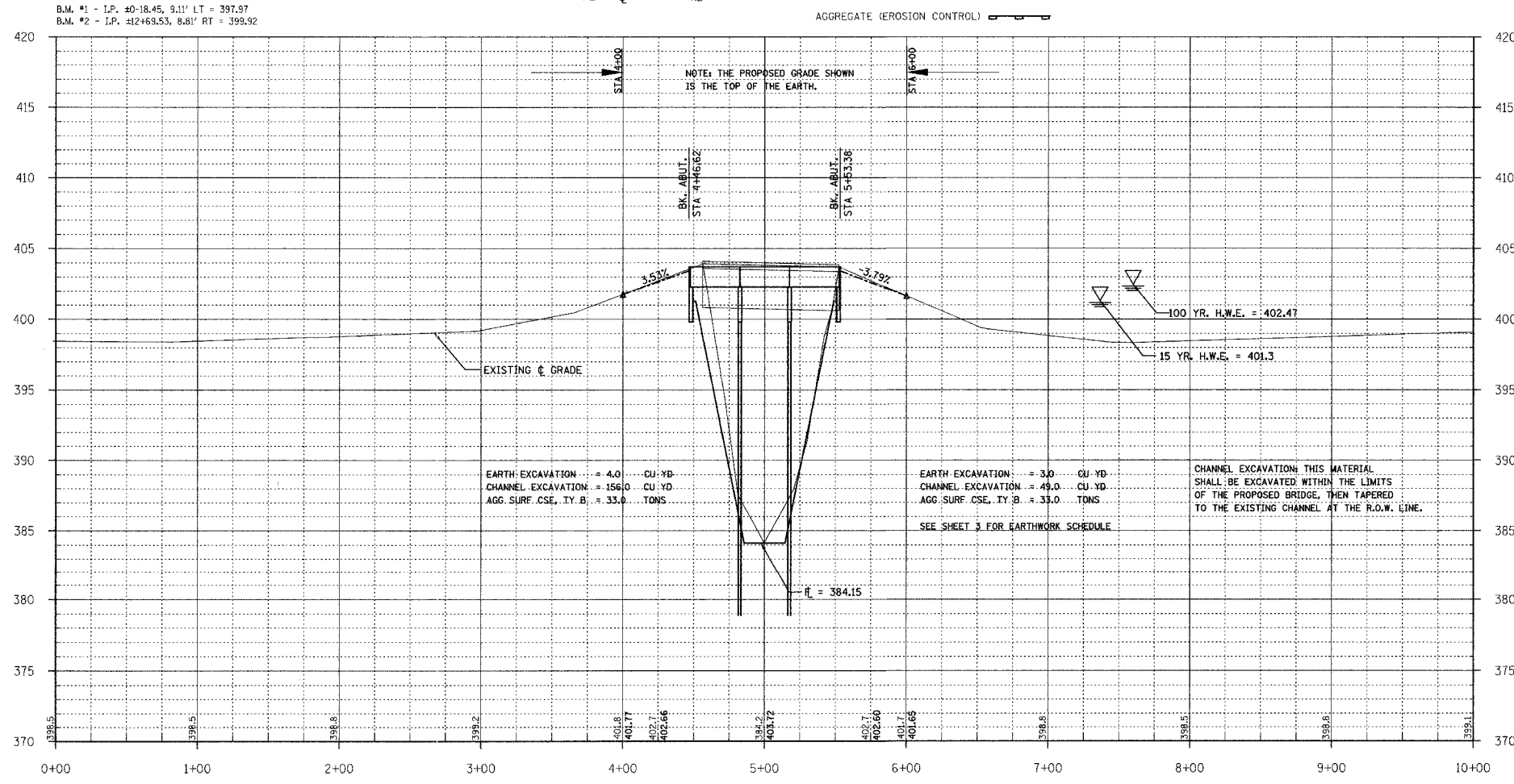

PROFESSIONAL DESIGN FIRM
LAND SURVEY & PROFESSIONAL ENGINEERING CORPORATION
184-000897
(62-032435)(35-002769)



DUSTIN K. BUNTING
NAME
SIGNATURE
DATE: 05-09-05
11-30-05 EXPIRES

TOWNSHIP ROUTE 236
AUXIER CREEK
HAMILTON COUNTY, ILLINOIS

SHEET TITLE:

PLAN & PROFILE

SCALE: VARIES
BY: DKB
DATE: 06/04
REV:

2 OF 13 SHEETS

SHEET NO. 2