

SEC 36, T7N, R14W

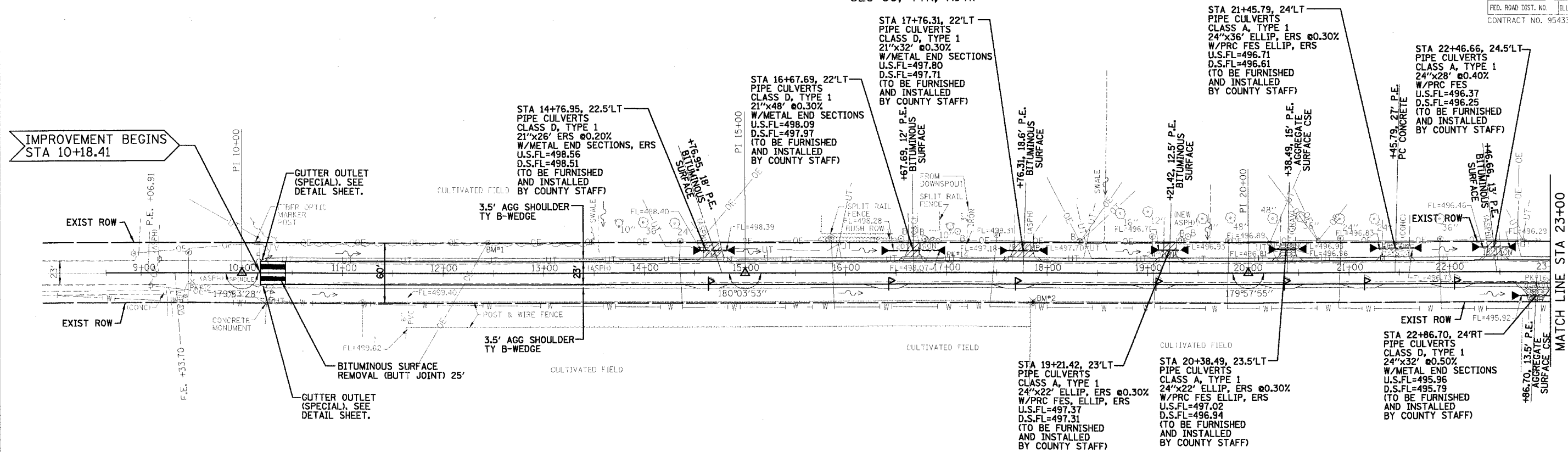

SEC 31, T7N, R13W

COUNTY HIGHWAY #1 (200E)

- NOTES:
1. A FIBER OPTIC LINE IS LOCATED ON THE WEST SIDE OF C.H. #1 ACCORDING TO THE UTILITY COMPANY.
 2. ELLIP=ELLIPTICAL
ERS=EQUIVALENT ROUND SIZE
PRC=PRECAST REINFORCED CONCRETE
FES=FLARED END SECTIONS
 3. SEE CROSS SECTIONS FOR LOCATIONS WHERE THE CONTRACTOR SHALL GRADE DITCHES.

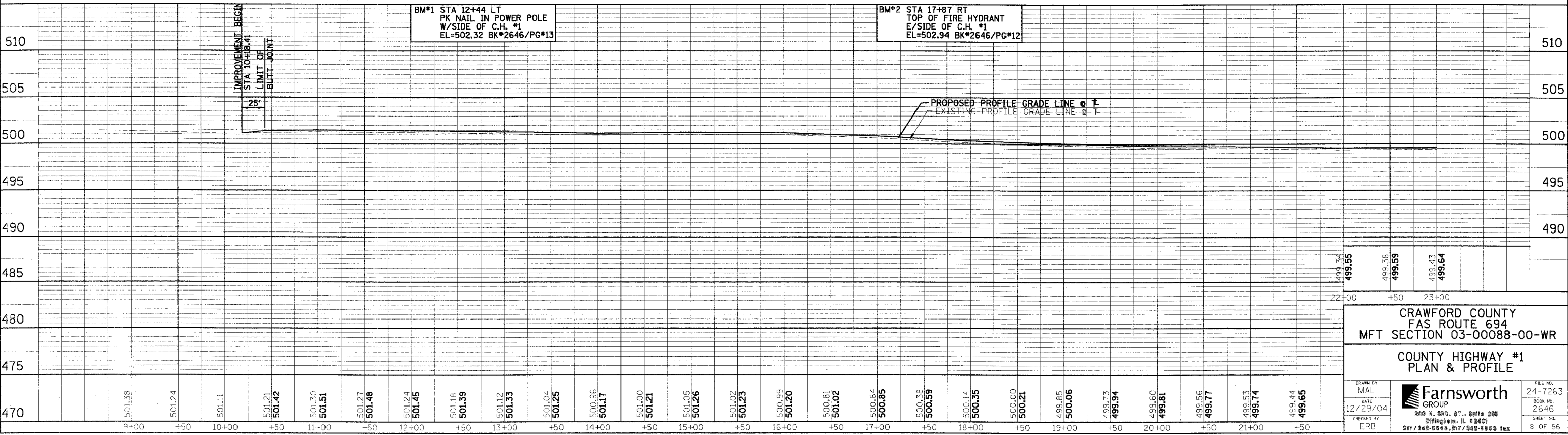

CRAWFORD COUNTY
FAS ROUTE 694
MFT SECTION 03-00088-00-WR

COUNTY HIGHWAY #1
PLAN & PROFILE

DRAWN BY MAL	FILE NO. 24-7263
DATE 12/29/04	BOOK NO. 2646
CHECKED BY ERB	SHEET NO. 8 OF 56

Farnsworth GROUP
200 N. 3RD. ST., Suite 206
Effingham, IL 62401
217/362-5559, 217/362-6663 Fax

F:\1\1\usep\dgn\24-7263.dgn
 DATE: 8 Dec 96