

SEC 13, T7N, R14W

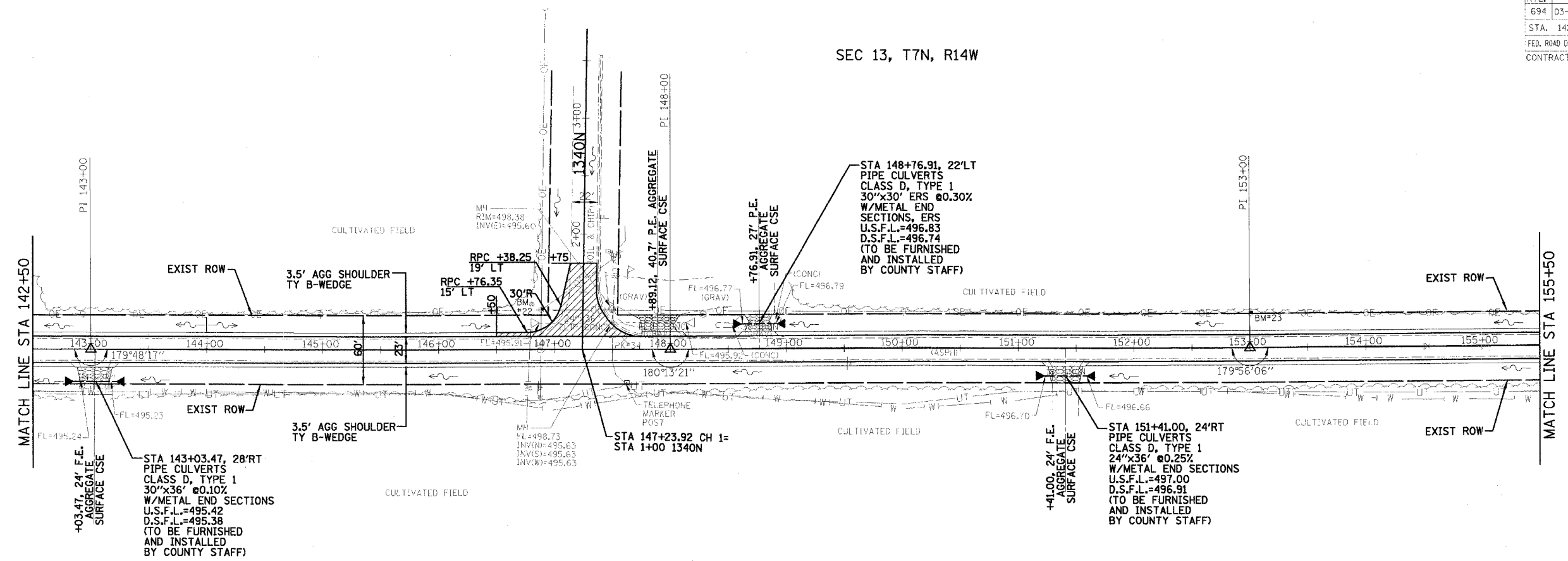

SEC 18, T7N, R13W

COUNTY HIGHWAY #1 (200E)

- NOTES:
- ELLIP=ELLIPTICAL
ERS=EQUIVALENT ROUND SIZE
PRC=PRECAST REINFORCED CONCRETE
FES=FLARED END SECTIONS
 - SEE CROSS SECTIONS FOR LOCATIONS WHERE THE CONTRACTOR SHALL GRADE DITCHES.

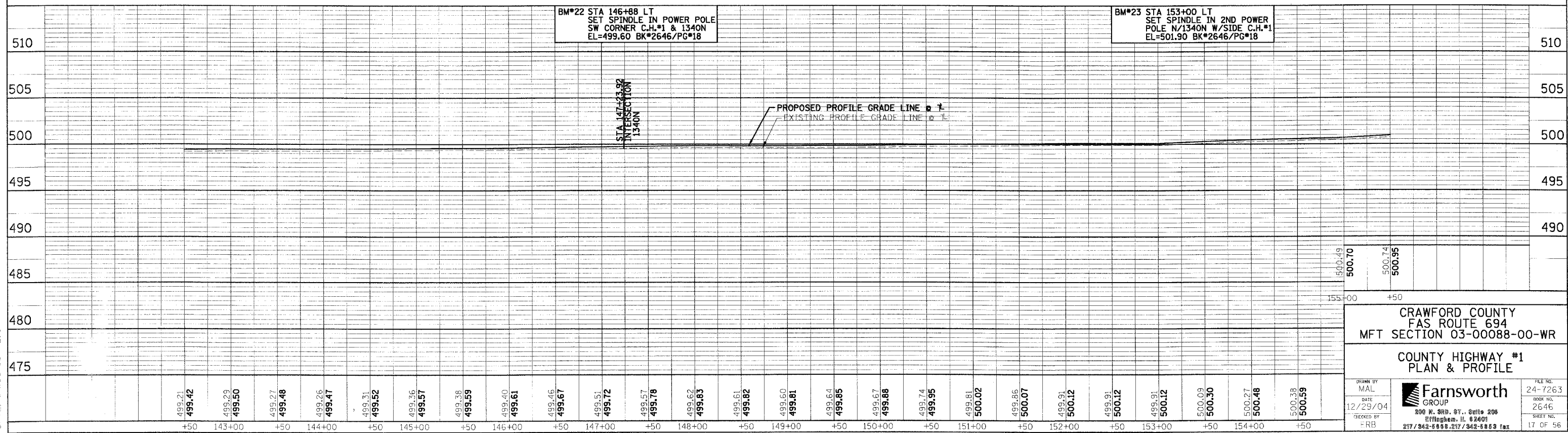

CRAWFORD COUNTY
FAS ROUTE 694
MFT SECTION 03-00088-00-WR

COUNTY HIGHWAY #1
PLAN & PROFILE

DRWN BY MAL	FILE NO. 24-7263
DATE 12/29/04	BOOK NO. 2646
CHECKED BY FRB	SHEET NO. 17 OF 56

File: c:\us03\vdgm\p\p\eng.dgn
 Date: 8-Dec-06 2:00