

F.A.P. RTE	SECTION	COUNTY	TOTAL SHEETS	SHEET NO
726	130 1-2.TS	WILLIAMSON	90	22
STA.		TO STA.		
FED. ROAD DIST. NO.		ILLINOIS	FED. AID PROJECT	
CONTRACT NO 98884				

COUNTRYSIDE HOME CENTER

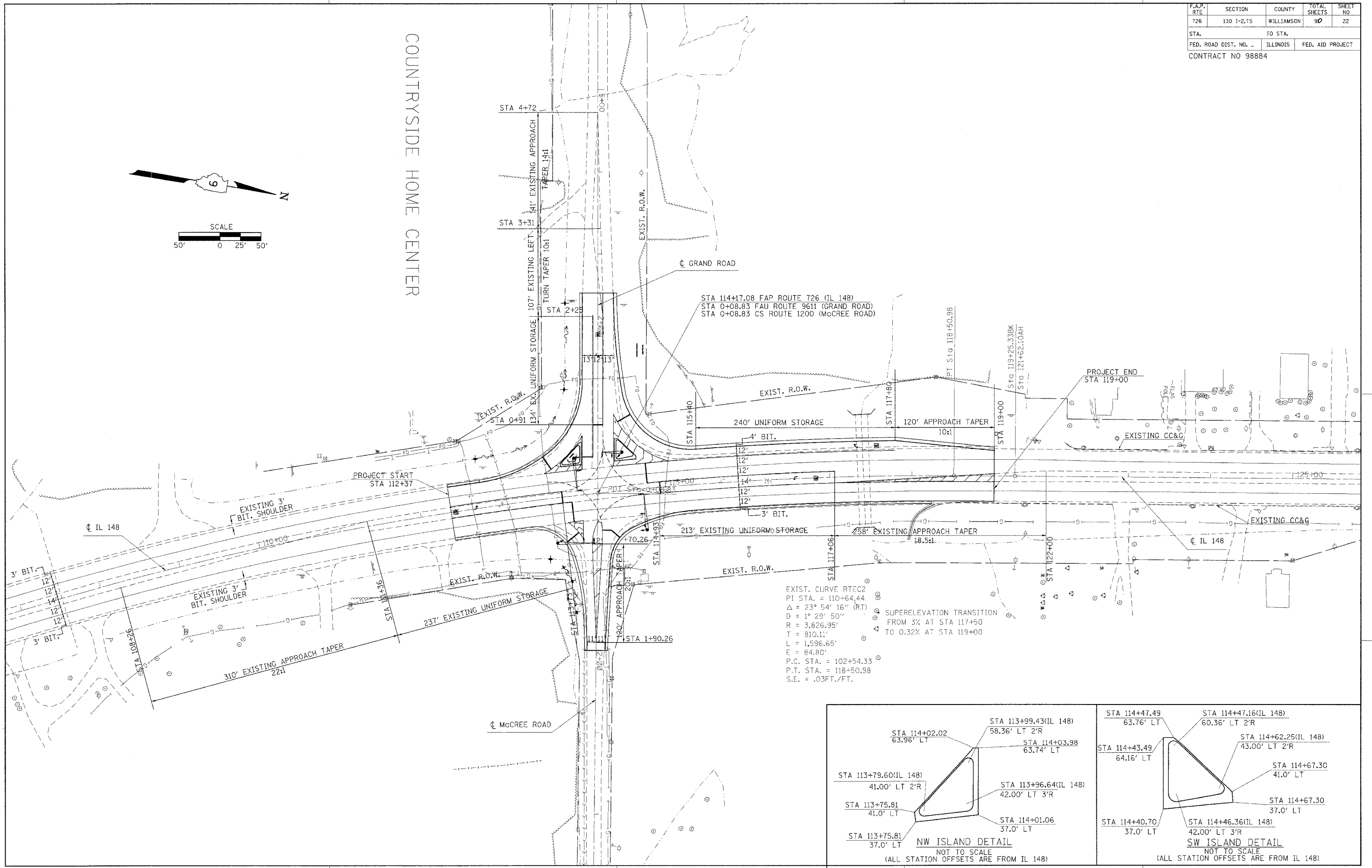
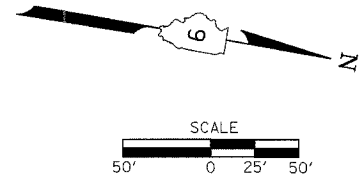

STA 114+17.08 FAP ROUTE 726 (IL 148)
 STA 0+08.83 FAU ROUTE 9611 (GRAND ROAD)
 STA 0+08.83 CS ROUTE 1200 (McCREE ROAD)

EXIST. CURVE RTE2
 PI STA. = 110+64.44
 $\Delta = 23^\circ 54' 16''$ (RT)
 $D = 1^\circ 23' 50''$
 $R = 3,826.95'$
 $T = 810.11'$
 $L = 1,596.65'$
 $E = 84.80'$
 P.C. STA. = 102+54.33
 P.T. STA. = 118+50.98
 S.E. = .03FT./FT.

SUPERELEVATION TRANSITION
 FROM 3% AT STA 117+50
 TO 0.32% AT STA 119+00

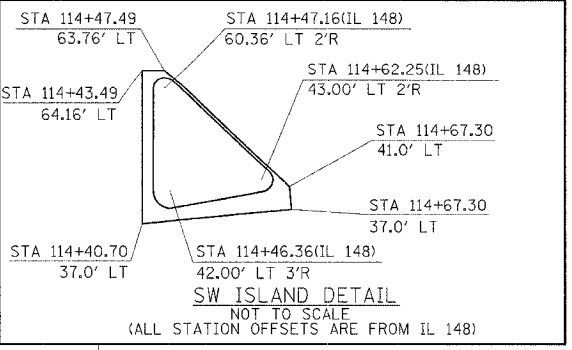
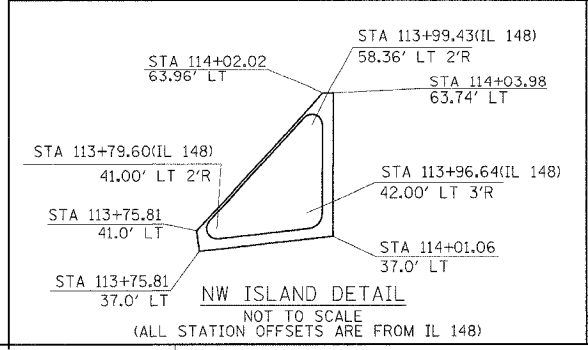

ROUTE-TIME
 100N-SPEC
 REF-EX-13
 REF-PROP