

JUN 14, 2005 9:17 AM CAH  
 I:\AIRPORTS\LITCHFIELD\814-051HG(AIRPORT)SHEETS\R-701PNP.DWG - Layout1

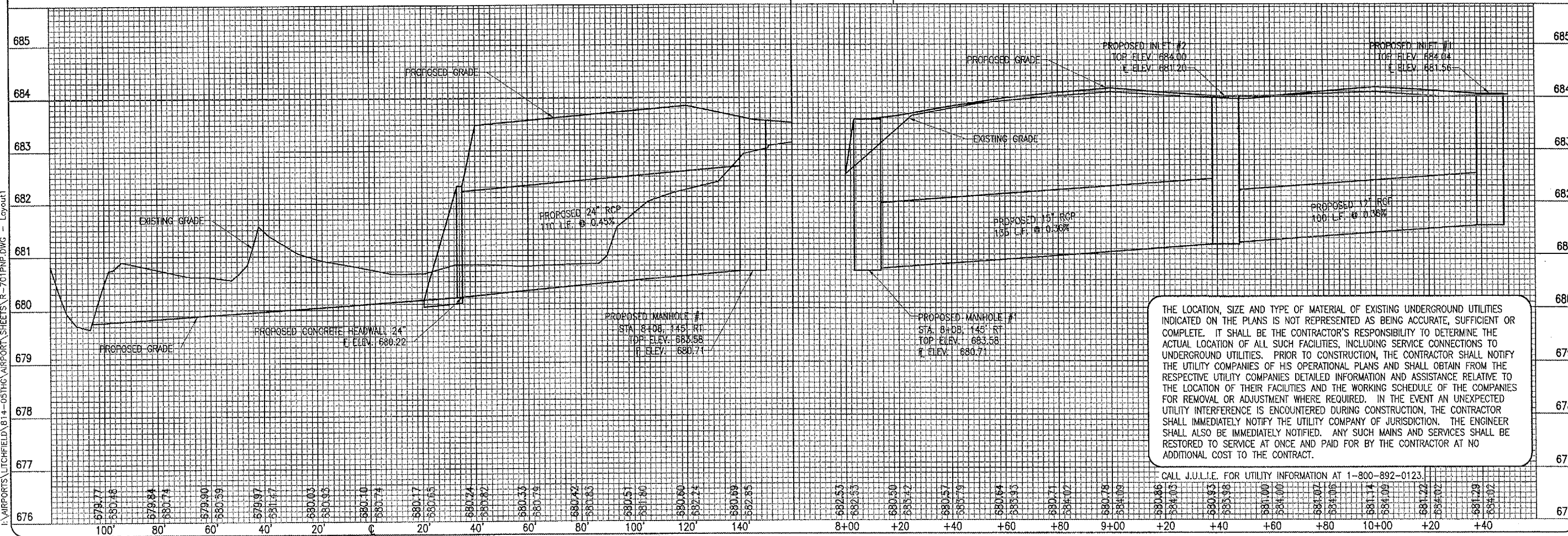
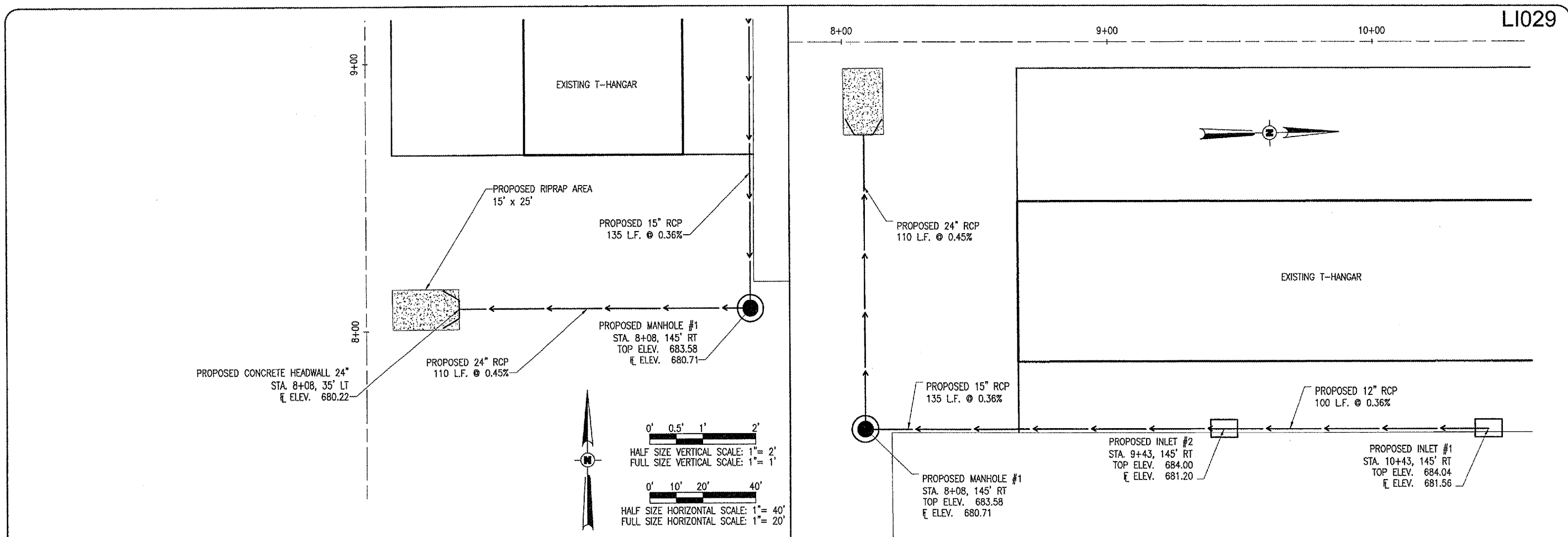

THE LOCATION, SIZE AND TYPE OF MATERIAL OF EXISTING UNDERGROUND UTILITIES INDICATED ON THE PLANS IS NOT REPRESENTED AS BEING ACCURATE, SUFFICIENT OR COMPLETE. IT SHALL BE THE CONTRACTOR'S RESPONSIBILITY TO DETERMINE THE ACTUAL LOCATION OF ALL SUCH FACILITIES, INCLUDING SERVICE CONNECTIONS TO UNDERGROUND UTILITIES. PRIOR TO CONSTRUCTION, THE CONTRACTOR SHALL NOTIFY THE UTILITY COMPANIES OF HIS OPERATIONAL PLANS AND SHALL OBTAIN FROM THE RESPECTIVE UTILITY COMPANIES DETAILED INFORMATION AND ASSISTANCE RELATIVE TO THE LOCATION OF THEIR FACILITIES AND THE WORKING SCHEDULE OF THE COMPANIES FOR REMOVAL OR ADJUSTMENT WHERE REQUIRED. IN THE EVENT AN UNEXPECTED UTILITY INTERFERENCE IS ENCOUNTERED DURING CONSTRUCTION, THE CONTRACTOR SHALL IMMEDIATELY NOTIFY THE UTILITY COMPANY OF JURISDICTION. THE ENGINEER SHALL ALSO BE IMMEDIATELY NOTIFIED. ANY SUCH MAINS AND SERVICES SHALL BE RESTORED TO SERVICE AT ONCE AND PAID FOR BY THE CONTRACTOR AT NO ADDITIONAL COST TO THE CONTRACT.

CALL J.U.I.E. FOR UTILITY INFORMATION AT 1-800-892-0123.

DATE	REVISION	BY

**LITCHFIELD MUNICIPAL AIRPORT**  
**LITCHFIELD, ILLINOIS**

ILL. PROJ.: 31F-2774

REL. PROJECT NO.: 814-051HG0	DATE: 03/25/05
DESIGNER: R-701PNP.DWG	DRAWN: JMB
SCALE: HORIZ. 20' VERT. 1'	REVIEWED: CAH
DATE: 03/25/05	BY: ?

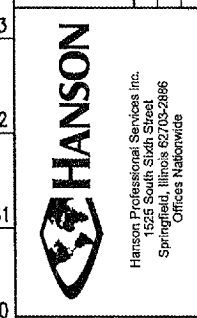

**T-HANGAR**  
**SITE DEVELOPMENT**

**PROPOSED DRAINAGE**  
**PLAN & PROFILE**

8 of 23 sheets