

PA048

K:\Palwaukee\0428003\Draw\Sheets\
 FILE: txy-grd1.dwg
 LAYOUT: Layout1
 UPDATE BY: johse
 SURVEY BOOK #
 DATE: Fri 7/1/05 3:03pm
 XREF DWG: tbcint.dwg
 tb.dwg
 txy-base.dwg

REVISIONS		
NUMBER	BY	DATE

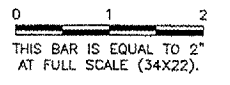

LEGEND

- NEW 10" PCC PAVEMENT
- NEW BITUMINOUS PAVEMENT
- EXISTING MANHOLE/INLET/SLOPEBOX/HEADWALL
- NEW MANHOLE/INLET/SLOPEBOX/HEADWALL
- NEW GRADING LIMITS
- NEW ELEVATION (639.38)
- EXISTING ELEVATION (638.58)
- MATCH PAVEMENT BY OTHERS

NOTE

- ADD 600' TO ELEVATIONS SHOWN FOR U.S.G.S. DATUM.

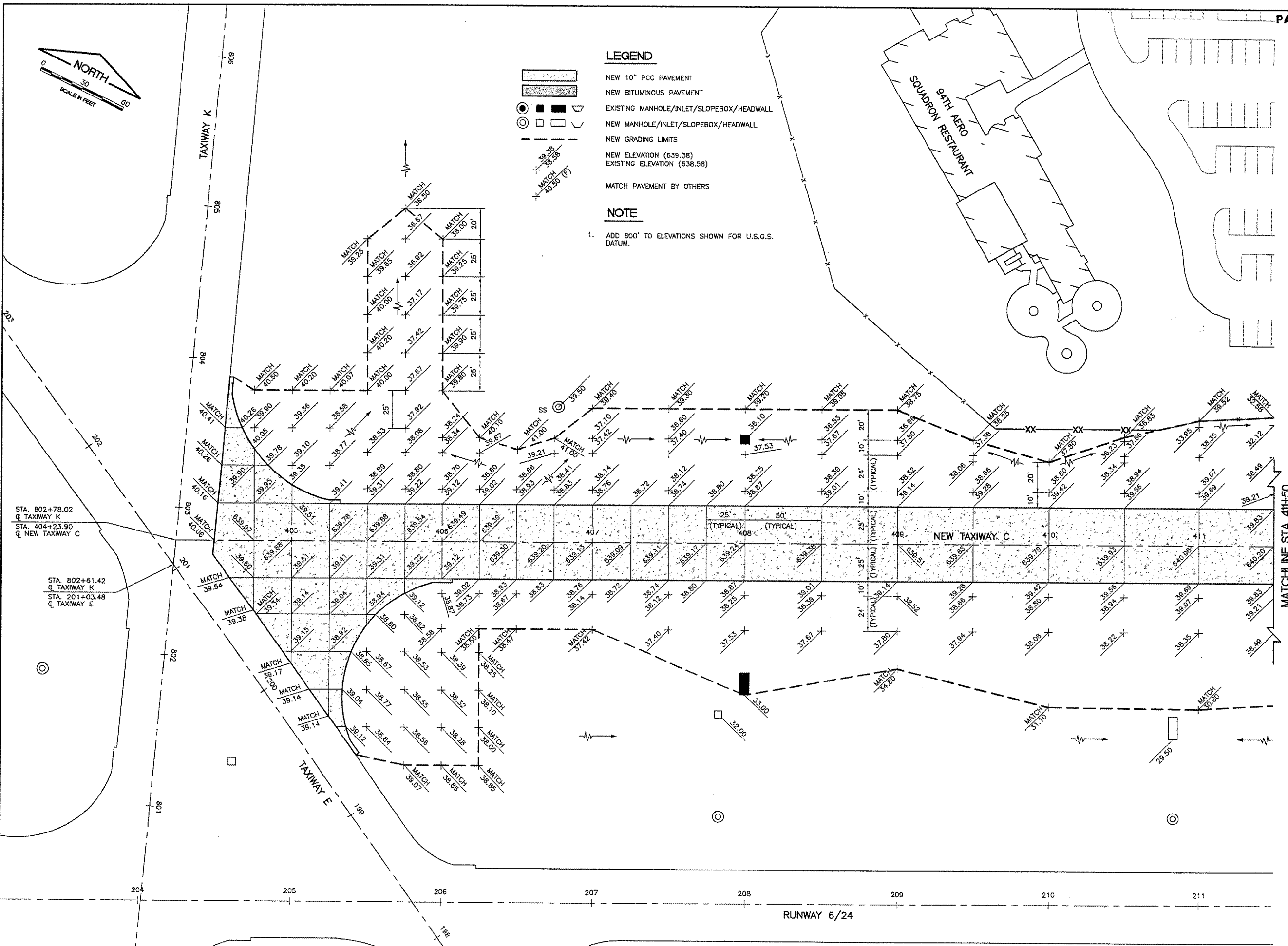

**PALWAUKEE MUNICIPAL AIRPORT
 WHEELING/PROSPECT HEIGHTS, ILLINOIS
 CONSTRUCT TAXIWAY CHARLIE AND EAST QUADRANT APRON
 GRADING PLAN -
 SHEET 1**

© Copyright CMT, Inc.
CMT
 CRAWFORD, MURPHY & TILLY, INC.
 CONSULTING ENGINEERS
 License No. 06-00663

DESIGN BY:	JRL
DRAWN BY:	JRO
CHECKED BY:	
APPROVED BY:	
DATE:	06/24/05
JOB No:	04290-03
ILLINOIS PROJECT: PWK-3481 A.I.P. PROJECT: 3-17-0018-BXX	
SHEET 14 OF 38 SHEETS	