

PE083

REVISIONS		
NUMBER	BY	DATE

0 1 2
 THIS BAR IS EQUAL TO 2"
 AT FULL SCALE (34X22)
 PLOT 1

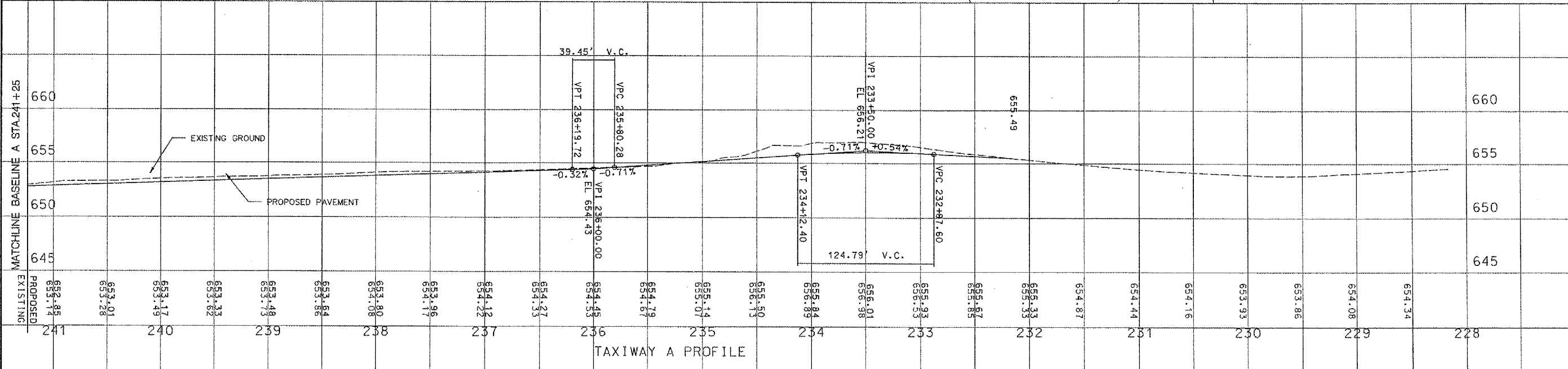
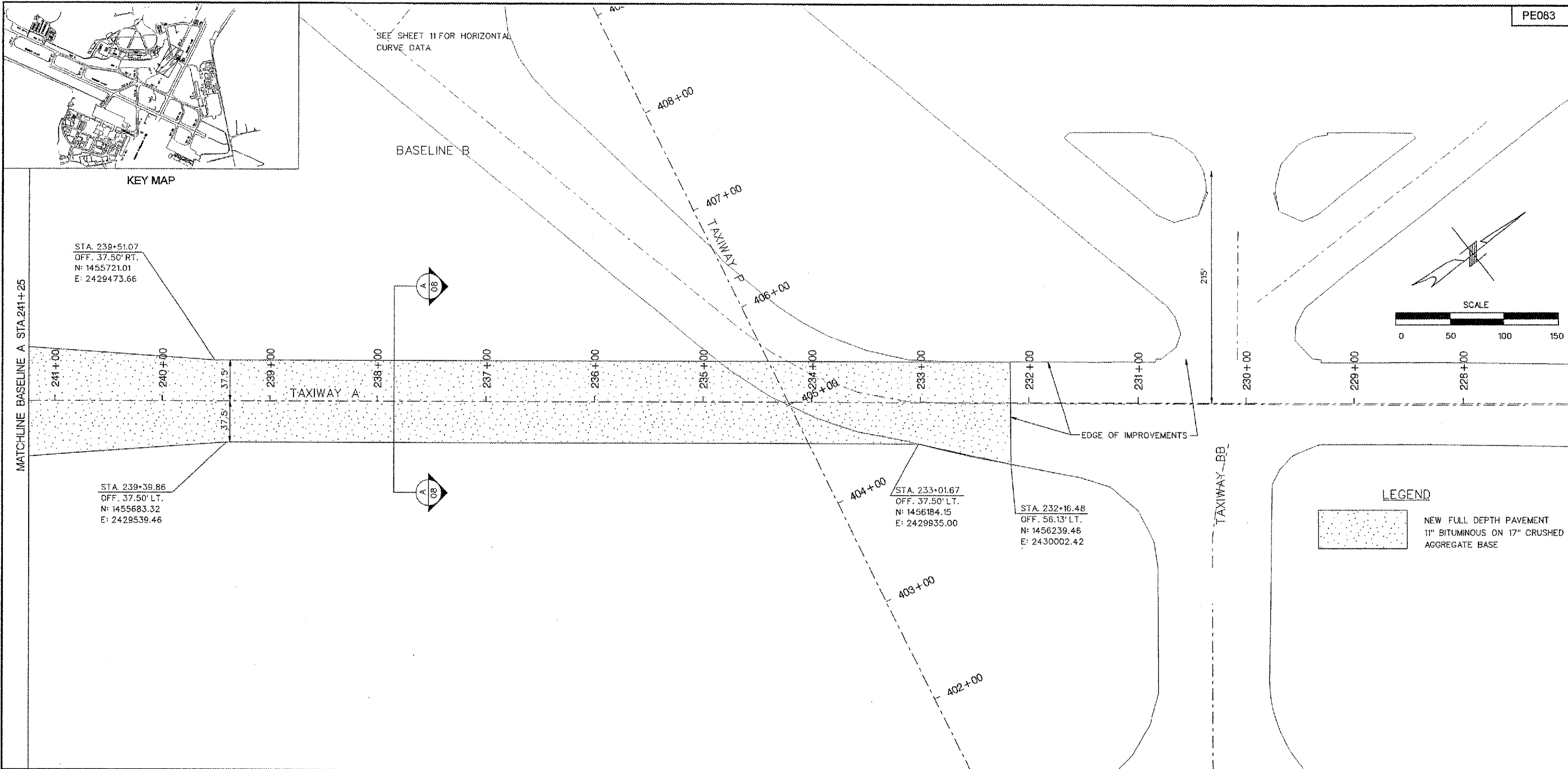

peoria REGIONAL Airport

RELOCATE TAXIWAY A FROM MID-FIELD INTERSECTION

CMT
 CRAWFORD, MURPHY & TILLY, INC.
 CONSULTING ENGINEERS

IL PROJECT: PIA-3343
 AIP PROJ: 3-17-0080-XX

FILE: k:\peoria\0406103\drawsheets\013_pp_2.dgn

DESIGN BY: TCS
 DRAWN BY: CAG
 CHECKED BY: TCS
 APPROVED BY: CET

DATE: JUNE 24, 2005
 JOB No: 04061-03

PLAN AND PROFILE
 SHEET 2 OF 3

SHEET 13 OF 43 SHEETS

06/23/2005
 k:\peoria\0406103\drawsheets\013_pp_2.dgn