

UN043

K:\Champaign\0305903\draw\sheet\ FILE: 49\_GRD\_ROD\_PLAN.dwg  
LAYOUT: Layout1  
UPDATE BY: adraughan  
SURVEY BOOK #  
DATE: Fri 6/17/05 12:18am  
XREF DWG: CMIBaseEPOEL.dwg  
baselines.dwg  
CintInfo.dwg  
tb.dwg

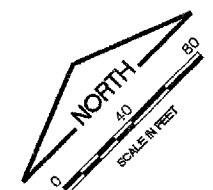

MAIN TERMINAL

CONCOURSE

BASELINE "A"  
STA. 16+72.50,  
327.50 LT

BASELINE "A"  
STA. 17+77.50,  
327.50 LT

118.75'  
SEE NOTE 1 (TYP.)

50'  
(TYP.)

50'  
(TYP.)

118.75'  
SEE NOTE 1 (TYP.)

90

91

92

93

94

11

12

13

14

15

16

17

18

19

20

BASELINE "A"

BASELINE "B"

TXY. A6

TXY. A7

LEGEND

● NEW AR510515 GROUND ROD

NOTES

- 1. GROUND RODS SHALL NOT BE PLACED WITHIN 2' OF A JOINT IN THE P.C.C. PAVEMENT. ADJUST LOCATIONS AS NECESSARY

REVISIONS

NUMBER	BY	DATE

0 1 2  
THIS BAR IS EQUAL TO 2"  
AT FULL SCALE (34X22).

UNIVERSITY OF ILLINOIS  
WILLARD AIRPORT  
REHABILITATE AIR CARRIER RAMP  
GROUND ROD PLAN

© copyright CMT, Inc.  
**CMT**  
CRAWFORD, MURPHY & TILLY, INC.  
CONSULTING ENGINEERS  
License No. 184-000618

DESIGN BY: SMS  
DRAWN BY: CMT  
CHECKED BY: SMS  
APPROVED BY: *[Signature]*  
DATE: 06/10/2005  
JOB No: 03059-03-00  
IL PROJECT: CMI-3449  
A.I.P. PROJECT: 3-17-0016-22  
SHEET 49 OF 58 SHEETS