

| F.A.P. RTE.         | SECTION | COUNTY                    | TOTAL SHEETS | SHEET NO. |
|---------------------|---------|---------------------------|--------------|-----------|
| 840                 | 143N    | WILL                      | 121          | 54        |
| STA.                |         | TO STA.                   |              |           |
| FED. ROAD DIST. NO. |         | ILLINOIS FED. AID PROJECT |              |           |

BM #3: "□" CUT ON SOUTH END OF TOP OF RETAINING WALL  
AT NW CORNER OF MARGARET ST. AND IL. RTE. 50.  
ELEVATION: 244.713

**IL. ROUTE 50**  
(SCALE 1:250)

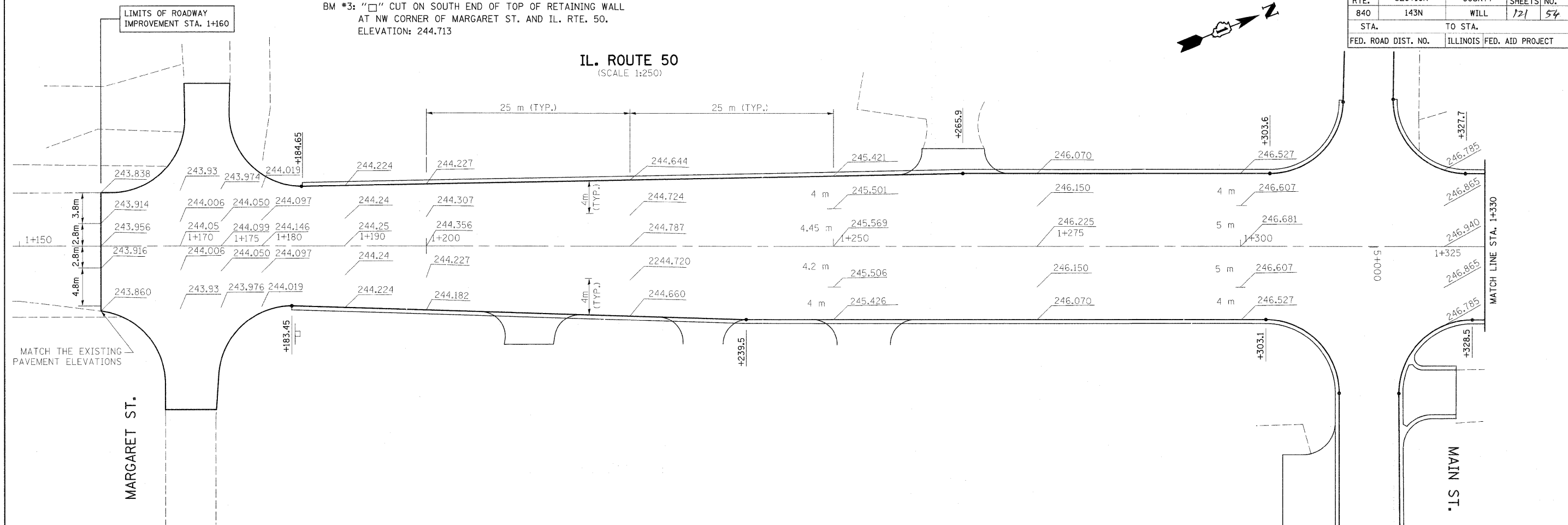

**IL. ROUTE 50**

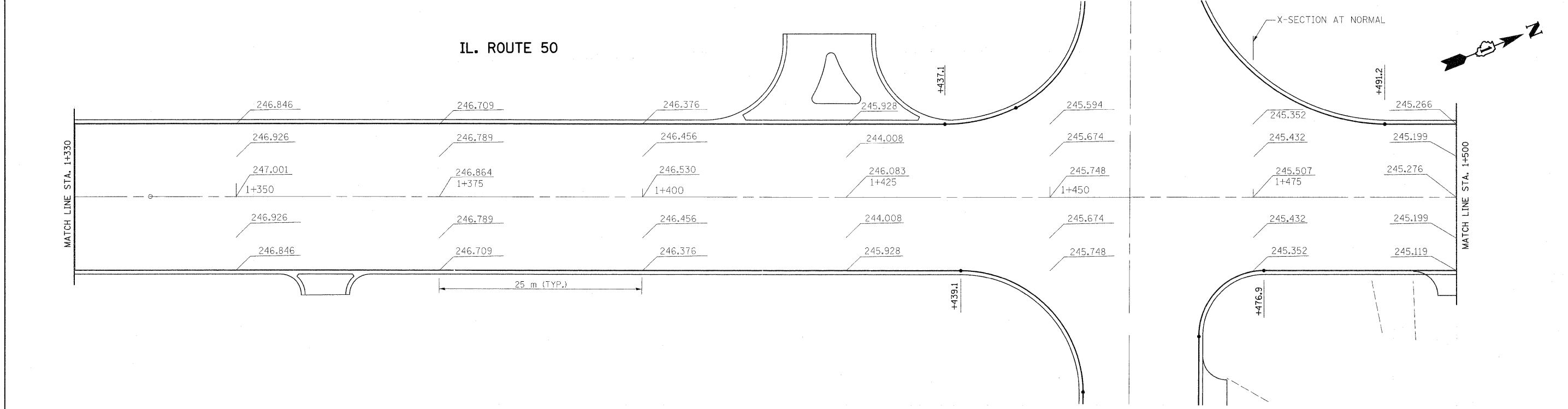

| REVISIONS |      | ILLINOIS DEPARTMENT OF TRANSPORTATION<br>PROPOSED PAVEMENT ELEVATIONS<br>FOR IL. ROUTE 50 |
|-----------|------|---|
| NAME      | DATE |   |
|           |      |   |
|           |      |   |
|           |      |   |
|           |      |   |
|           |      |   |
|           |      |   |
|           |      |   |
|           |      |   |
|           |      |   |

SCALE 1:250  
DATE 5/11/2011  
DRAWN BY CADD  
CHECKED BY