

p:\602540(57-294)\road\p2_kedzie\PI_GP_SHT01.dgn 4/29/2011 11:23:30 AM

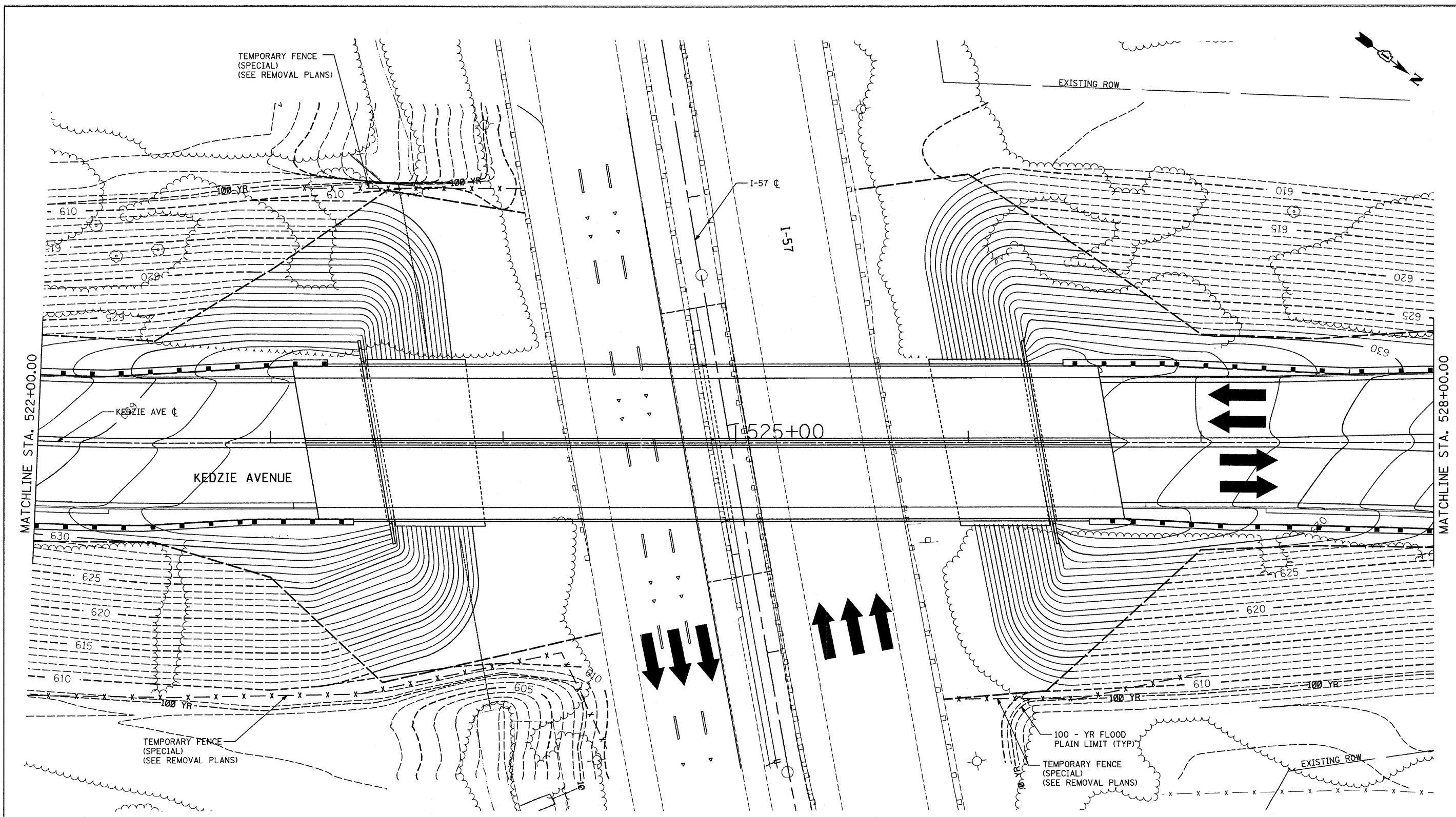

LEGEND:

- | | | | |
|-------------|---|-------|---|
| 630----- | EXISTING MAJOR ELEVATIONS AND MAJOR CONTOUR LINES AT 5 FT INTERVALS | ----- | PROPOSED MAJOR ELEVATIONS AND MAJOR CONTOUR LINES AT 5 FT INTERVALS |
| ----- | EXISTING MINOR CONTOUR LINES AT 1 FT INTERVALS | ----- | PROPOSED MINOR CONTOUR LINES AT 1 FT INTERVALS |
| 100 YR----- | 100 YEAR FLOOD PLAIN LIMIT | ----- | PROPOSED LIMITS OF CONSTRUCTION |

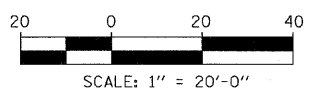

TYLIN INTERNATIONAL	USER NAME = #USER#	DESIGNED - JF	REVISED -	STATE OF ILLINOIS DEPARTMENT OF TRANSPORTATION	KEDZIE AVENUE PROJECT PROPOSED GRADING PLAN		F.A. RTE. 57	SECTION 1313.1B-1	COUNTY COOK	TOTAL SHEETS 162	SHEET NO. 31
	PLOT SCALE = #SCALE#	CHECKED - SES	REVISED -		SCALE: 1"=20'	SHEET NO. 1 OF 1 SHEETS	STA. 522+00 TO STA. 528+00	CONTRACT NO. 60K14		ILLINOIS FED. AID PROJECT	
	PLOT DATE = 4/29/2011	DATE - 5/5/2011	REVISED -								