

STATE OF ILLINOIS)
 COUNTY OF COOK) S.S.

UTILITY(IES) SHOWN HEREON HAVE BEEN INVESTIGATED BY ASE IN ACCORDANCE WITH SUE INDUSTRY STANDARDS QUALITY LEVEL A (QLA) AND B (QLB). ALL OTHER INFORMATION SHOWN HAS BEEN PROVIDED BY OTHERS.

FIELD WORK WAS PERFORMED BETWEEN THE 17TH OF JUNE AND 6TH DAY OF OCTOBER, A.D., 2010.

IN WITNESS WHEREOF, I HAVE HEREUNTO SET MY HAND AND SEAL THIS 15TH DAY OF OCTOBER A.D., 2010. CHICAGO, IL.

Steven M. Rienks
 STEVEN M. RIENKS ILLINOIS PROFESSIONAL ENGINEER NUMBER 62-044619 MY LICENSE EXPIRES 11/30/2011



LEGEND

- T — EXISTING UNDERGROUND TELEPHONE
- W — EXISTING UNDERGROUND WATER
- E — EXISTING UNDERGROUND ELECTRIC
- G — EXISTING UNDERGROUND GAS
- CTV — EXISTING UNDERGROUND CABLE TV
- FO — EXISTING UNDERGROUND FIBER OPTIC
- S — EXISTING UNDERGROUND SANITARY SEWER
- EOI — END OF SURFACE GEOPHYSICAL INFORMATION

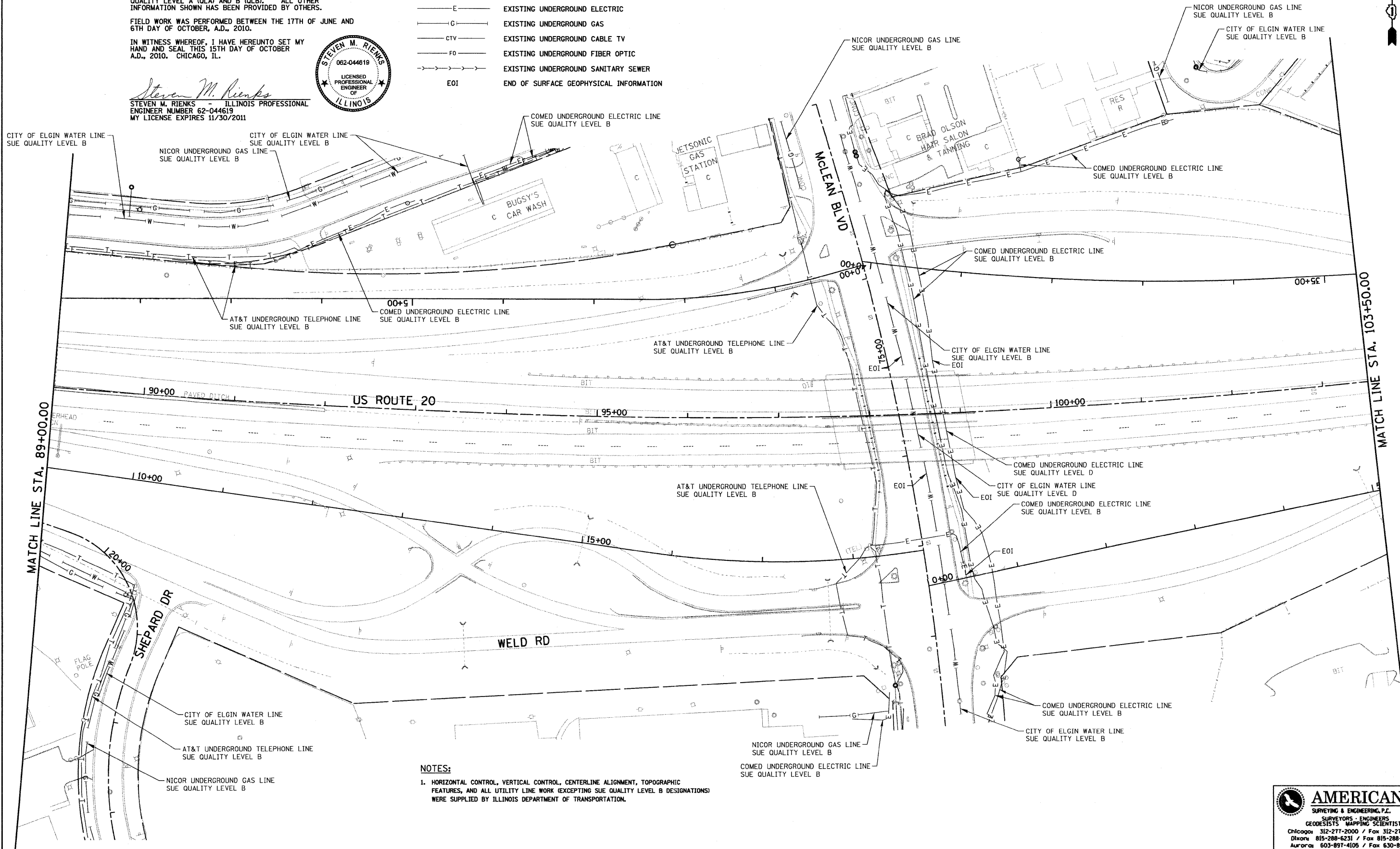

NOTES:
 1. HORIZONTAL CONTROL, VERTICAL CONTROL, CENTERLINE ALIGNMENT, TOPOGRAPHIC FEATURES, AND ALL UTILITY LINE WORK (EXCEPTING SUE QUALITY LEVEL B DESIGNATIONS) WERE SUPPLIED BY ILLINOIS DEPARTMENT OF TRANSPORTATION.

FILE NAME = DISUE-SHT-SUEU03.dgn	USER NAME = *USER*	DESIGNED - designed	REVISED -	STATE OF ILLINOIS DEPARTMENT OF TRANSPORTATION FAP ROUTE 345 / US ROUTE 20	SUB-SURFACE UTILITY ENGINEERING U.S. ROUTE 20		F.A.P. RTE. 345	SECTION 8R-HB-2-BY-1	COUNTY KANE	TOTAL SHEETS 434	SHEET NO. 173
PLT SCALE = 5/8"=0'00" / IN.	PLT DATE = 10/15/2010	DRAWN - drawn	REVISED -		SCALE: 1"=50'	SHEET NO. 4 OF 13 SHEETS	STA. 89+00.00 TO STA. 103+50.00	FED. ROAD DIST. NO.	ILLINOIS FED. AID PROJECT	CONTRACT NO. 60K90	
TENG & ASSOCIATES, INC. ENGINEERS/ARCHITECTS/PLANNERS CHICAGO, ILLINOIS		CHECKED - checked	REVISED -								
		DATE - >DAT01	REVISED -								

AMERICAN
 SURVEYING & ENGINEERING, P.C.
 SURVEYORS - ENGINEERS
 GEODESISTS - MAPPING SCIENTISTS
 Chicago 312-277-2000 / Fax 312-277-2002
 Diverse 815-288-6231 / Fax 815-288-6277
 Aurora 630-897-4105 / Fax 630-897-4121
 Illinois Professional Design Firm No. 184-003192