

**ELEVATION**

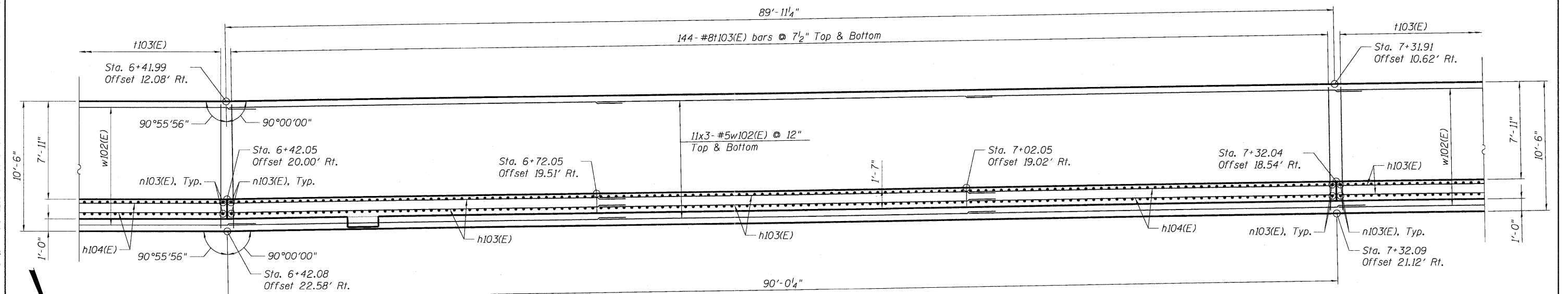

**PLAN**

**Note:**  
See Sht. RW10-2 for notes.

045W010-60K90-005-RET WALL.DGN, \\ALLSUN-60K90-001-BORDER.DGN  
 5-13-2011, 15:28:48  
 HAYMARZ \NF5-004\AMVAUL\_ID-TRANS\_07\2222\3179-001\STRUCT\COA\60K90-045W010-005-RET WALL-SHT.DGN

FILE NAME = \$FILEL\$	USER NAME = #USER\$	DESIGNED - MDB	REVISED -	<b>STATE OF ILLINOIS</b> <b>DEPARTMENT OF TRANSPORTATION</b> US 20 OVER MCLEAN BOULEVARD	<b>WALL PLAN AND ELEVATION</b> <b>4 OF 5</b>			F.A.P. RTE. 345	SECTION 8R-HB-2-BY-1	COUNTY KANE	TOTAL SHEETS 434	SHEET NO. 275
TENG	TENG & ASSOCIATES, INC. ENGINEERS/ARCHITECTS/PLANNERS CHICAGO, ILLINOIS	DRAWN - MDB	REVISED -		SCALE:	SHEET NO. RW10-5	OF RW10-10	STA. 3+90.05	TO STA. 7+92.03	SN 045-W010 CONTRACT NO. 60K90 FED. ROAD DIST. NO. 7 ILLINOIS FED. AID PROJECT		
		CHECKED - PK	REVISED -									
		DATE - 05/18/11	REVISED -									