

DATE	
BY	
REVIEWED	
PLANNED	
NOTED	
NO.	

DATE	
BY	
REVIEWED	
PLANNED	
NOTED	
NO.	

ST-01 STA 501+94.6, 14.4' RT 6' MH TY A W/FR & LIDS T1 CL RIM = 685.80 INV (NE) = 682.30	ST-07 STA 502+68.48, 21.67' LT 2' CB TYPE C W/FR & LIDS TY-1, DL RIM = 686.89 INV (W) = 682.67	ST-13 STA 503+48.01, 24.10' RT 2' CB TY C W/FR & LIDS T1, DL RIM = 686.3 INV (S) = 681.31
ST-02 STA 503+40.0, 10.25' RT 6' MH TYPE A W/FR & LIDS T1 CL RIM = 687.19 INV = 681.70 (N.S)	ST-08 STA 502+48.57, 20.91' LT 2' CB TYPE C W/FR & LIDS T1, DL RIM = 686.76 INV (W) = 682.67	ST-14 STA 503+58.07, 25.31' RT 2' CB TYPE C W/FR & LIDS T1, DL RIM = 688.79 INV (W) = 681.51
ST-03 STA 504+06.6, 28.1' RT 4' CB TY D FR & LIDS TY-1 CL RIM = 689.31 INV = 684.71 (E)	ST-09 STA 504+06.5, 32.65' RT 2' CB TY C W/ TY-24 F&G RIM = 689.25 INV = 684.73 (E.W)	ST-15 STA 504+29.88, 30.71' RT 4' CB TY D W/FR & LIDS TY-1 CL RIM = 690.95 INV (SW) = 681.65 INV (E) = 681.55
ST-04 STA 505+75.21, 73.29' RT EX MH TO BE ADJUSTED RIM = INV (SW) = 681.65	ST-10 STA 504+05.6, 37.34' RT 2' INLET TYPE A W/ TY-9 F&G RIM = 692.02 INV = 684.75	ST-16 EX CB STA 505+32.48, 3.93' RT FR & LIDS TY-1 CL RIM = 694.68 INV (E) = 689.58
ST-05 STA 505+22.12, 34.34' RT 4' CB TY A W/FR & LIDS T1, CL RIM = 694.38 INV (S) = 689.18	ST-11 STA 503+38.0, 24.12' RT 4' CB TY A W/FR & LIDS T1, DL RIM = 684.91 INV = 681.11 (E)	
ST-06 STA 505+19.19, 43.92' RT 2' CB TYPE C W/ TY-24 F&G RIM = 694.06 INV (W) = 689.21	ST-12 STA 503+37.8, 28.59' RT 2' INLET TY A W/ TY-9 F&G RIM = 687.68 INV (SW) = 681.15	

P-01 146 LF-29"X45" ERCP CL A, TY-1, BF=44.1 CY	P-2 94 LF - 36" RCP CL A, TY-1, BF=67.5CY	P-3 158 LF - 36" RCP CL A, TY-1, BF=104.5CY	P-4 11 LF - 15" RCP CL A, TY-1, BF=2.8CY	P-5 11 LF - 15" RCP CL A, TY-1, BF=2.9CY	P-6 5 LF - 15" RCP CL A, TY-1, BF=0.6CY
P-7 10 LF - 15" RCP CL A, TY-1, BF=1.7CY	P-8 10 LF - 15" RCP CL A, TY-1, BF=3.8CY	P-9 5 LF - 12" RCP CL A, TY-1, BF=1.0CY	P-10 5 LF - 12" RCP CL A, TY-1, BF=0.8CY	P-11 11 LF - 12" RCP CL A, TY-1, BF=2.2CY	

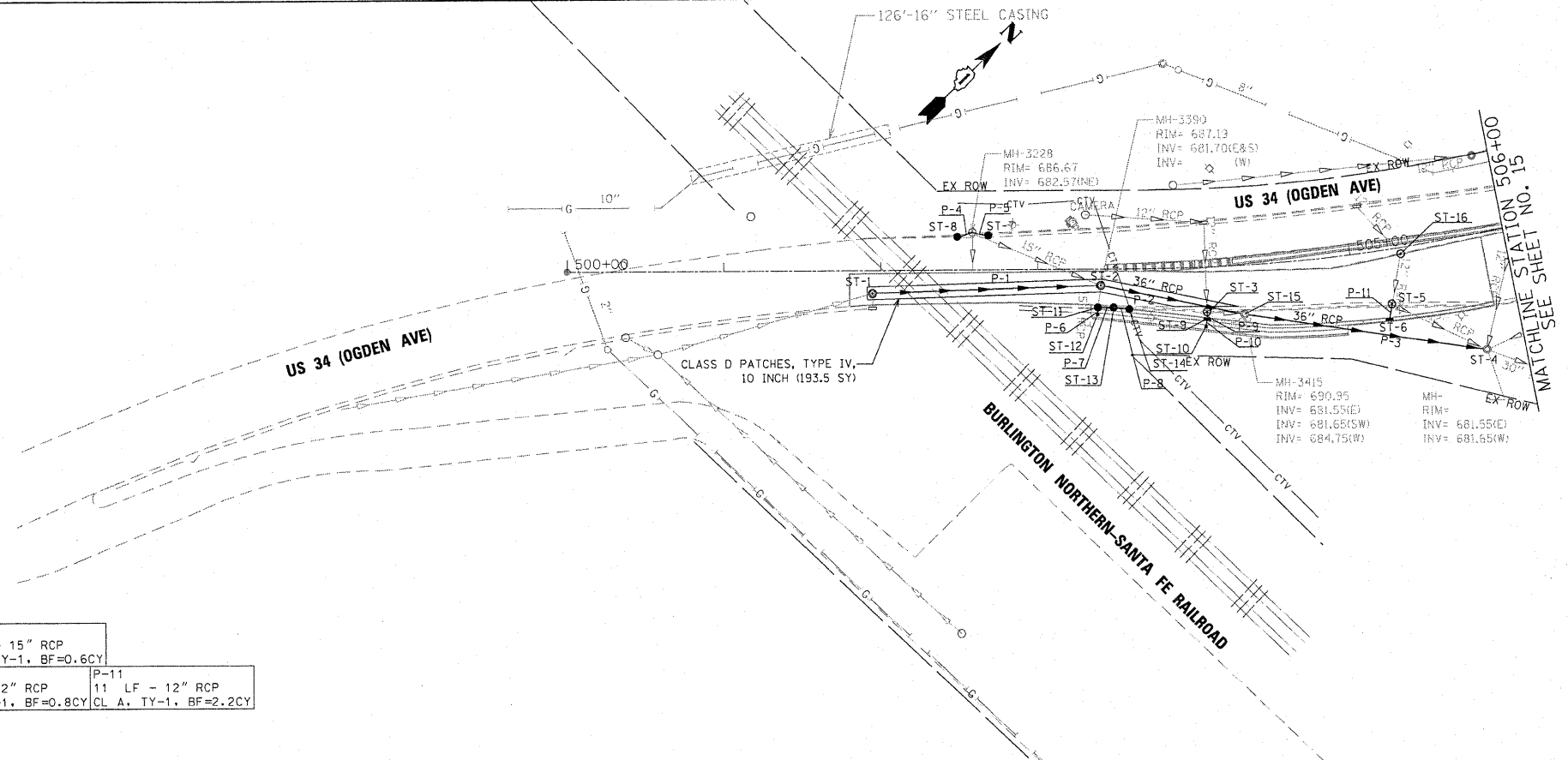

DU-02

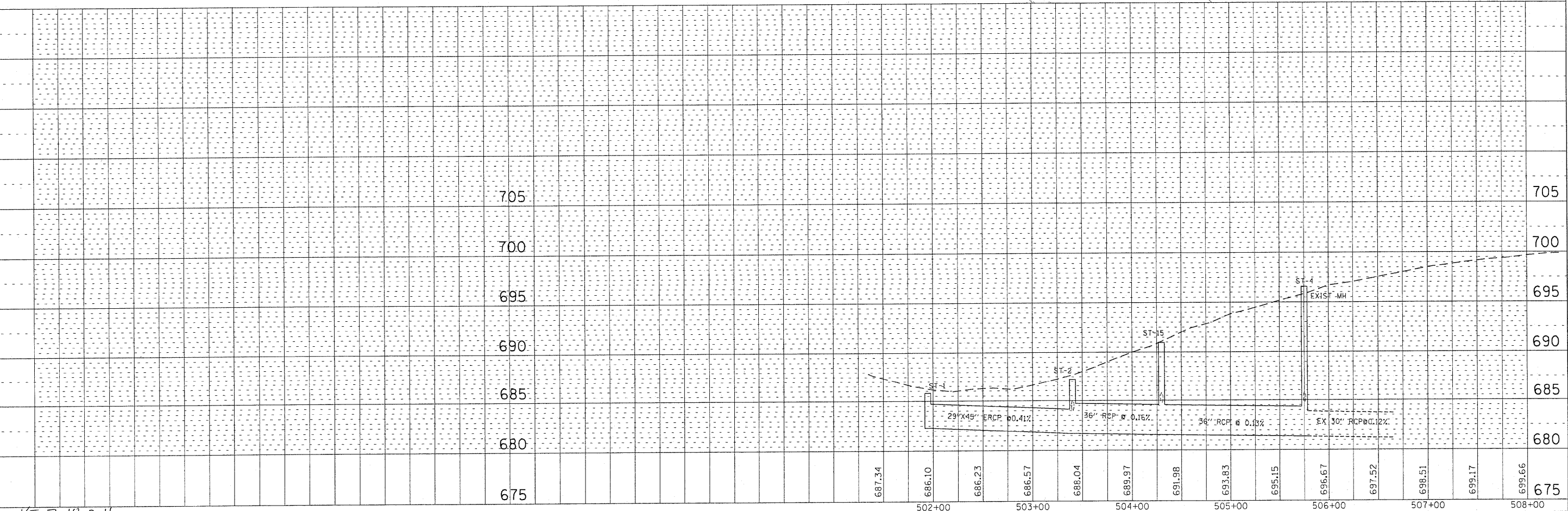

DESIGNED - TVN	REVISED -	STATE OF ILLINOIS DEPARTMENT OF TRANSPORTATION	US ROUTE 34 AT NORTH AURORA ROAD /RAYMOND DRIVE	DRAINAGE AND UTILITY PLAN	F.A.P. RTE. 311	SECTION 652X-N-3	COUNTY DUPAGE	TOTAL SHEETS 34	SHEET NO. 16
DRAWN - TVN	REVISED -							CONTRACT NO. 60L22	
CHECKED - RPD	REVISED -								
DATE - 7/15/2011	REVISED -								

KE 7-18-2011

200 22ND Street, Suite 216, Lombard, IL 60148  
630.705.0110 voice, 630.839.2566 fax  
WWW.MPS-IL.COM

MILLENNIA PROFESSIONAL SERVICES

FILE NAME = P:\2009\ME090806\_Var-Var\_Plan\CADD\W022.US34.Sh-11\DISK\_22-0002.dgn  
PLOT SCALE = 1"=50'  
USER NAME = Millennia Professional Services

FED. ROAD DIST. NO. 1 [ILLINOIS] FED. AID PROJECT  
P:\2009\ME090806\_Var-Var\_Plan\CADD\W022.US34.Sh-11\DISK\_22-0002.dgn