

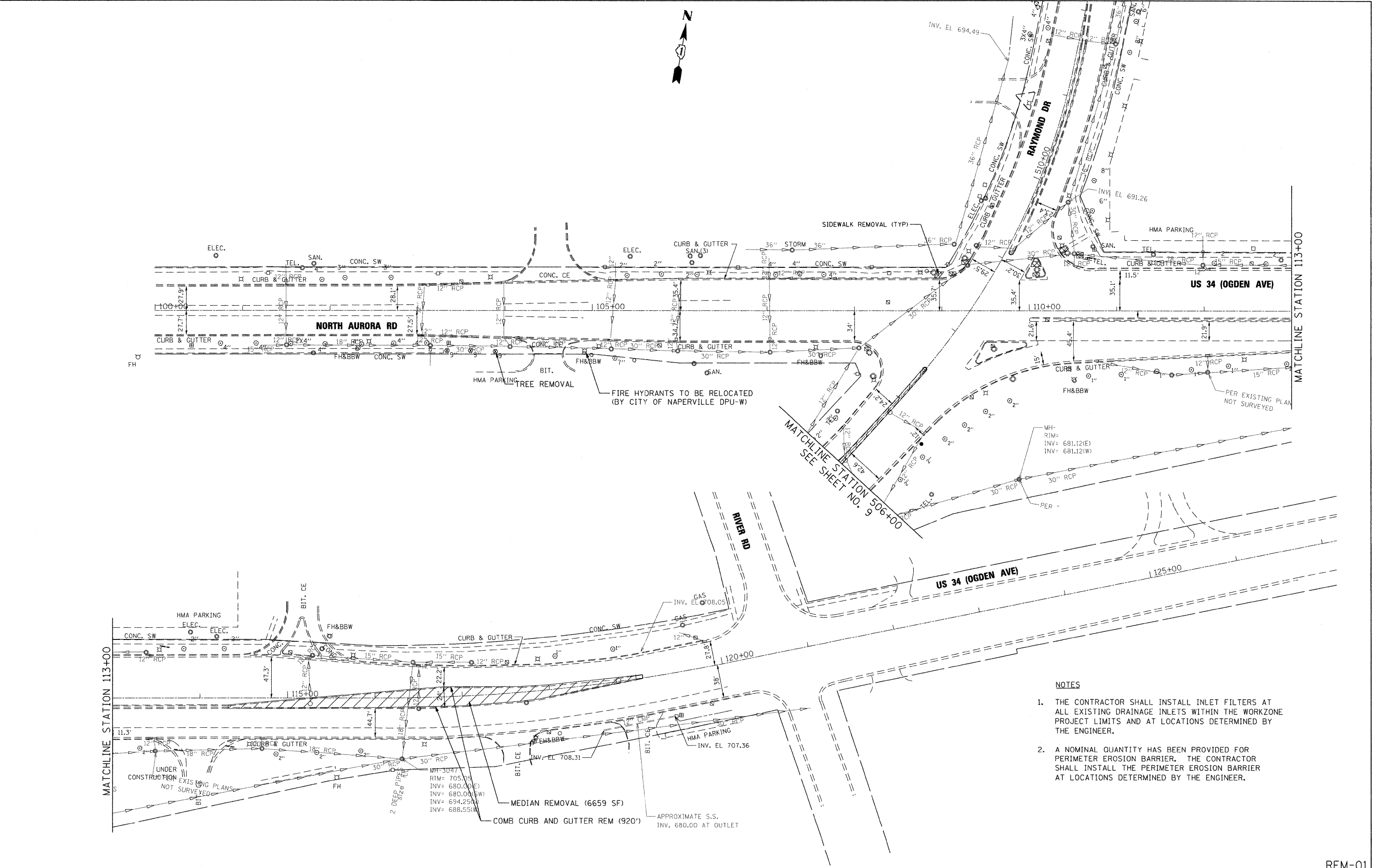

FILE NAME = P:\2009\ME090805\_Va-Vor\_PNT\CADD\W022\_US34\Sh1a\0168L22-EX01.dgn  
 PLOT SCALE = 50.0000' / 1" IN.  
 USER NAME = Millennium Professional Services



- NOTES**
1. THE CONTRACTOR SHALL INSTALL INLET FILTERS AT ALL EXISTING DRAINAGE INLETS WITHIN THE WORKZONE PROJECT LIMITS AND AT LOCATIONS DETERMINED BY THE ENGINEER.
  2. A NOMINAL QUANTITY HAS BEEN PROVIDED FOR PERIMETER EROSION BARRIER. THE CONTRACTOR SHALL INSTALL THE PERIMETER EROSION BARRIER AT LOCATIONS DETERMINED BY THE ENGINEER.



**MILLENNIA PROFESSIONAL SERVICES**  
 200 22ND Street, Suite 216, Lombard, IL 60148  
 630.705.8110 voice, 630.839.2566 fax  
 www.mps-ll.com

DESIGNED - CJD	REVISED -
DRAWN - CJD	REVISED -
CHECKED - TVN	REVISED -
DATE - 5/31/2011	REVISED -

**STATE OF ILLINOIS  
 DEPARTMENT OF TRANSPORTATION**

<b>US ROUTE 34    AT NORTH AURORA ROAD /RAYMOND DRIVE</b>		<b>REMOVAL PLAN</b>	
SCALE: 1"=50'	SHEET NO. 1 OF 2 SHEETS	STA. 100+00	TO STA. 121+00

F.A.P. RTE. 311	SECTION 652X-N-3	COUNTY DUPAGE	TOTAL SHEETS 34	SHEET NO. 8
FED. ROAD DIST. NO. 1 [ILLINOIS] FED. AID PROJECT				CONTRACT NO. 60L22

REM-01

P:\2009\ME090805\_Va-Vor\_PNT\CADD\W022\_US34\Sh1a\0168L22-EX01.dgn