

**INDEX OF SHEETS**

- S1. General Plan and Elevation
- S2. General Notes, Bill of Materials and Index of Sheets
- S3. Stage Construction Details
- S4. Removal Plan
- S5. Wing Wall Details
- S6. Soil Borings

**GENERAL NOTES:**

1. Reinforcement bars shall conform to the requirements of ASTM A 706 Grade 60. See Special Provisions.
2. All reinforcement bars shall be epoxy coated.
3. Plan dimensions and details relative to existing plans are subject to nominal construction variations. The Contractor shall field verify existing dimensions and details affecting new construction and make necessary approved adjustments prior to construction or ordering of materials. Such variations shall not be cause for additional compensation for a change in scope of the work, however, the Contractor will be paid for the quantity actually furnished at the unit price bid for the work.
4. Stage construction shall be utilized to maintain traffic during construction.
5. The Contractor shall make his own investigation to determine the existence, nature, and exact location of all utility lines and appurtenances within the limits of the work. The cost of this work shall be incidental to the contract.
6. Contractor shall exercise caution during excavation around the existing culvert to avoid undermining the foundation.
7. Layout of the slope protection system may be varied to suit ground conditions in the field as directed by the Engineer.
8. If the Contractor chooses to alter the temporary cantilevered sheet piling design requirements shown on the plans, a design submittal including plan details and calculations will be required for review and acceptance by the Engineer.
9. Channel excavation includes removal of sediment from bottom slab of culvert and excavation for riprap installation.

**TOTAL BILL OF MATERIAL**

ITEM DESCRIPTION	UNIT	TOTAL
Concrete Removal	Cu. Yd.	36.3
Stone Rip Rap, Class A4	Sq. Yd.	85
Filter Fabric	Sq. Yd.	85
Temporary Sheet Piling	Sq. Ft.	1,800
Structure Excavation	Cu. Yd.	299
Channel Excavation	Cu. Yd.	223
Reinforcing Bars, Epoxy Coated	Pound	3,970
Concrete Structure	Cu. Yd.	52.8
Geocomposite Wall Drain	Sq. Yd.	42
Porous Granular Embankment, Special	Cu. Yd.	13.8

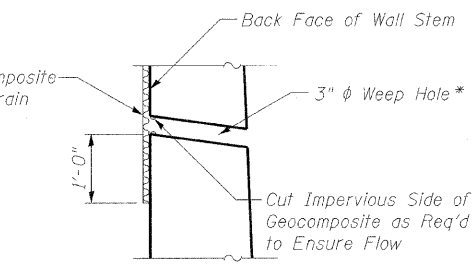
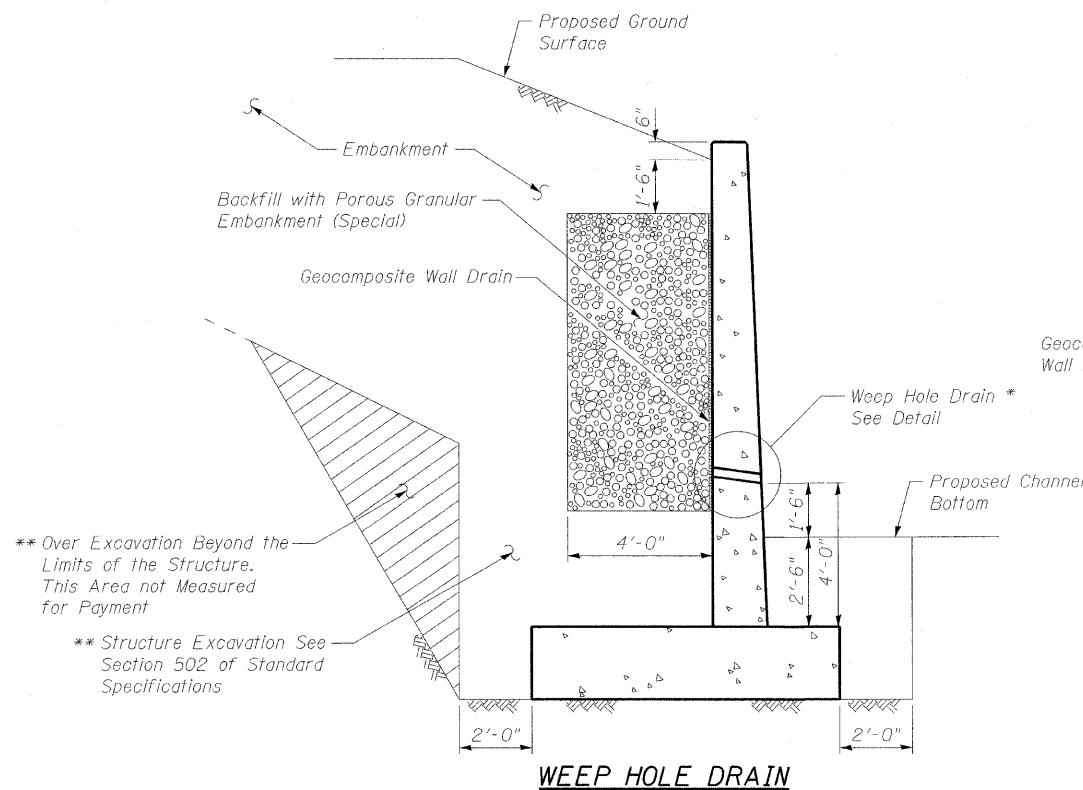

**WEEP HOLE DRAIN DETAIL**

- \* Weep Holes Shall be Centered Along Wing Wall Length.
- \*\* Backfill Remainder of Structure Excavation and Over Excavation Material From Structural Excavation.

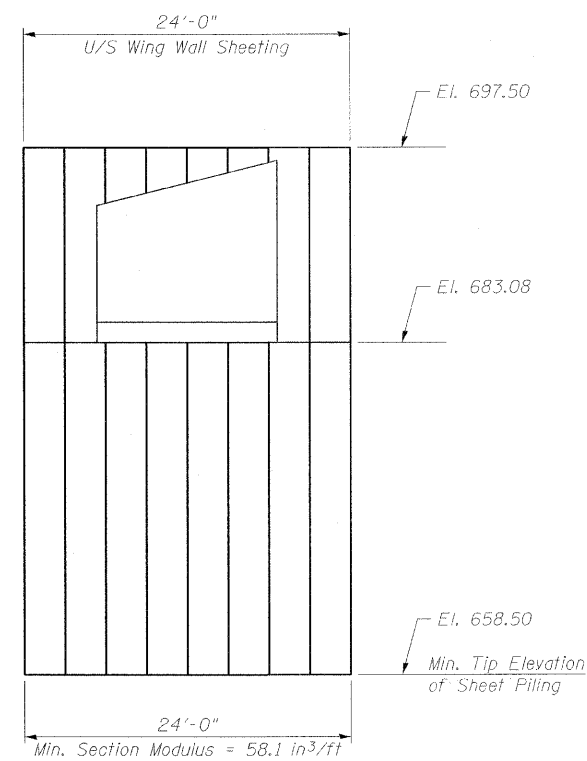

**U/S WING WALL TEMP. SHEET PILING**

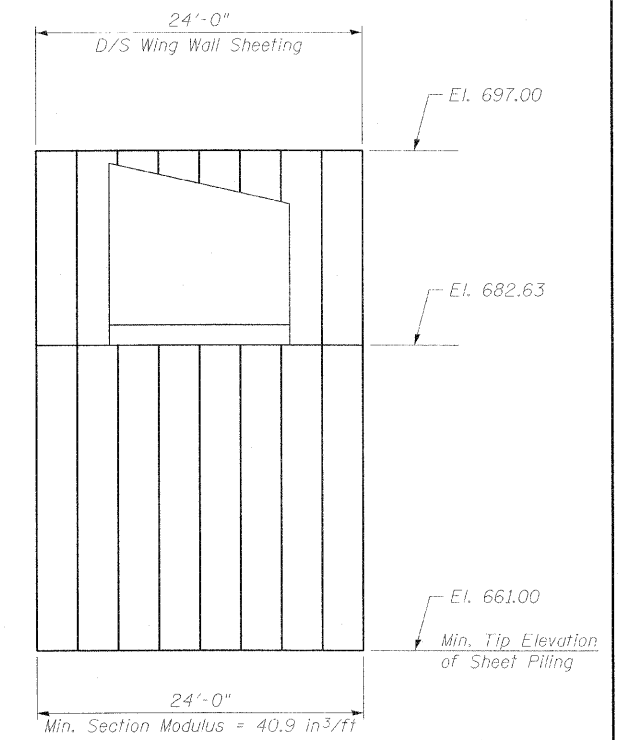

**D/S WING WALL TEMP. SHEET PILING**

FILE NAME =	USER NAME =	DESIGNED - JMS	REVISD -	<b>STATE OF ILLINOIS DEPARTMENT OF TRANSPORTATION</b>	<b>GENERAL NOTES, BILL OF MATERIALS AND INDEX OF SHEETS STRUCTURE NO. 099-0517</b>	F.A.P. RTE. = 332	SECTION = 2010-067-T	COUNTY = WILL	TOTAL SHEETS = 15	SHEET NO. = 8	
PLOT SCALE =	DRAWN - DR	CHECKED - JMS	REVISD -			CONTRACT NO. 60L49					
PLOT DATE =	CHECKED - JMH	DRAWN - DR	REVISD -			ILLINOIS FED. AID PROJECT					
		CHECKED - JMH	REVISD -			SHEET NO. S2 OF S6 SHEETS					