

CAMERA ST 37
BENET LN
SEE SHT NO. 5

FOR CONTINUATION
SEE ABOVE RIGHT

FOR CONTINUATION
SEE ABOVE RIGHT

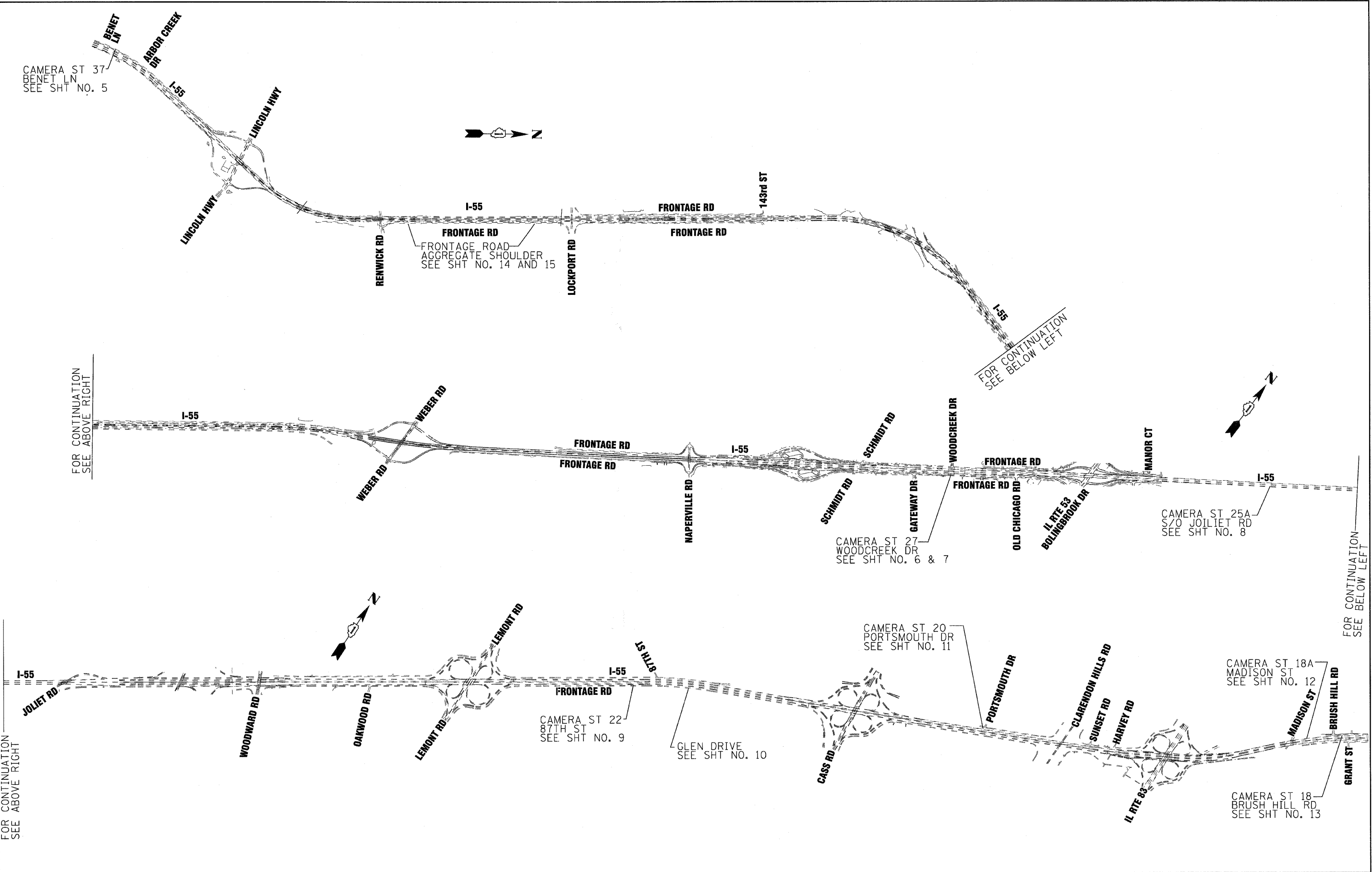

FOR CONTINUATION
SEE BELOW LEFT

FOR CONTINUATION
SEE BELOW LEFT



| | |
|----------------|--------------------------------|
| DESIGNED - DJS | REVISED - |
| DRAWN - UKB | REVISED - |
| CHECKED - LDH | REVISED - |
| DATE - 5-03-11 | FILE - 100153-W0-24-OLYOUT.dgn |

STATE OF ILLINOIS
DEPARTMENT OF TRANSPORTATION

INTERSTATE 55 - US 6 TO WEST OF INTERSTATE 294
GUARDRAIL IMPROVEMENTS
GENERAL LAYOUT

SCALE: 1"=1200'

STA. TO STA.

| F.A.I. RTE. | SECTION | COUNTY | TOTAL SHEETS | SHEET NO. |
|----------------------------------|--------------|-------------|--------------------|-----------|
| 55 | 2011-041-GRR | DUPAGE/WILL | 19 | 4 |
| FED. ROAD DIST. NO. 1 [ILLINOIS] | | | CONTRACT NO. 60P47 | |

FOR CONTINUATION
SEE ABOVE RIGHT

FOR CONTINUATION
SEE ABOVE RIGHT

FOR CONTINUATION
SEE ABOVE RIGHT

FOR CONTINUATION
SEE ABOVE RIGHT

FOR CONTINUATION
SEE ABOVE RIGHT

FOR CONTINUATION
SEE ABOVE RIGHT

FOR CONTINUATION
SEE ABOVE RIGHT

FOR CONTINUATION
SEE ABOVE RIGHT

FOR CONTINUATION
SEE ABOVE RIGHT

FOR CONTINUATION
SEE ABOVE RIGHT

FOR CONTINUATION
SEE ABOVE RIGHT

FOR CONTINUATION
SEE ABOVE RIGHT