

F.A.P. RTE.	SECTION	COUNTY	TOTAL SHEETS	SHEET NO.
—	09-00190-00-BT	COOK	5	1
FED. ROAD DIST. NO.		ILLINOIS	CONTRACT NO. 63230	

INDEX OF SHEETS

1. TITLE SHEET
2. SUMMARY OF QUANTITIES
3. DOUGLAS AVENUE (STA 99+62 TO STA 101+00)
4. DOUGLAS AVENUE (STA 101+00 TO STA 111+80)
5. CROSS SECTIONS

STATE STANDARDS

- 000001-06 STANDARD SYMBOLS, ABBREVIATION, & PATTERNS
- 280001-05 TEMPORARY EROSION CONTROL SYSTEMS
- 424001-05 CURB RAMPS FOR SIDEWALKS
- 604001-03 FRAMES & LIDS, TYPE 1
- 606001-04 CONCRETE CURB, COMBINATION CURB & GUTTER
- 701501-06 URBAN LANE CLOSURE, 2L, 2W, UNDIVIDED
- 701901-01 TRAFFIC CONTROL DEVICES
- 720001-01 SIGN PANEL MOUNTING DETAILS
- 720006-02 SIGN PANEL ERECTION DETAILS
- 720011-01 METAL POSTS FOR SIGNS
- 729001-01 APPLICATIONS OF TYPES A&B METAL POSTS
- 701801-04 LANE CLOSURE MULTILANE 1W OR 2W CROSSWALK OR SIDEWALK CLOSURE

TRAFFIC DATA

DOUGLAS AVENUE ADT: 1,300VPD

POSTED SPEED

DOUGLAS AVENUE 30 MPH
BIKE PATH N/A

DESIGN SPEED

30 MPH
MULTI-USE PATH 15 MPH (PROPOSED)

CLASSIFICATION

SHARED USE PATH



FULL SIZE PLANS HAVE BEEN PREPARED USING STANDARD ENGINEERING SCALES. REDUCED SIZED PLANS WILL NOT CONFORM TO STANDARD SCALES, IN MAKING MEASUREMENTS ON REDUCED PLANS USE THE GRAPHIC SCALES ON DRAWINGS

J.U.L.I.E.
JOINT UTILITY LOCATION INFORMATION FOR EXCAVATION
1-800-892-0123

THE CONTRACTOR SHALL CONTACT THE OWNERS OF ALL UTILITIES 48 HOURS IN ADVANCE OF EXCAVATION. CALL J.U.L.I.E. ; 1-800-892-0123, AND ANY NON-MEMBER UTILITY OWNERS LISTED ON THE PLANS

PROJECT ENGINEER: MICHAEL L. PAGONES, P.E.
PROJECT MANAGER: MICHAEL L. PAGONES, P.E.
CONTRACT NO. 63230

STATE OF ILLINOIS
DEPARTMENT OF TRANSPORTATION
DIVISION OF HIGHWAYS

**PLANS FOR PROPOSED
FEDERAL AID HIGHWAY
DOUGLAS AVENUE MULTI-USE PATH**

FROM US 14 (NORTHWEST HIGHWAY) /
KENSINGTON ROAD TO MINER STREET

SECTION 09-00190-00-BT
PROJECT: CMM-9003(437)
VILLAGE OF ARLINGTON HEIGHTS
WHEELING TOWNSHIP
COOK COUNTY
JOB NO. C-91-872-09

LOCATION MAP

N.T.S.
TOWNSHIP 42 N RANGE 11 E WHEELING TOWNSHIP

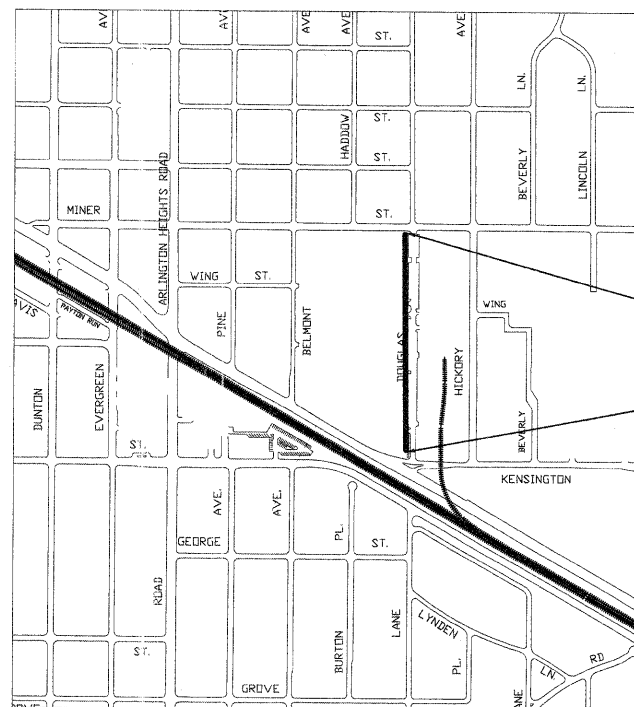

END PROJECT
DOUGLAS AVENUE
STA 111+80

BEGIN PROJECT
DOUGLAS AVENUE
STA 99+62



PROJECT LENGTH

1,218 FT (0.231 MI) NET & GROSS

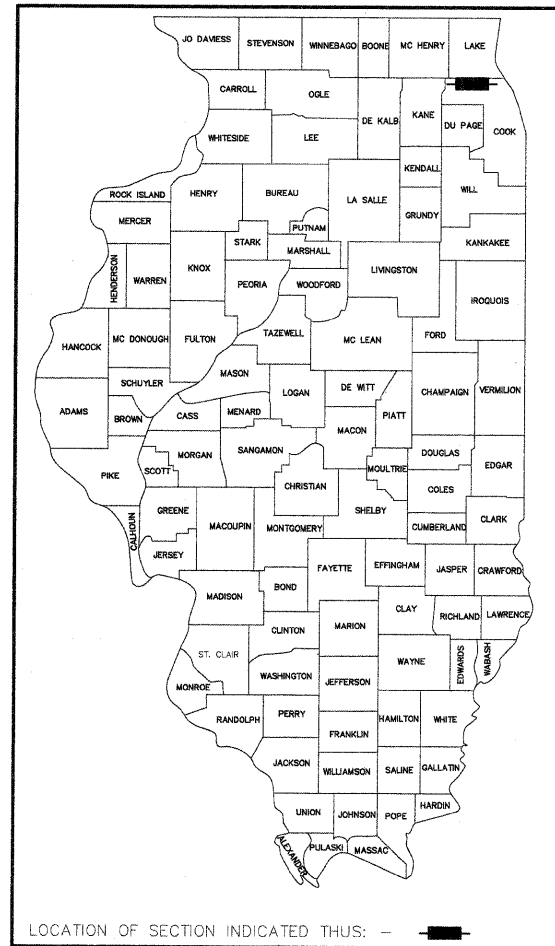

STATE OF ILLINOIS
DEPARTMENT OF TRANSPORTATION
DIVISION OF HIGHWAYS

APPROVED MAY 10, 2011
James J. Massarelli
VILLAGE OF ARLINGTON HEIGHTS

PASSED MAY 25, 2011
Chet Chavert
DISTRICT ONE ENGINEER OF LOCAL ROADS AND STREETS

RELEASING FOR BID
BASED ON LIMITED REVIEW MAY 31, 2011
Diana M. O'Keefe
DEPUTY DIRECTOR OF HIGHWAYS, REGION ONE ENGINEER

PROFESSIONAL ENGINEER'S SIGN & SEAL
James J. Massarelli
JAMES J. MASSARELLI, P.E.
DIRECTOR OF ENGINEERING
VILLAGE OF ARLINGTON HEIGHTS
LICENSES EXPIRES 11/11

**PRINTED BY THE AUTHORITY
OF THE STATE OF ILLINOIS**

PROGRAM AND OFFICE ENGINEER: CHARLES F. RIDDLER, P.E. 1-847-705-4406 SCHAUMBURG, IL
Apr 27, 2011 - 3:20pm
T:\Bicycle Advisory Commission\CHAMMultiUsePath_title_DOT_sht2009.dwg