

|                     |                |          |                    |           |
|---------------------|----------------|----------|--------------------|-----------|
| F.A.P. RTE.         | SECTION        | COUNTY   | TOTAL SHEETS       | SHEET NO. |
| ---                 | 09-00190-00-BT | COOK     | 5                  | 4         |
| FED. ROAD DIST. NO. |                | ILLINOIS | CONTRACT NO. 63230 |           |

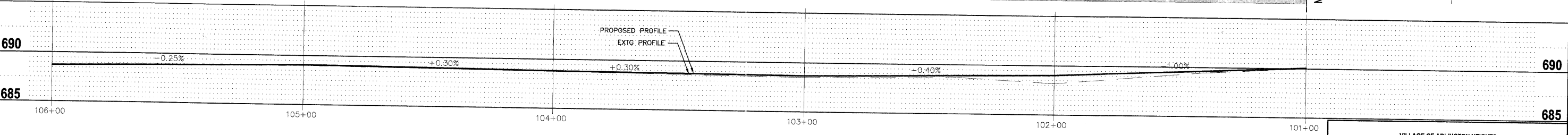
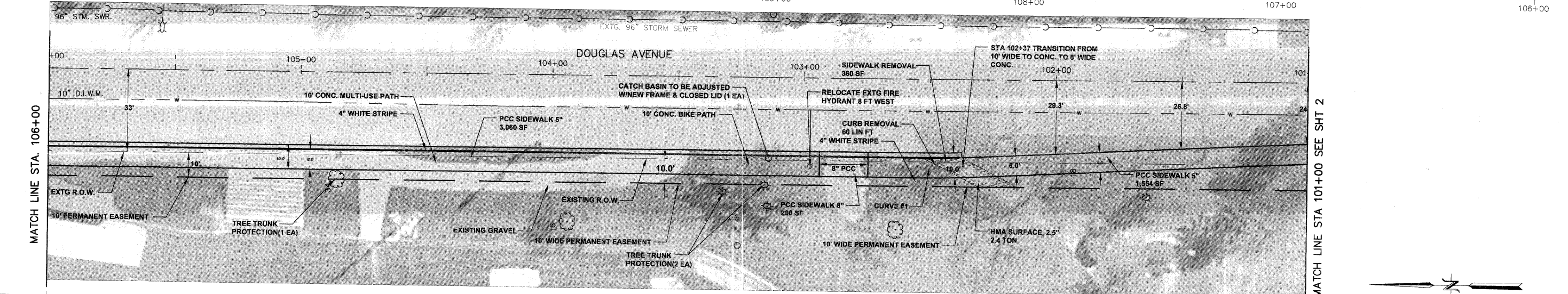
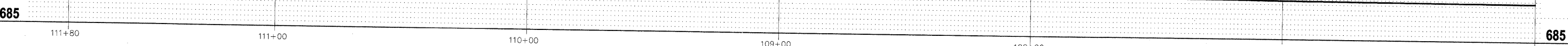
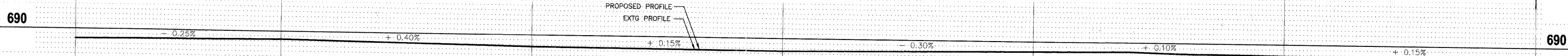
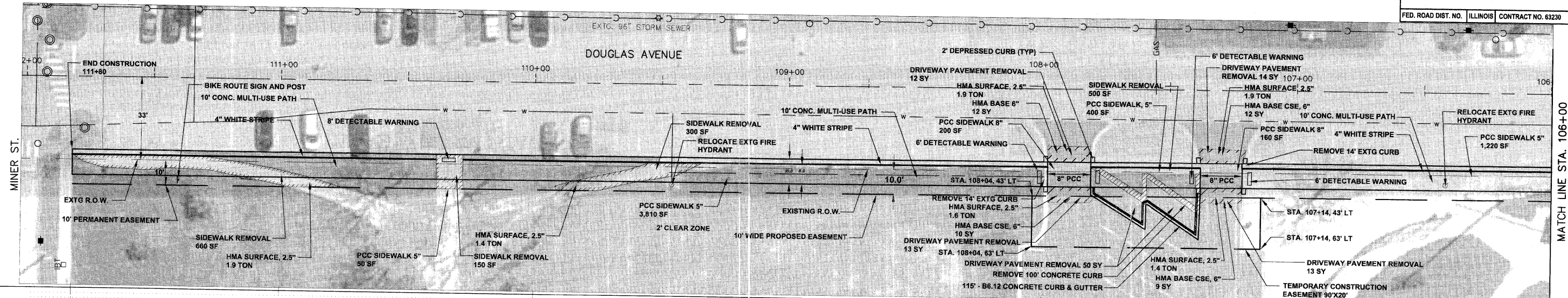

| REVISIONS |      |
|-----------|------|
| NAME      | DATE |
|           |      |
|           |      |
|           |      |

VILLAGE OF ARLINGTON HEIGHTS

**MULTI-USE PATH**  
(STA 101+00 TO STA 111+80)

DATE: 05/20/2009  
DESIGNED BY: M. PAGONES P.E.  
DRAWN BY: C. HOMUTH  
CHECKED BY: J. MASSARELLI P.E.

0' 20' 40'

1" = 20' (HORIZ.)  
1" = 5' (VERT.)

DRAWING NAME: N:\Bicycle Advisory Commission\CMAQ\bikepath\park.dwg May 24, 2011 - 5:56pm