

F.A.P. RTE.	SECTION	COUNTY	TOTAL SHEETS	SHEET NO.
—	09-00190-00-BT	COOK	5	1
FED. ROAD DIST. NO.		ILLINOIS	CONTRACT NO. 63230	

INDEX OF SHEETS

1. TITLE SHEET
2. SUMMARY OF QUANTITIES
3. DOUGLAS AVENUE (STA 99+62 TO STA 101+00)
4. DOUGLAS AVENUE (STA 101+00 TO STA 111+80)
5. CROSS SECTIONS

STATE STANDARDS

- 000001-06 STANDARD SYMBOLS, ABBREVIATION, & PATTERNS
- 280001-05 TEMPORARY EROSION CONTROL SYSTEMS
- 424001-05 CURB RAMPS FOR SIDEWALKS
- 604001-03 FRAMES & LIDS, TYPE 1
- 606001-04 CONCRETE CURB, COMBINATION CURB & GUTTER
- 701501-06 URBAN LANE CLOSURE, 2L, 2W, UNDIVIDED
- 701901-01 TRAFFIC CONTROL DEVICES
- 720001-01 SIGN PANEL MOUNTING DETAILS
- 720006-02 SIGN PANEL ERECTION DETAILS
- 720011-01 METAL POSTS FOR SIGNS
- 729001-01 APPLICATIONS OF TYPES A&B METAL POSTS
- 701801-04 LANE CLOSURE MULTILANE 1W OR 2W CROSSWALK OR SIDEWALK CLOSURE

TRAFFIC DATA

DOUGLAS AVENUE ADT: 1,300VPD

POSTED SPEED

DOUGLAS AVENUE 30 MPH
BIKE PATH N/A

DESIGN SPEED

30 MPH
MULTI-USE PATH 15 MPH (PROPOSED)

CLASSIFICATION

SHARED USE PATH



FULL SIZE PLANS HAVE BEEN PREPARED USING STANDARD ENGINEERING SCALES. REDUCED SIZED PLANS WILL NOT CONFORM TO STANDARD SCALES, IN MAKING MEASUREMENTS ON REDUCED PLANS USE THE GRAPHIC SCALES ON DRAWINGS

J.U.L.I.E.
JOINT UTILITY LOCATION INFORMATION FOR EXCAVATION
1-800-892-0123

THE CONTRACTOR SHALL CONTACT THE OWNERS OF ALL UTILITIES 48 HOURS IN ADVANCE OF EXCAVATION. CALL J.U.L.I.E. ; 1-800-892-0123, AND ANY NON-MEMBER UTILITY OWNERS LISTED ON THE PLANS

PROJECT ENGINEER: MICHAEL L. PAGONES, P.E.
PROJECT MANAGER: MICHAEL L. PAGONES, P.E.
CONTRACT NO. 63230

STATE OF ILLINOIS
DEPARTMENT OF TRANSPORTATION
DIVISION OF HIGHWAYS

**PLANS FOR PROPOSED
FEDERAL AID HIGHWAY
DOUGLAS AVENUE MULTI-USE PATH**

FROM US 14 (NORTHWEST HIGHWAY) /
KENSINGTON ROAD TO MINER STREET

SECTION 09-00190-00-BT
PROJECT: CMM-9003(437)
VILLAGE OF ARLINGTON HEIGHTS
WHEELING TOWNSHIP
COOK COUNTY
JOB NO. C-91-872-09

LOCATION MAP

N.T.S.
TOWNSHIP 42 N RANGE 11 E WHEELING TOWNSHIP

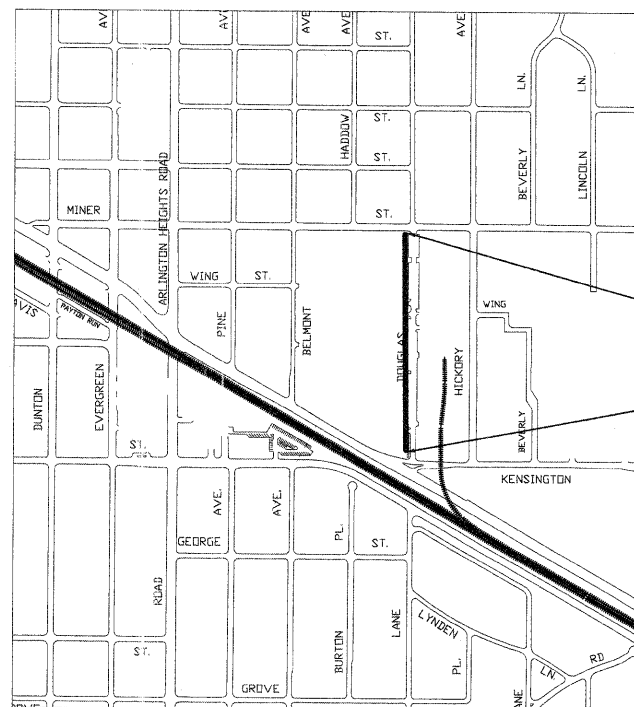

END PROJECT
DOUGLAS AVENUE
STA 111+80

BEGIN PROJECT
DOUGLAS AVENUE
STA 99+62



PROJECT LENGTH

1,218 FT (0.231 MI) NET & GROSS

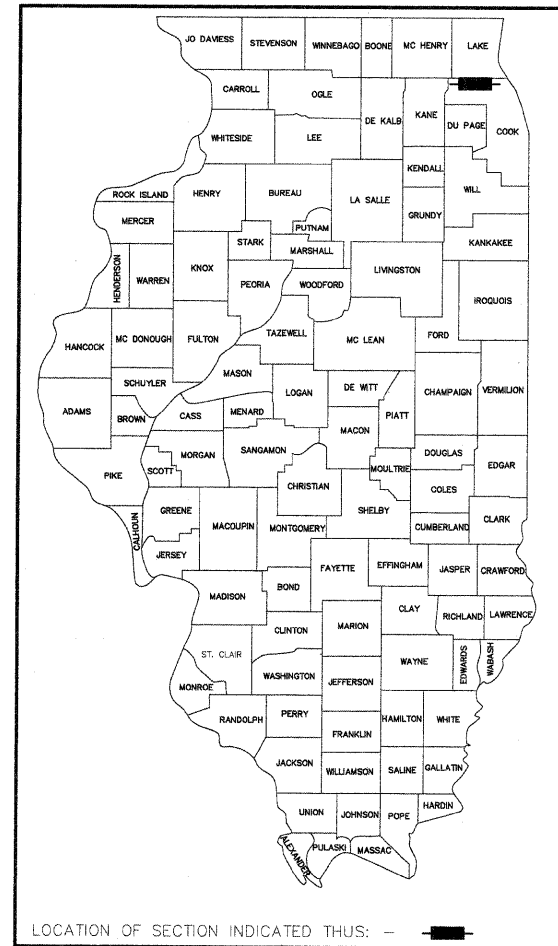

STATE OF ILLINOIS
DEPARTMENT OF TRANSPORTATION
DIVISION OF HIGHWAYS

APPROVED MAY 10, 2011
James J. Massarelli
VILLAGE OF ARLINGTON HEIGHTS

PASSED MAY 25, 2011
Chet Chavert
DISTRICT ONE ENGINEER OF LOCAL ROADS AND STREETS

RELEASING FOR BID
BASED ON LIMITED REVIEW MAY 31, 2011
Diana M. O'Keefe
DEPUTY DIRECTOR OF HIGHWAYS, REGION ONE ENGINEER

PROFESSIONAL ENGINEER'S SIGN & SEAL
James J. Massarelli
JAMES J. MASSARELLI, P.E.
DIRECTOR OF ENGINEERING
VILLAGE OF ARLINGTON HEIGHTS
LICENSES EXPIRES 11/11

**PRINTED BY THE AUTHORITY
OF THE STATE OF ILLINOIS**

PROGRAM AND OFFICE ENGINEER: CHARLES F. RIDDLER, P.E. 1-847-705-4406 SCHAUMBURG, IL
Apr 27, 2011 - 3:20pm
T:\Bicycle Advisory Commission\CHAMMultiUsePath_title_DOT_sht2009.dwg

F.A.P. RTE.	SECTION	COUNTY	TOTAL SHEETS	SHEET NO.
---	09-00190-00-BT	COOK	5	2
SUMMARY OF QUANTITIES & TYPICAL SECTIONS				
FED. ROAD DIST. NO.		ILLINOIS	CONTRACT NO. 63230	

SUMMARY OF QUANTITIES

CODE NO.	PAY ITEM	UNIT	TOTAL QUANTITY	CONSTRUCTION TYPE CODE	
				CMAQ FUNDS	LOCAL
20101100	TREE TRUNK PROTECTION	EACH	3	75% FED	25% LOCAL
20200100	EARTH EXCAVATION	CU YD	225		
20400800	FURNISHED EXCAVATION	CU YD	6		
21101505	TOPSOIL EXCAVATION AND PLACEMENT	CU YD	15		
25000110	SEEDING, CLASS 1A	ACRE	0.25		
25000400	NITROGEN FERTILIZER NUTRIENT	POUND	4		
25000500	PHOSPHOROUS FERTILIZER NUTRIENT	POUND	4		
25000800	POTASSIUM FERTILIZER NUTRIENT	POUND	4		
28000400	PERIMETER EROSION BARRIER	FOOT	1,500		
28000510	INLET FILTERS	EACH	1		
35101500	AGGREGATE BASE COURSE, TYPE B	CU YD	85		
35501308	HOT-MIX ASPHALT BASE COURSE, 6"	SQ YD	35		
40603310	HOT-MIX ASPHALT SURFACE COURSE, MIX "C", N50	TON	16		
42400200	PORTLAND CEMENT CONCRETE SIDEWALK 5 INCH	SQ FT	10,948		
42400410	PORTLAND CEMENT CONCRETE SIDEWALK 8 INCH	SQ FT	760		
42400800	DETECTABLE WARNINGS	SQ FT	88		
44000200	DRIVEWAY PAVEMENT REMOVAL	SQ YD	142		
44000300	CURB REMOVAL	FOOT	60		
44000500	COMBINATION CURB AND GUTTER REMOVAL	FOOT	134		
44000800	SIDEWALK REMOVAL	SQ FT	2,915		
* 56400800	FIRE HYDRANT AND VALVE TO BE MOVED	EACH	3		
60250500	CATCH BASINS TO BE ADJUSTED WITH NEW TYPE 1 FRAME, CLOSED LID	EACH	1		
60603800	COMBINATION CONCRETE CURB AND GUTTER, TYPE B-6.12	FOOT	130		
67100100	MOBILIZATION	L SUM	1		
70102620	TRAFFIC CONTROL & PROTECTION, STANDARD 701501	L SUM	1		
70102640	TRAFFIC CONTROL & PROTECTION, STANDARD 701801	L SUM	1		
72000100	SIGN PANEL - TYPE 1	SQ FT	6		
72900100	METAL POST - TYPE A	FOOT	22		
* 78001110	PAINT PAVEMENT MARKING - LINE 4"	FOOT	910		
X4021000	TEMPORARY ACCESS (PRIVATE ENTRANCE)	EACH	1		

* SPECIALTY ITEMS

HOT-MIX ASPHALT MIXTURE REQUIREMENTS

MIXTURE TYPE	AIR VOIDS
DRIVEWAYS	
HOT-MIX ASPHALT SURFACE COURSE, MIX C, N50 (IL-9.5mm); 2.5"	4% @ 50 Gyr.
HOT-MIX ASPHALT BASE COURSE, 6" (HMA BINDER IL-19mm) (IN 2 LIFTS)	4% @ 50 Gyr.
ASPHALT WALKWAY REPAIR	
HOT-MIX ASPHALT SURFACE COURSE, MIX C, N50 (IL-9.5mm); 2.5"	4% @ 50 Gyr.

THE UNIT WEIGHT USED TO CALCULATE ALL HMA SURFACE MIXTURE QUANTITIES IS 112 LBS/SQ YD IN.
 The "AC Type" for Polymerized HMA mixes shall be "SBS/SBR PG 70-22" and for Non-Polymerized HMA, the "AC Type" shall be "PG 64-22" unless modified by District One special provisions.
 For

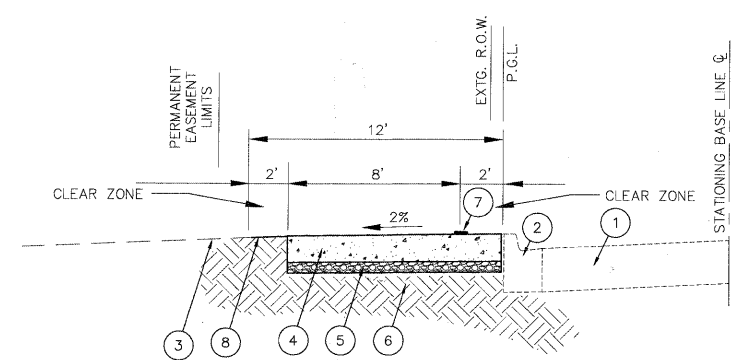

- 1 EXISTING PAVEMENT
- 2 EXISTING CURB AND GUTTER
- 3 EXISTING GROUND
- 4 PROPOSED 5" OR 8" P.C.C. SIDEWALK
- 5 PROPOSED 2" AGGREGATE BASE COURSE, TY B
- 6 EXISTING SUBGRADE
- 7 PROPOSED 4" WHITE PAINT STRIPE
- 8 PROPOSED TOPSOIL AND SEEDING

TYPICAL SECTION

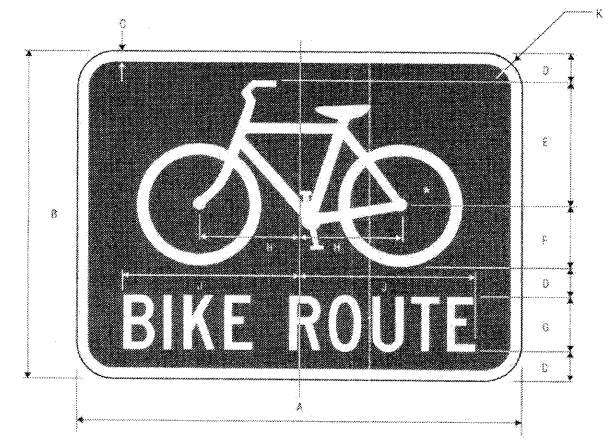

D11-1
BICYCLE ROUTE

*See page 6-7 for symbol design.

A	B	C	D	E	F	G	H	J	K
24	18	5	1.5	7	3.5	3C	5.5	9.5	1.5

COLORS: LEGEND WHITE (RETROREFLECTIVE)
 SYMBOL WHITE (RETROREFLECTIVE)
 BACKGROUND GREEN (RETROREFLECTIVE)

3-84

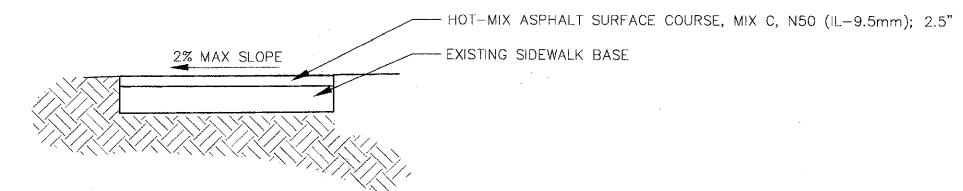

ASPHALT WALKWAY REPAIR DETAIL

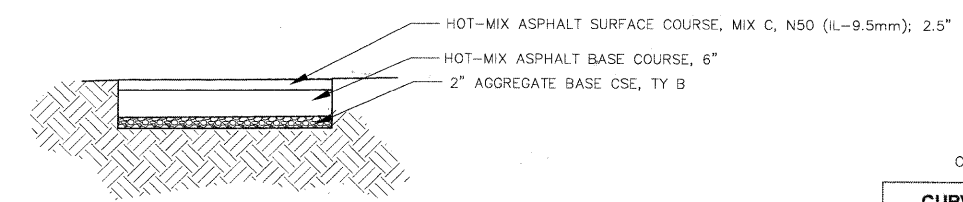

DRIVEWAY PAVEMENT DETAIL

GENERAL NOTES

- GRASS SEED SHALL BE A MIXTURE CONTAINING SALT-TOLERANT VARIETIES MEETING THE SPECIFICATION FOR CLASS 1A, SALT TOLERANT LAWN MIXTURE AS STATED IN ARTICLE 250.07 OF THE STANDARD SPECIFICATIONS
- THE CONTRACTOR SHALL USE DETECTABLE WARNING PLATES MANUFACTURED BY EAST JORDAN IRON WORKS OR APPROVED EQUAL. EACH PLATE SHALL BE 24"X24", UNCOATED.
- THE CONTRACTOR SHALL TAKE APPROPRIATE MEASURES TO CONTROL DUST AT ALL TIMES AS DIRECTED BY THE ENGINEER.
- SAW CUTS SHALL BE FULL DEPTH AS APPROPRIATE TO THE ITEM BEING CUT.

CURVE #1

CURVE DATA	
Δ = 3' 00' 35"	
D = 12.29528	
T = 12.24'	
R = 466.00'	
L = 24.48'	
C = 24.48'	
E = 0.16'	
P.C. STA. = 102+29.08	
P.I. STA. = 102+41.32	
P.T. STA. = 102+53.56	

REVISIONS	
NAME	DATE

VILLAGE OF ARLINGTON HEIGHTS

SUMMARY OF QUANTITIES TYPICAL SECTIONS DETAILS

DATE: 05/20/2009
 DESIGNED BY: M. PAGONES P.E.
 DRAWN BY: C. HOMUTH
 CHECKED BY: J. MASSARELLI P.E.

0' 20' 40'

1" = 20' (HORIZ.)
 1" = 5' (VERT.)

DRAWING NAME: N:\Bicycle Advisory Commission\CMAQ\Bikepath\parkENV.dwg May 24, 2011 - 5:59pm

F.A.P. RTE.	SECTION	COUNTY	TOTAL SHEETS	SHEET NO.
--	09-00190-00-BT	COOK	5	3
STA 99+62 TO STA 101+00				
FED. ROAD DIST. NO.		ILLINOIS	CONTRACT NO. 63230	

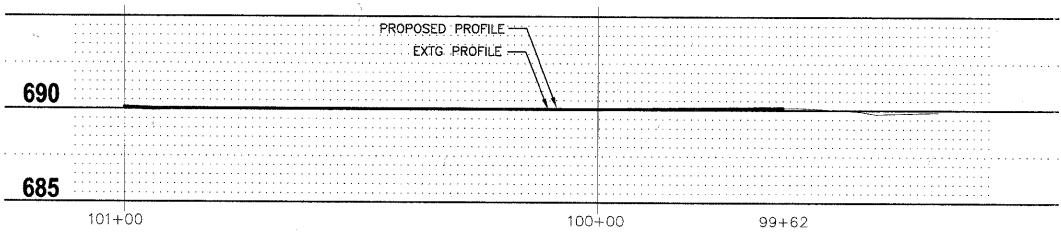
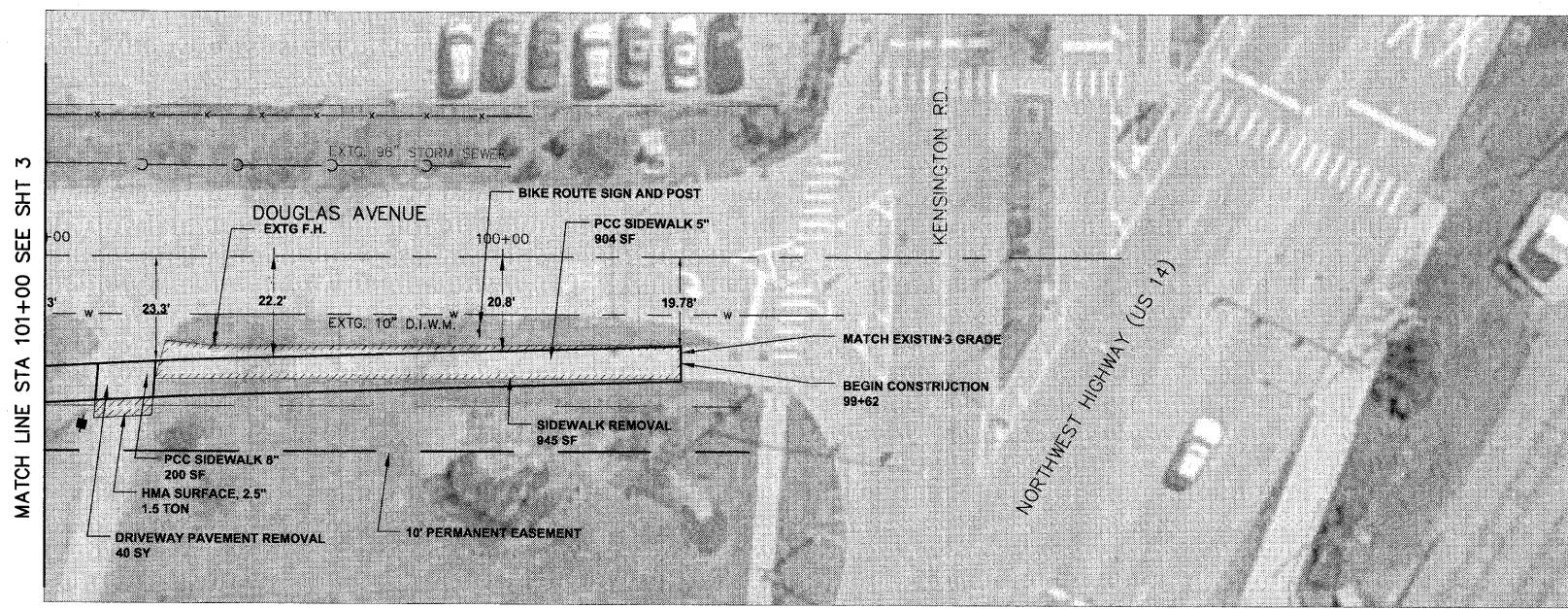

DRAWING NAME: N:\Bicycle Advisory Commission\CMAQ\bikepathpark.dwg May 24, 2011 - 5:34pm

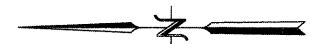

REVISIONS	
NAME	DATE

VILLAGE OF ARLINGTON HEIGHTS

MULTI-USE PATH
(STA 99+62 TO STA 101+00)

1" = 20' (HORIZ.)
1" = 5' (VERT.)

DATE: 05/20/2009
DESIGNED BY: M. PAGONES P.E.
DRAWN BY: C. HOMUTH
CHECKED BY: J. MASSARELLI P.E.

F.A.P. RTE.	SECTION	COUNTY	TOTAL SHEETS	SHEET NO.
---	09-00190-00-BT	COOK	5	4
FED. ROAD DIST. NO.		ILLINOIS	CONTRACT NO. 63230	

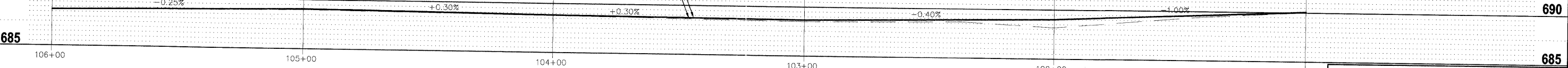
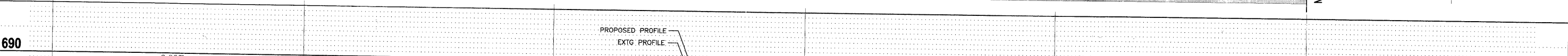
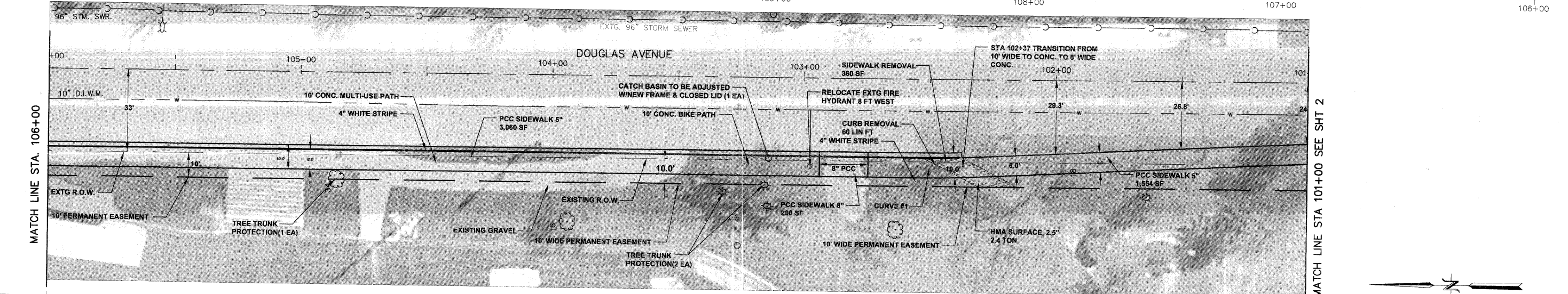
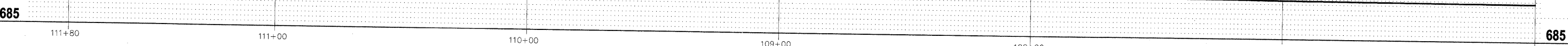
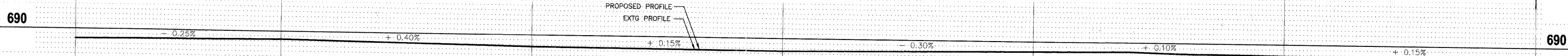
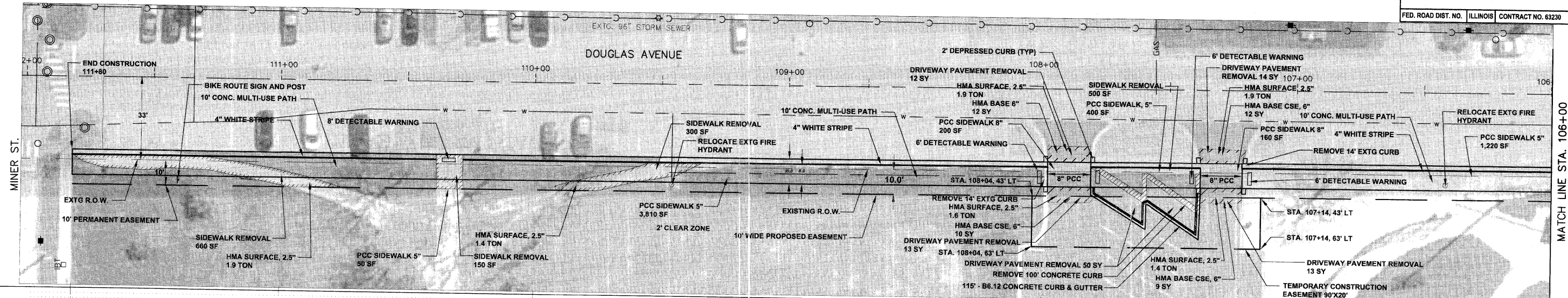

REVISIONS	
NAME	DATE

VILLAGE OF ARLINGTON HEIGHTS

MULTI-USE PATH
(STA 101+00 TO STA 111+80)

DATE: 05/20/2009
DESIGNED BY: M. PAGONES P.E.
DRAWN BY: C. HOMUTH
CHECKED BY: J. MASSARELLI P.E.

DRAWING NAME: N:\Bicycle Advisory Commission\CMAQ\bikepath\park.dwg May 24, 2011 - 5:56pm

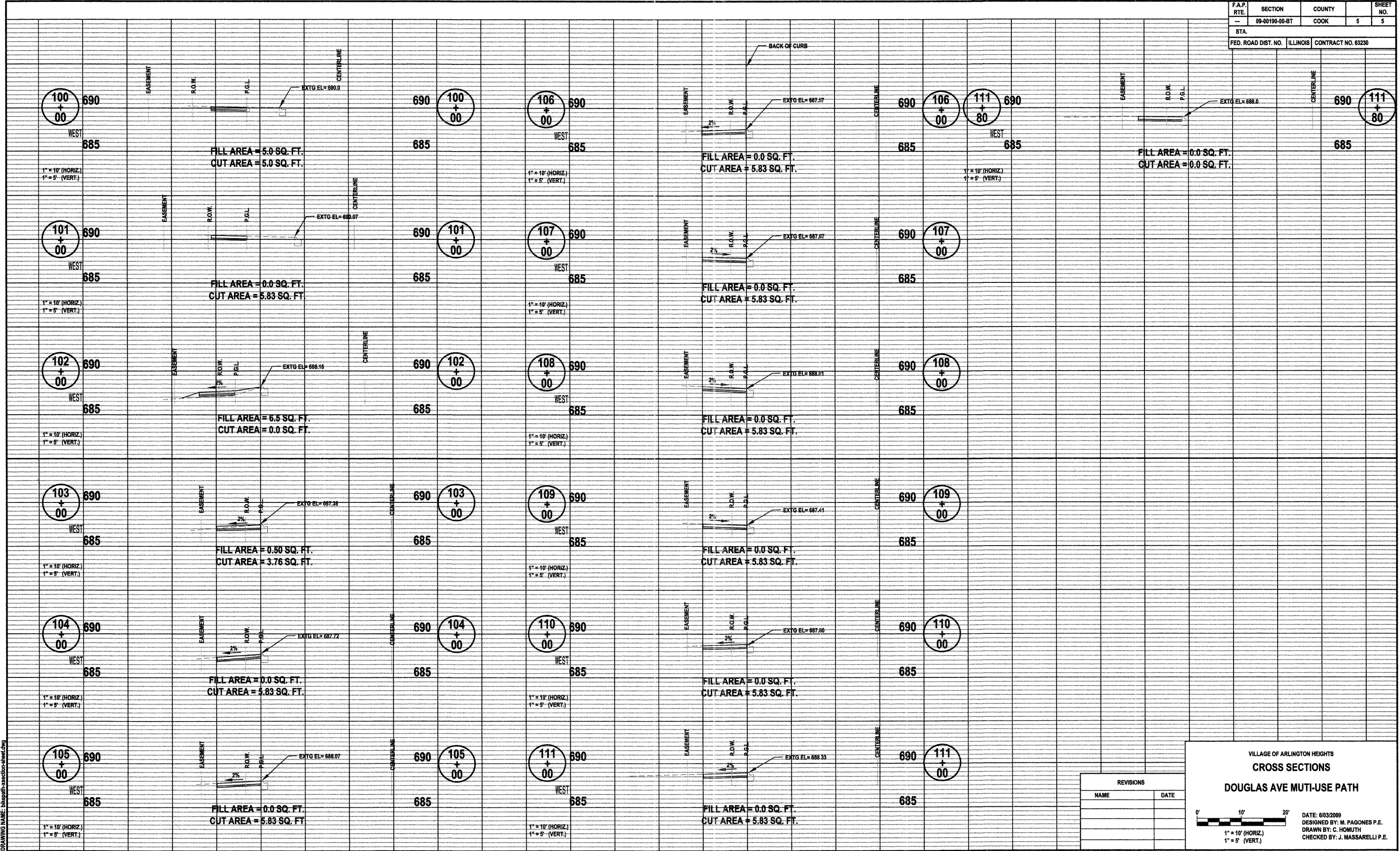

DRAWING NAME: h:\project\sections\sheet.dwg

REVISIONS	
NAME	DATE

VILLAGE OF ARLINGTON HEIGHTS
CROSS SECTIONS
DOUGLAS AVE MUTI-USE PATH

0' 10' 20'

1" = 10' (HORIZ.)
1" = 5' (VERT.)

DATE: 6/03/2009
DESIGNED BY: M. PAGONES P.E.
DRAWN BY: C. HOMUTH
CHECKED BY: J. MASSARELLI P.E.