

F.A.U. RTE.	SECTION	COUNTY	TOTAL SHEETS	SHEET NO.
0085	00-00246-02-FP	MCHENRY	292	085
STA.		TO STA.		
FED. ROAD DIST. NO. 1		ILLINOIS FED. AID PROJECT		
CONTRACT NO: 63522				

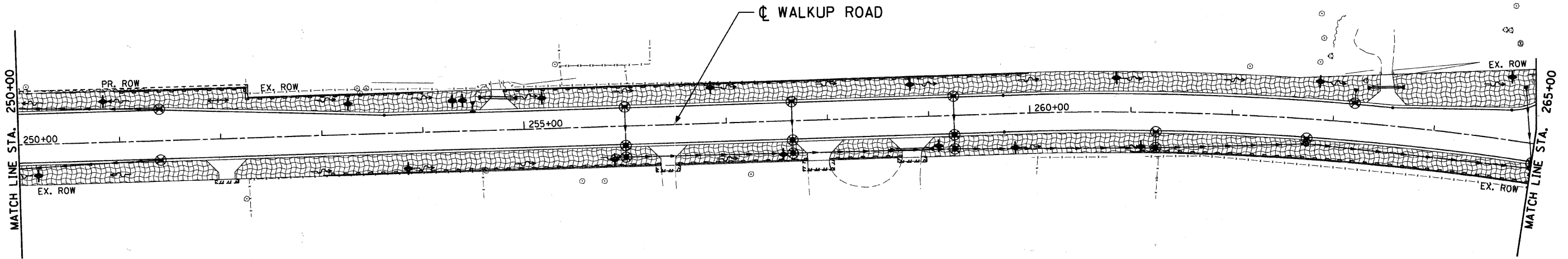

**LEGEND**

SEE SCHEDULE OF QUANTITIES FOR EROSION & SEDIMENT CONTROL DETAILS

- |  |                                   |  |   |
|--|-----------------------------------|--|---|
|  | TREE TRUNK PROTECTION             |  | INLET FILTER  |
|  | TEMPORARY EROSION CONTROL SEEDING |  | DRAINAGE OUTLET   |
|  | WETLAND                           |  | TEMPORARY DITCH CHECK   |
|  | STONE RIPRAP                      |  | PERIMETER EROSION BARRIER   |
|  |                                   |  | TEMPORARY SEDIMENT BASIN (5'W X 10'L X 2'D) & AGGREGATE (EROSION CONTROL) AT LIP OF BASIN |

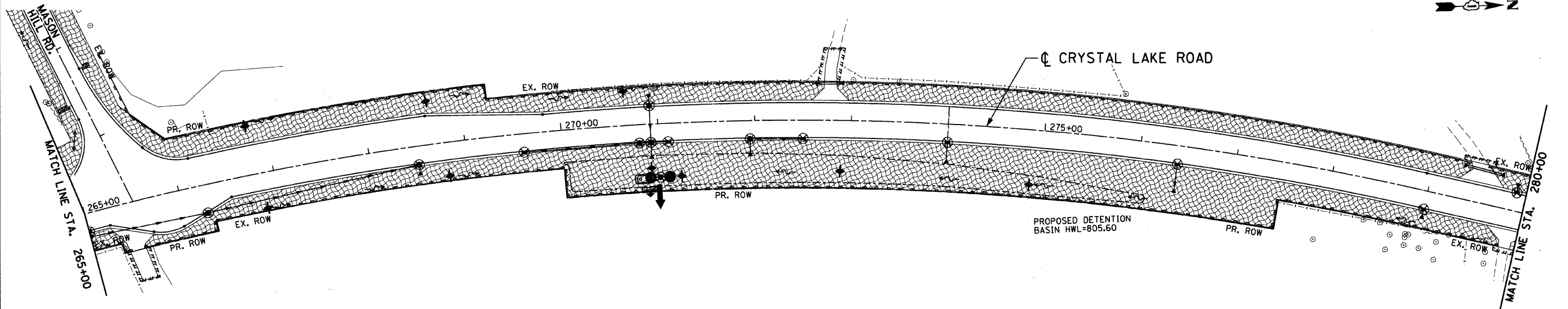

REVISIONS	
NAME	DATE

MCHENRY COUNTY DIVISION OF TRANSPORTATION  
WALKUP ROAD F.A.U. 0085

**EROSION & SEDIMENT CONTROL  
WALKUP/CRYSTAL LAKE ROAD  
STA 250+00 TO STA 280+00**

SCALE: 1" = 50'  
DATE: 04/15/11

DRAWN BY: LK  
CHECKED BY: TL

**TENG**

TENG & ASSOCIATES, INC.  
ENGINEERS/ARCHITECTS/PLANNERS  
305 N. MICHIGAN AVE. CHICAGO, IL 60601  
TELEPHONE: 312.488.4000

N:\AL02\002.DGN, .. E:\02\002.DGN, .. P:\02\002.DGN, .. S:\02\002.DGN, .. T:\02\002.DGN, .. V:\02\002.DGN, .. W:\02\002.DGN, .. X:\02\002.DGN, .. Y:\02\002.DGN, .. Z:\02\002.DGN, ..  
 4-14-2011 15:48:21  
 1 2 3 4 5 6 7 8 9 10 11 12 13 14 15 16 17 18 19 20 21 22 23 24 25 26 27 28 29 30 31 32 33 34 35 36 37 38 39 40 41 42 43 44 45 46 47 48 49 50 51 52 53 54 55 56 57 58 59 60 61 62 63