

DATE	BY

DATE	BY

FINAL SURVEY NOTE BOOK NO. _____ DATE _____
 SURVEYED BY _____
 CHECKED BY _____
 NO. _____
 PLOTTED BY _____
 NO. _____
 DATE _____
 CHECKED BY _____
 NO. _____

PROJECT: 0085 DO-00246-02-FF STA. 49+00.00 TO STA. 52+92.72
 COUNTY: MCHENRY
 FEDERAL AID PROJECT: ILLINOIS FED. AID PROJECT
 CONTRACT NO.: 63522

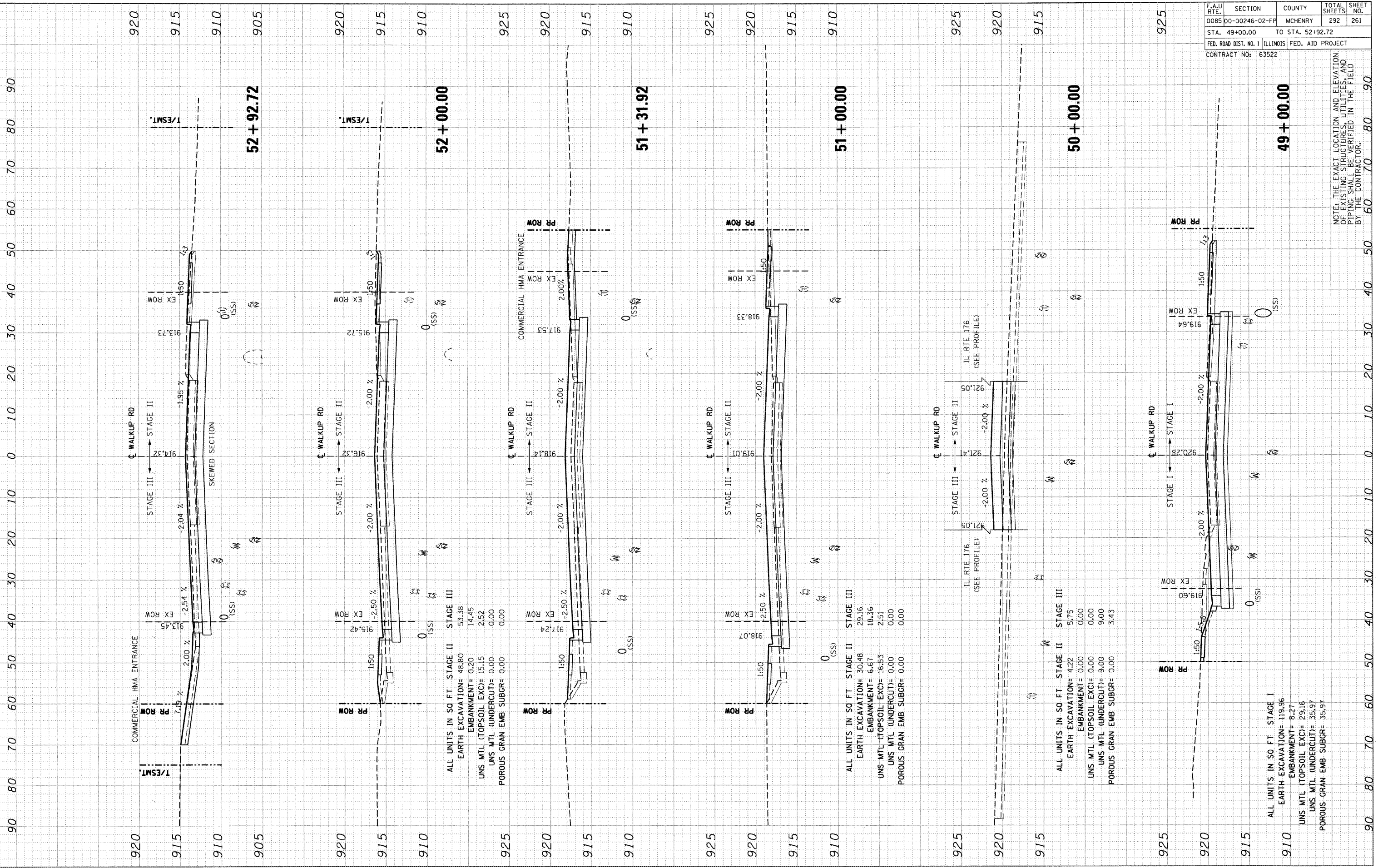

ALL UNITS IN SQ. FT. STAGE II

EARTH EXCAVATION=	48.80
EMBANKMENT=	0.20
UNSMTL (TOPSOIL EXC)=	14.45
UNSMTL (UNDERCUT)=	2.52
UNSMTL (UNDERCUT)=	0.00
POROUS GRAN EMB SUBGR=	0.00

ALL UNITS IN SQ. FT. STAGE II

EARTH EXCAVATION=	30.48
EMBANKMENT=	29.16
UNSMTL (TOPSOIL EXC)=	6.67
UNSMTL (UNDERCUT)=	2.51
UNSMTL (UNDERCUT)=	0.00
POROUS GRAN EMB SUBGR=	0.00

ALL UNITS IN SQ. FT. STAGE II

EARTH EXCAVATION=	4.22
EMBANKMENT=	0.00
UNSMTL (TOPSOIL EXC)=	0.00
UNSMTL (UNDERCUT)=	9.00
UNSMTL (UNDERCUT)=	0.00
POROUS GRAN EMB SUBGR=	3.43

ALL UNITS IN SQ. FT. STAGE I

EARTH EXCAVATION=	119.96
EMBANKMENT=	8.27
UNSMTL (TOPSOIL EXC)=	29.16
UNSMTL (UNDERCUT)=	35.97
POROUS GRAN EMB SUBGR=	35.97

F.A.U. RTE.	SECTION	COUNTY	TOTAL SHEETS	SHEET NO.
0085	DO-00246-02-FF	MCHENRY	292	261
STA. 49+00.00	TO STA. 52+92.72			
FED. ROAD DIST. NO. 1 ILLINOIS FED. AID PROJECT				
CONTRACT NO.: 63522				

NOTE: THE EXACT LOCATION AND ELEVATION OF EXISTING STRUCTURES, UTILITIES, AND PIPING SHALL BE VERIFIED IN THE FIELD BY THE CONTRACTOR.

PROPOSED CROSS-SECTIONS: WALKUP ROAD